

FAST & FURIOUS *pack*TM

1

Build the Legendary
DODGE CHARGER R/T



D'AGOSTINI
MODELSPACETM
www.model-space.com



FAST & FURIOUS

Build the Legendary
DODGE CHARGER R/T

Editorial by: Milanoedit srl, milanoedit.com

Picture credits: NBCUniversal Archive

© 2019 Universal City Studios LLC.

Fast & Furious and all related marks and characters are trademarks and copyrights of Universal Studios.
All Rights Reserved.

Dodge, HEMI and related logos, vehicle model names and trade dress are trademarks of FCA US LLC and used under license by Premium and Collectibles Trading Co. Ltd. ©2019 FCA US LLC.

© 2019 Editorial Planeta DeAgostini S.A.U.

Todos los derechos reservados.

© 2019 De Agostini Publishing Italia S.p.A.

Tutti i diritti riservati.

Warning: Not suitable for children under the age of 14.

This product is not a toy and is not designed or intended for use in play.

Items may vary from those shown.



Pack 1

Stage 1

Bonnet and supercharger

Stage 2

Steering wheel and first wheel

Stage 3

Nose with grille and front headlamps

Stage 4

Front left brake and suspension



BONNET AND SUPERCHARGER

STAGE

7

In this stage you will assemble the bonnet with the impressive supercharger in the middle, one of the most distinctive and characteristic elements of the 1970 Dodge Charger R/T.

PIECES FOR THIS STAGE

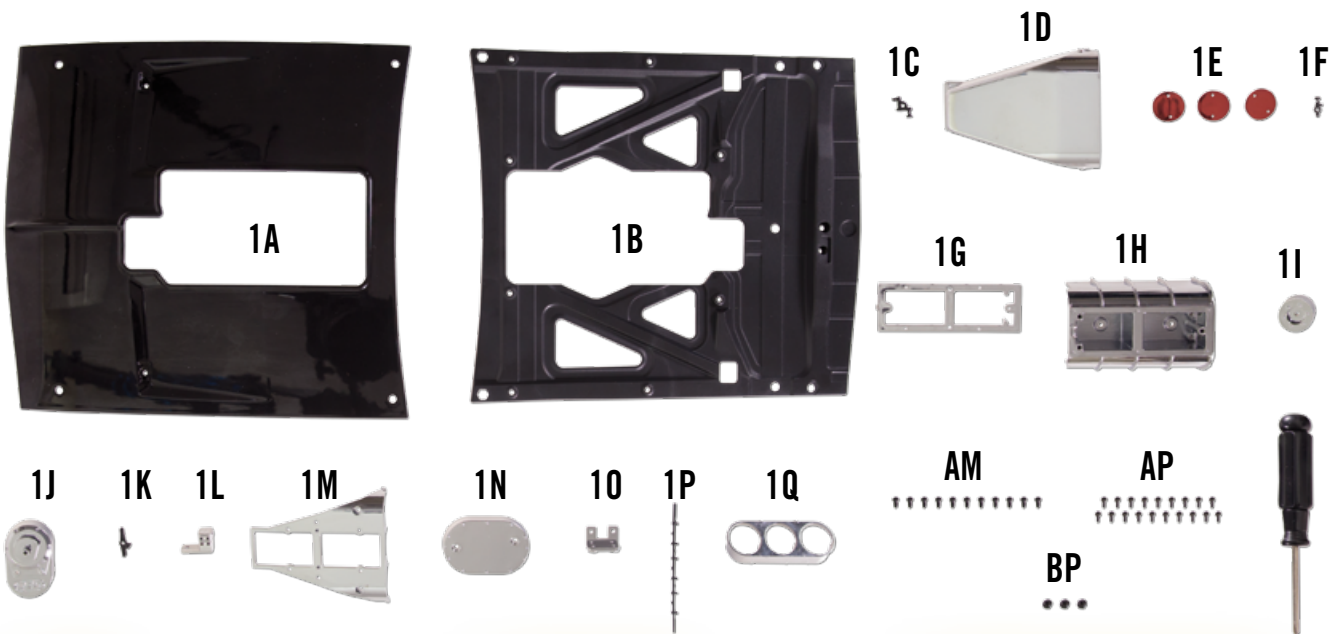

- | | | |
|---|---|--|
| 1A Bonnet | 1I Supercharger pulley | 1Q Butterfly valve plate shaft baseplate |
| 1B Inner reinforcement panel | 1J Pulley spacer | AM Screw 2x4 mm (x 11) * |
| 1C Butterfly valve shaft right mount | 1K Butterfly valve body lever | AP Screw 1.7x4 mm (x 19) * |
| 1D Air intake (upper half) | 1L Fuel distributor | BP Screw 1.7x3.5 mm (x 3) * |
| 1E Butterfly valve throttle plate (x 3) | 1M Air intake (lower half) | Screwdriver |
| 1F Butterfly valve shaft left mount | 1N Front cover supercharger unit | |
| 1G Injector plate | 1O Bracket for front cover of supercharger unit | |
| 1H Supercharger unit | 1P Butterfly valve plate shaft | |

* Some of the parts are spares.



BONNET AND SUPERCHARGER

These items are not toys; keep out of reach of children. The product is part of an assembly kit intended for an adult audience. Assemble with the utmost care following the instructions in the attached manual; modifications or tampering are prohibited. Made in China. Read and keep for further reference.

Publisher Note: the appearance of the parts shown on these pages may differ from that of the pieces included in this pack. This in no way affects the quality or assembly instructions.

These items are not toys; keep out of reach of children. The product is part of an assembly kit intended for an adult audience. Assemble with the utmost care following the instructions in the attached manual; modifications or tampering are prohibited. Made in China. Read and keep for further reference.

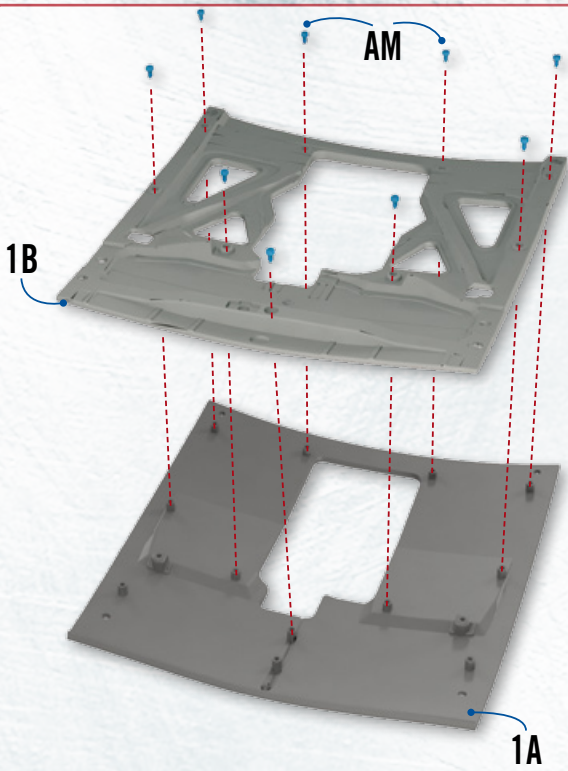

USEFUL TIP

When handling the body parts, it is a good idea to take a few small precautions to protect the paintwork from scratches. We recommend you prepare a clean work area and that you work on a cloth or sheet of cardboard, so as to protect the pieces against damage.

1.1 **START** by placing the bonnet 1A on your work surface, with the inner side facing upwards. Put bonnet 1A and reinforcement panel 1B together. Join the two pieces with nine type AM screws. ◀

1.2 **PUT** the Butterfly valve plate shaft baseplate 1Q and the air intake 1D together. Join the pieces with two type BP screws. ▼

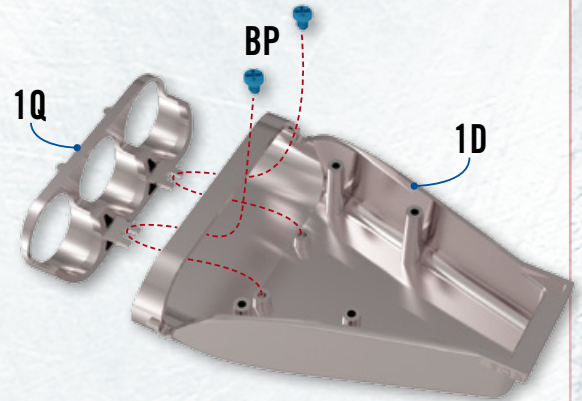

1.3 **MOUNT** the throttle plates 1E onto the linchpins on the plate shaft 1P. The arrows on the plates must all point in the same direction. ▼

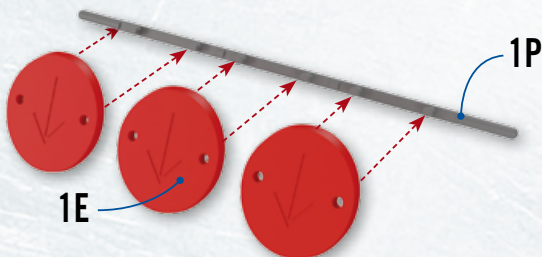

1.5 **PUT** the lower half of the air intake 1M and the injector plate 1G together, ensuring that the pieces are facing the same way as shown in the illustration. Join the two pieces with four type AP screws. ▼

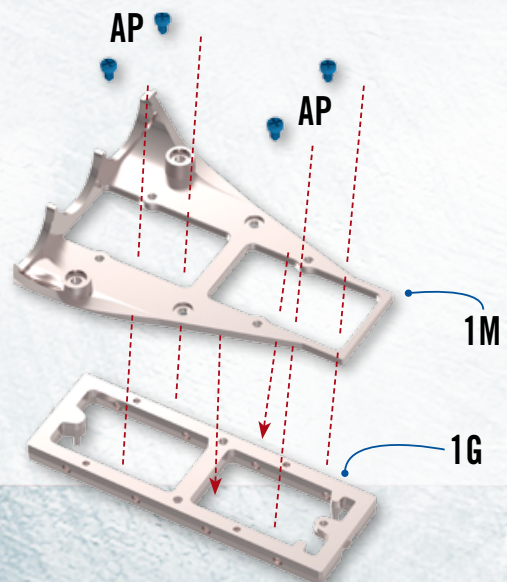

1.4 **EASE** the plate shaft onto the air intake, using the side grooves on the latter. The arrows must point towards the front of the air intake. ▼

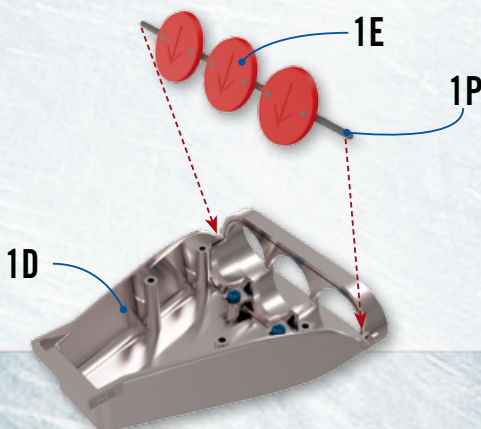



1.6 **TURN** what you built in the last step upside down and place it over the upper half of the air intake. Join all the pieces together with four type AP screws. ▼

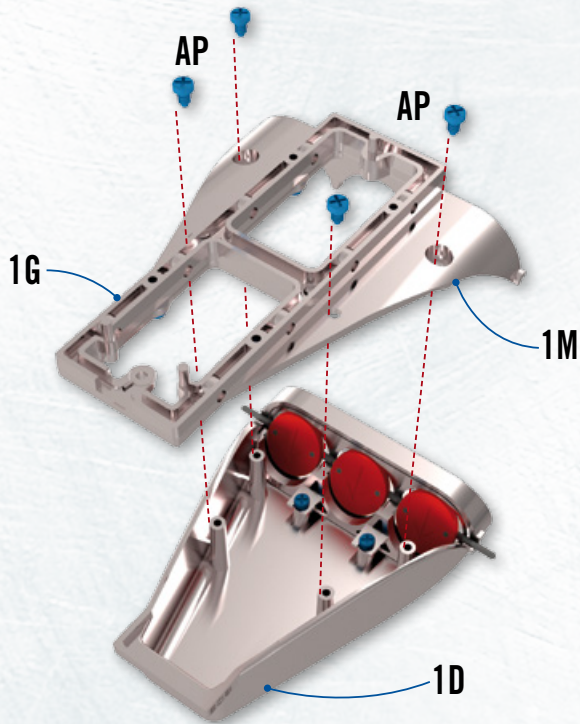

1.7 **ATTACH** the right mount 1C to the end of the butterfly valve plate shaft on the right hand side of the air intake. ▼

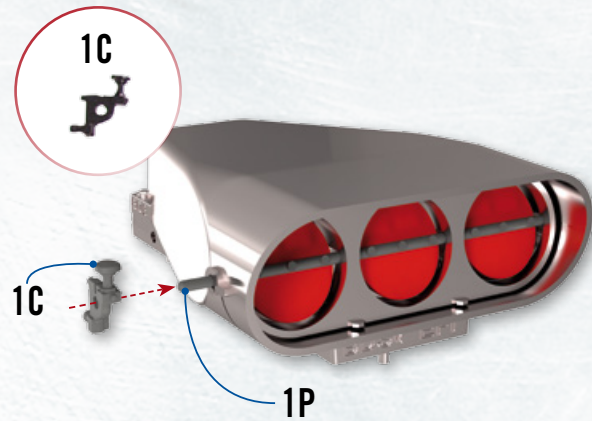

1.8 **WHILE** holding the right mount 1C with your finger, attach the left mount 1F to the lever 1K on the other end of the throttle body shaft. ▼

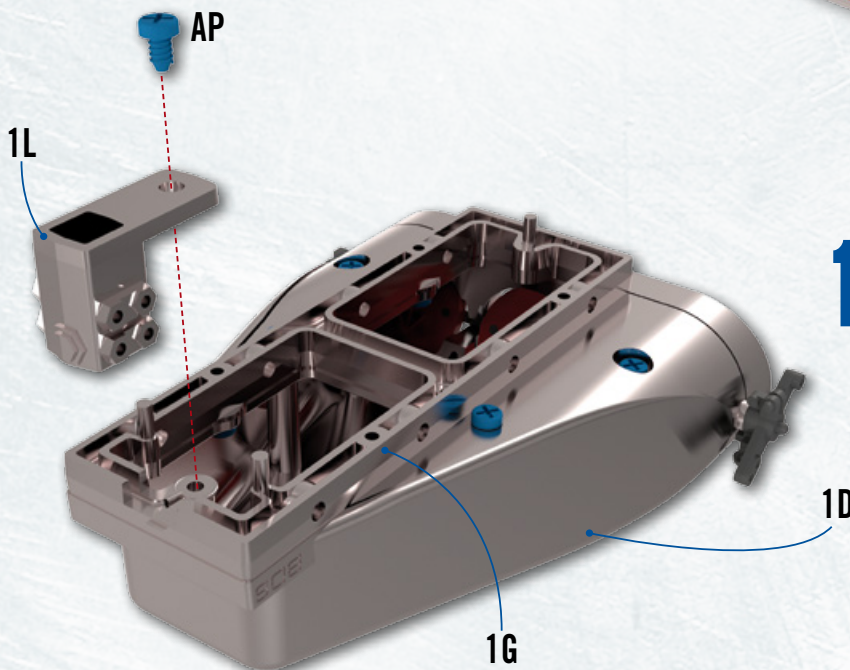
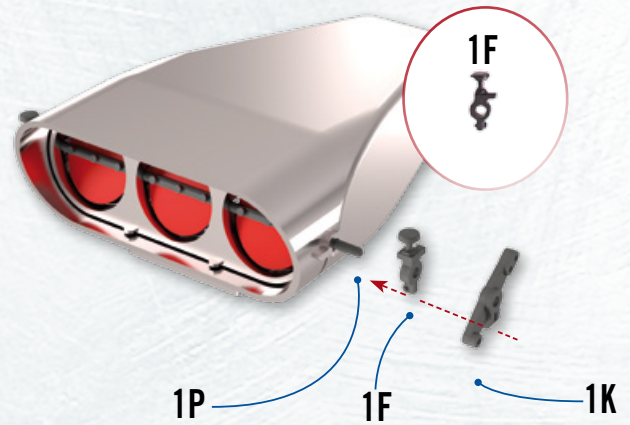

1.9 **ATTACH** the fuel distributor 1L to the back of the injector plate 1G with a type AP screw. ◀



1.10 USING two type AP screws, join the pulley spacer 1J and the cover of the supercharger unit 1N. ▼

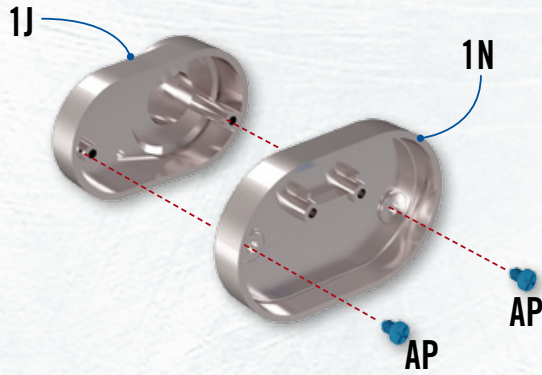

1.11 PUT the bracket 10 and the front cover 1N of the supercharger together, ensuring that the pieces are facing the same way as shown in the illustration. Join the pieces together with two type AP screws. ▼

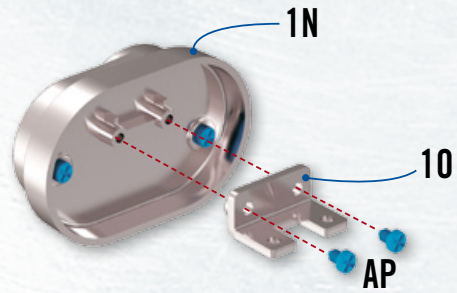

1.12 INSERT the two flat prongs of the bracket 10 into the front opening of the supercharger 1H. Fix in place with two type AP screws. ▶

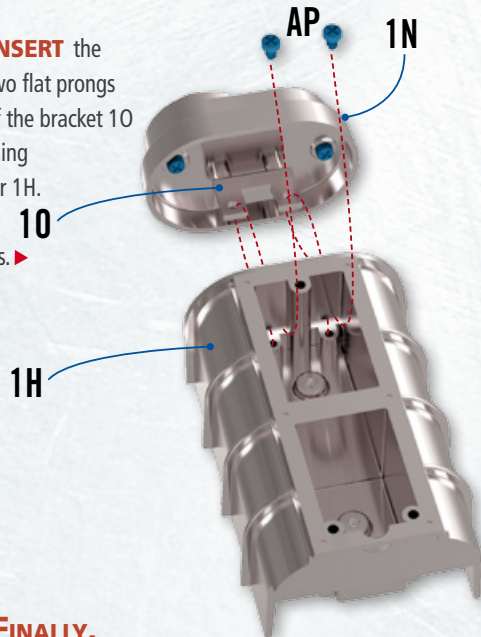

1.13 SLIDE the supercharger pulley 1I onto the linchpin of the spacer 1J, ensuring the pieces are facing the same way as those in the illustration. Fix in place with a type AP screw. ▼

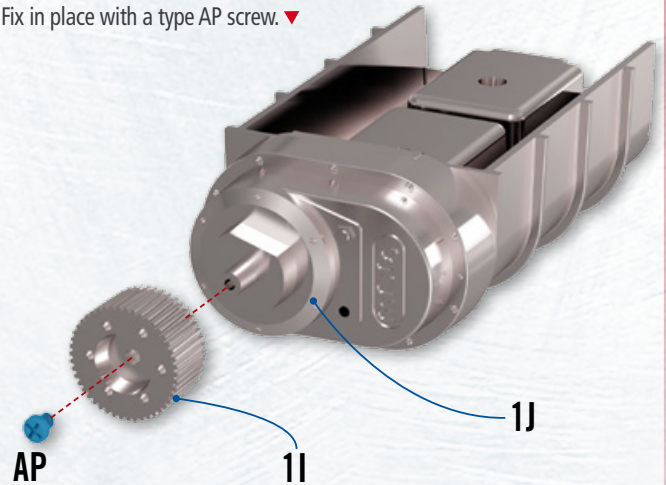

1.14 FINALLY, press the injector plate 1G down onto the supercharger unit 1H. ▼

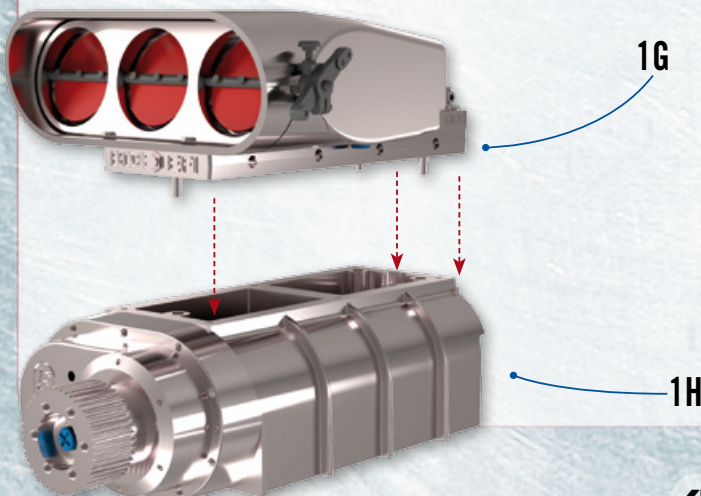

STAGE 1 FINAL RESULT

You can now admire the result of your first assembly session. You have joined the bonnet and the reinforcement panel together, and built the supercharger with the air intake of your Dodge Charger R/T in 1:8 scale. That's a great start!



STEERING WHEEL AND FIRST WHEEL

STAGE

2

Here we will show you how to assemble the steering wheel and the front left wheel of your Charger R/T.

PIECES FOR THIS STAGE

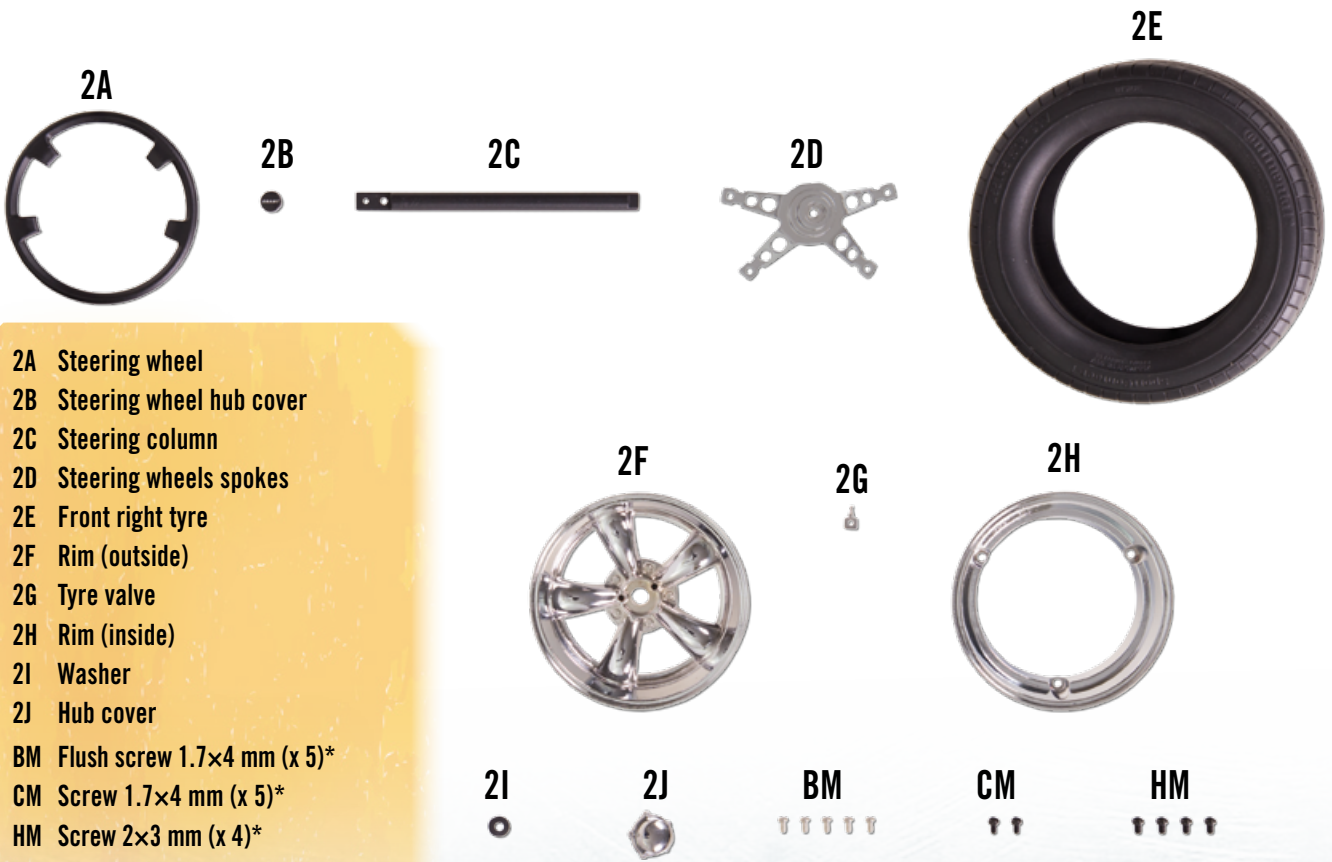

- 2A Steering wheel
- 2B Steering wheel hub cover
- 2C Steering column
- 2D Steering wheels spokes
- 2E Front right tyre
- 2F Rim (outside)
- 2G Tyre valve
- 2H Rim (inside)
- 2I Washer
- 2J Hub cover
- BM Flush screw 1.7×4 mm (x 5)*
- CM Screw 1.7×4 mm (x 5)*
- HM Screw 2×3 mm (x 4)*

* Some of the parts are spares.



STEERING WHEEL AND FRONT LEFT WHEEL

Publisher Note: the appearance of the parts shown on these pages may differ from that of the pieces included in this pack. This in no way affects the quality or assembly instructions.

These items are not toys; keep out of reach of children. The product is part of an assembly kit intended for an adult audience. Assemble with the utmost care following the instructions in the attached manual; modifications or tampering are prohibited. Made in China. Read and keep for further reference.



2.1

ATTACH the steering wheel spokes 2D to the outer part of the steering wheel 2A by aligning the four mounting holes and inserting four BM type screws. ▼

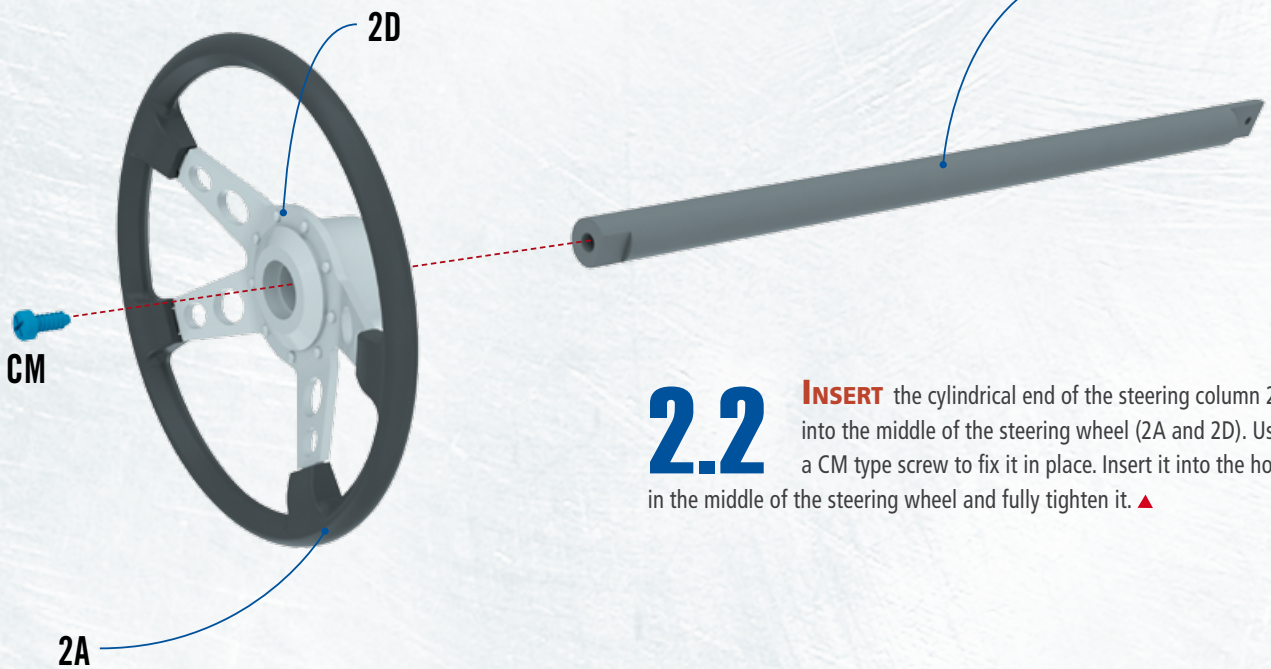
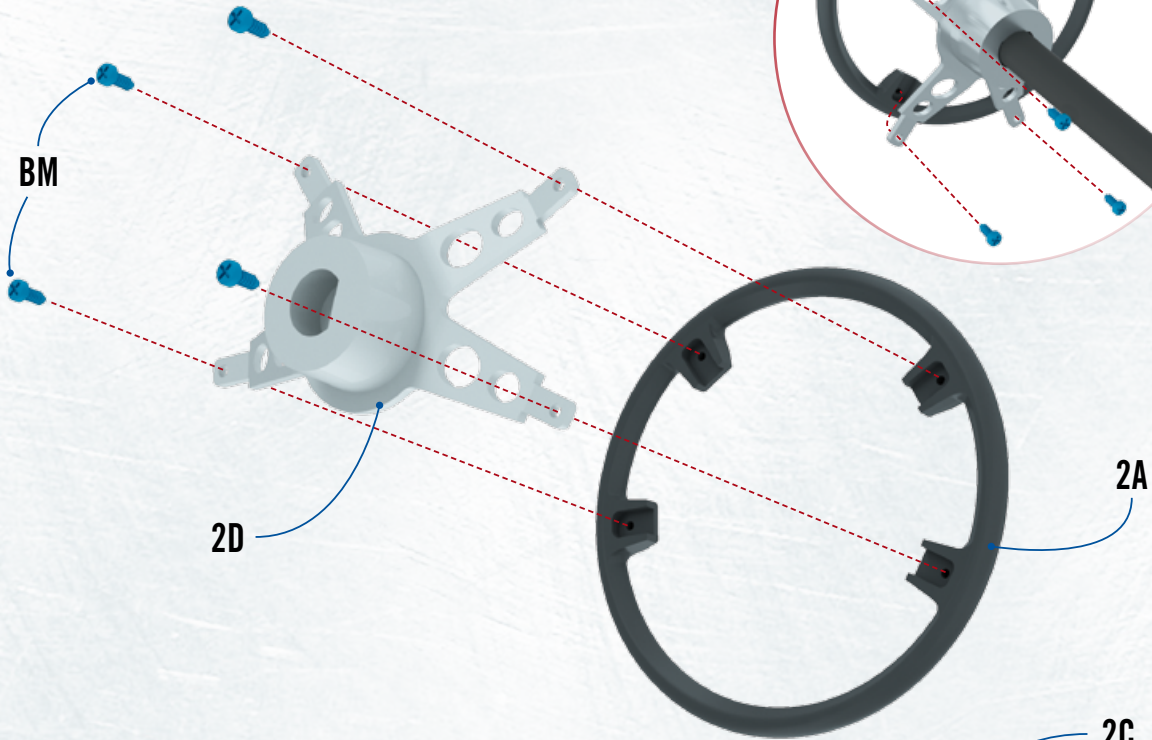

2.2

INSERT the cylindrical end of the steering column 2C into the middle of the steering wheel (2A and 2D). Use a CM type screw to fix it in place. Insert it into the hole in the middle of the steering wheel and fully tighten it. ▲



2.3

ATTACH the steering wheel hub cover 2B onto the centre of the spokes by pressing it, ensuring that it is facing the same way as shown in the illustration. ◀

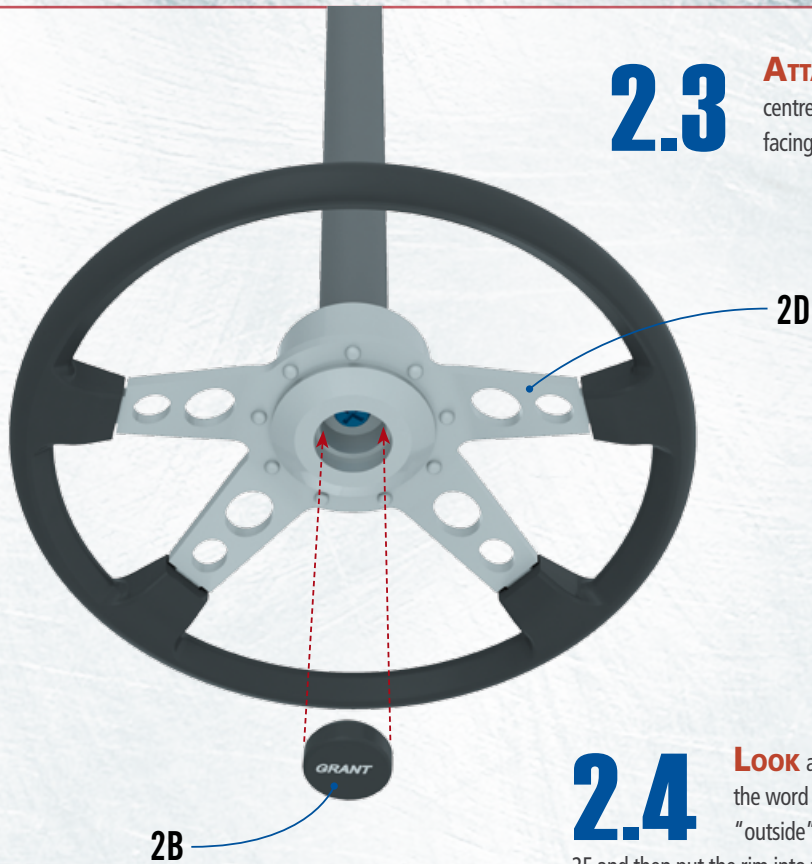

2.4

LOOK at the front left tyre 2E: on one side you will see the word "inside" written, and on the other, the word "outside". Insert the tyre valve 2G into the outside rim 2F and then put the rim into the outside of the tyre. Then put the inside rim 2H into the inside of the tyre. Match the holes and mounting linchpins. ▼





2.5 **INSERT** three HM type screws into the holes in the inside of the rim. Tighten the screws to join the two parts of the rim (2H and 2F). ▶

2.6 **PLACE** the washer 2I in the middle of the outside of the rim. Then put the hub cover 2J over the washer. This part simply attaches by pushing it down: do not mount it definitively for the moment. ▼

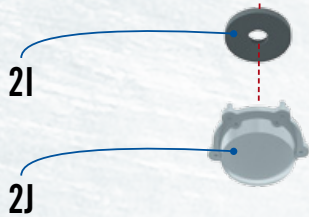
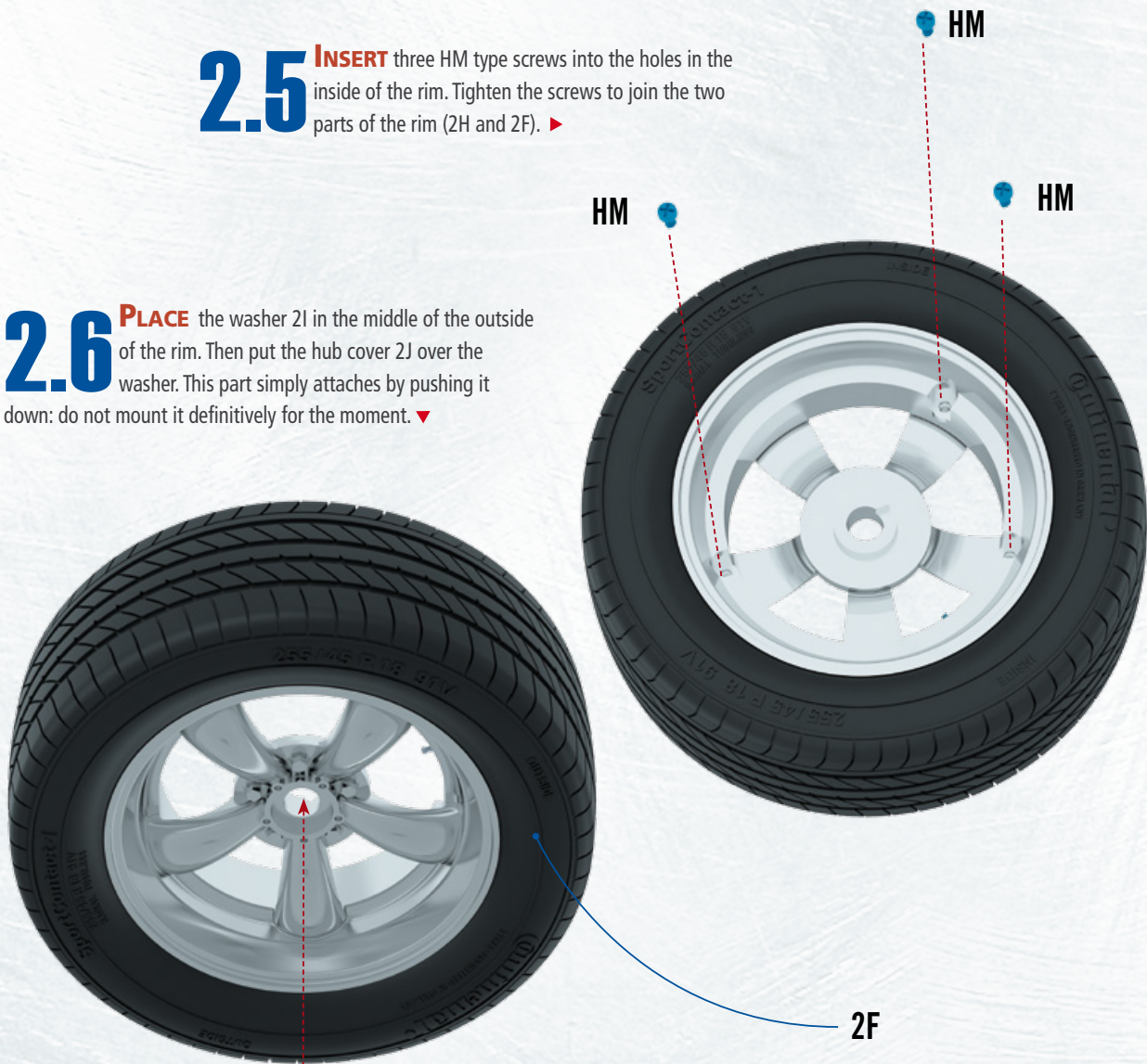

STAGE 2 FINAL RESULT

The result of your second assembly session is the steering wheel and front left wheel of your Dodge Charger R/T in a 1:8 scale. Put what you have built so far in a safe place until you are ready to mount the parts onto the model.



NOSE WITH GRILLE AND FRONT HEADLAMPS

STAGE

3

Thanks to the new parts attached, you can start assembling the nose of your Dodge Charger R/T.

PIECES FOR THIS STAGE

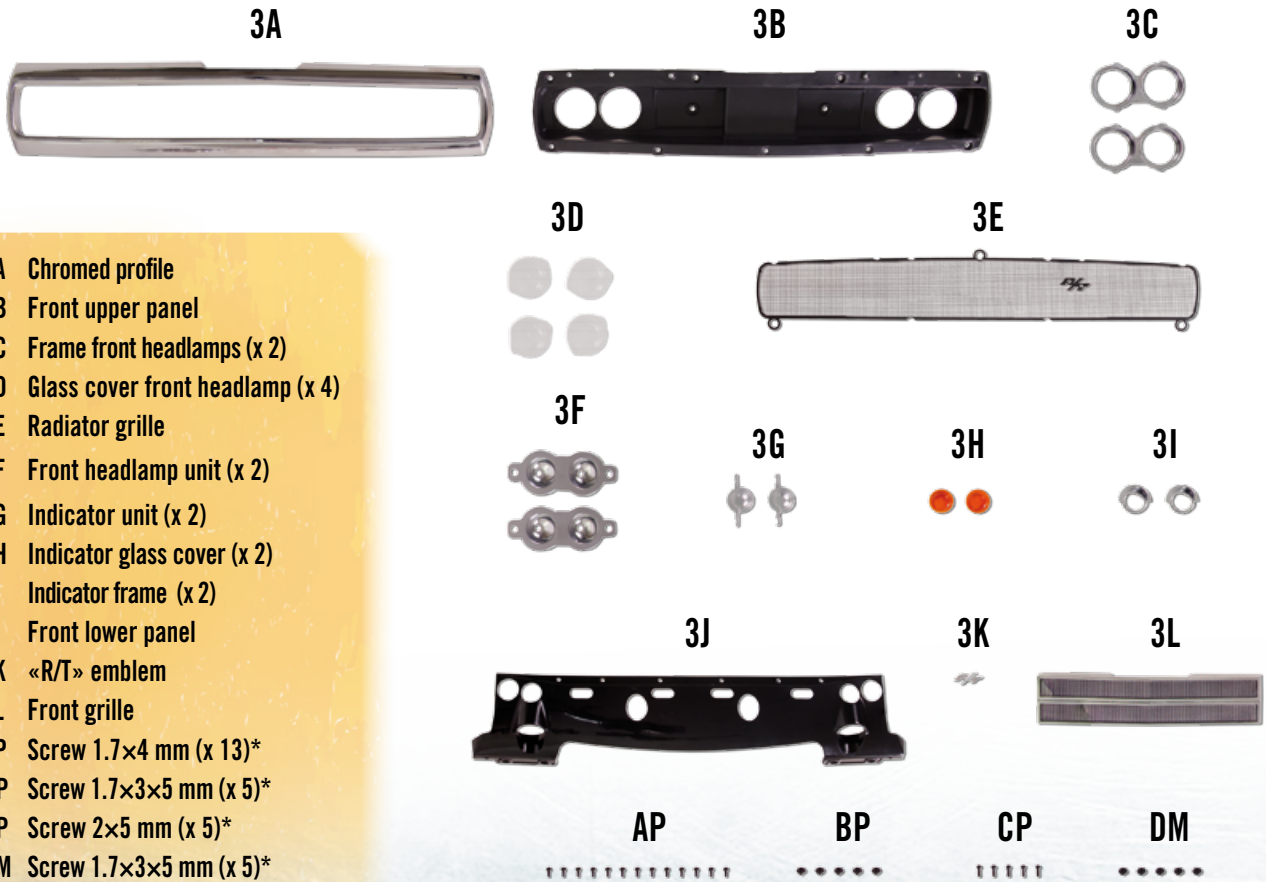

- 3A Chromed profile
- 3B Front upper panel
- 3C Frame front headlamps (x 2)
- 3D Glass cover front headlamp (x 4)
- 3E Radiator grille
- 3F Front headlamp unit (x 2)
- 3G Indicator unit (x 2)
- 3H Indicator glass cover (x 2)
- 3I Indicator frame (x 2)
- 3J Front lower panel
- 3K «R/T» emblem
- 3L Front grille
- AP Screw 1.7×4 mm (x 13)*
- BP Screw 1.7×3×5 mm (x 5)*
- CP Screw 2×5 mm (x 5)*
- DM Screw 1.7×3×5 mm (x 5)*

Publisher Note: the appearance of the parts shown on these pages may differ from that of the pieces included in this pack.
 This in no way affects the quality or assembly instructions.



NOSE AND FRONT HEADLAMPS

These items are not toys; keep out of reach of children. The product is part of an assembly kit intended for an adult audience. Assemble with the utmost care following the instructions in the attached manual; modifications or tampering are prohibited. Made in China. Read and keep for further reference.

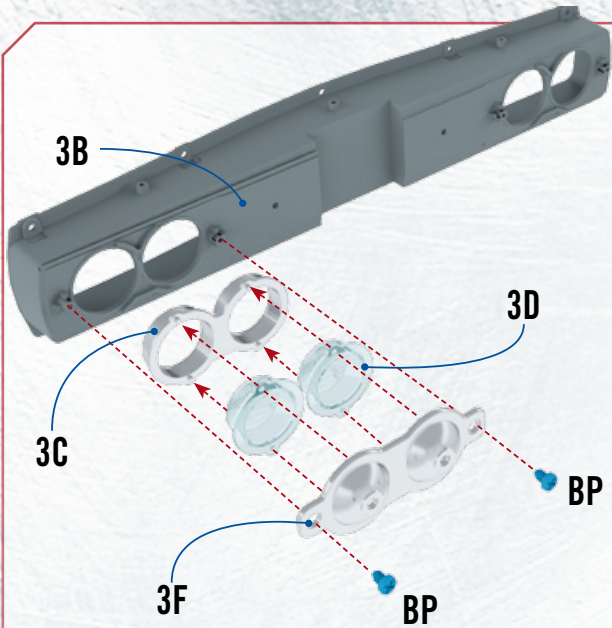

3.1 POSITION the front upper panel 3B so that you can work on its inner side. Mount the pieces of the front left headlamps in the following order: frame 3C, two glass covers 3D (the linchpins on the frame must match up with the corresponding holes in the glass covers) and the unit 3F. Attach the completed headlamps to the panel with two type BP screws. ◀

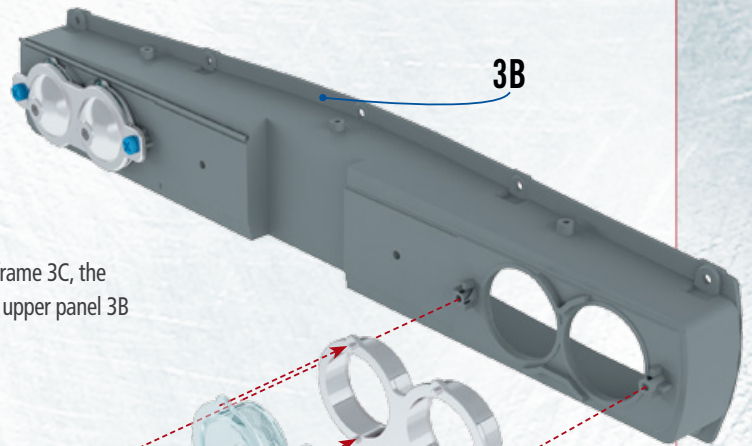
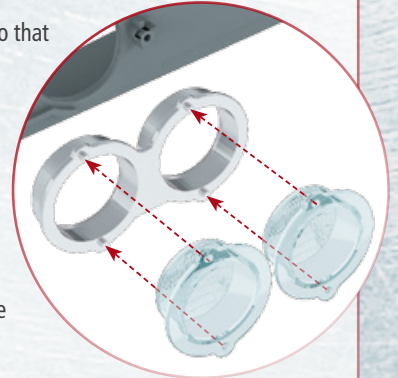

3.2 MOUNT the front right headlamps in the same way: put the frame 3C, the two glass covers 3D and the unit 3F together; attach to the front upper panel 3B with two type BP screws. ▶

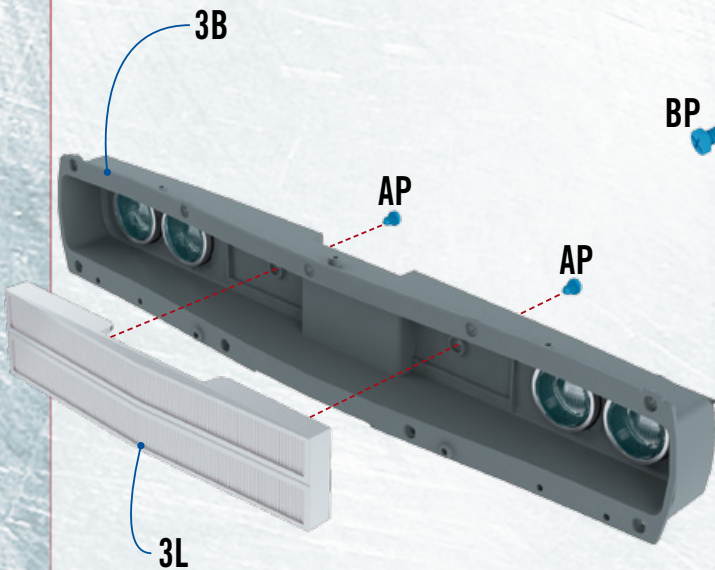

3.3 INSERT the grille 3L into the middle of the outside of the front upper panel 3B. From the other side, insert and tighten two type AP screws. ◀

3.4 TAKE the «R/T» emblem and gently push it into the holes in the outside of the radiator grille 3E. ▼

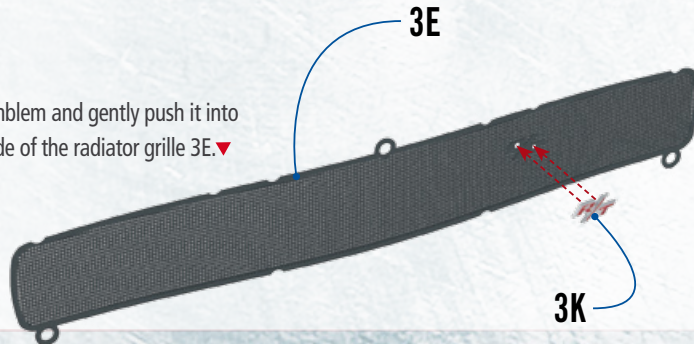

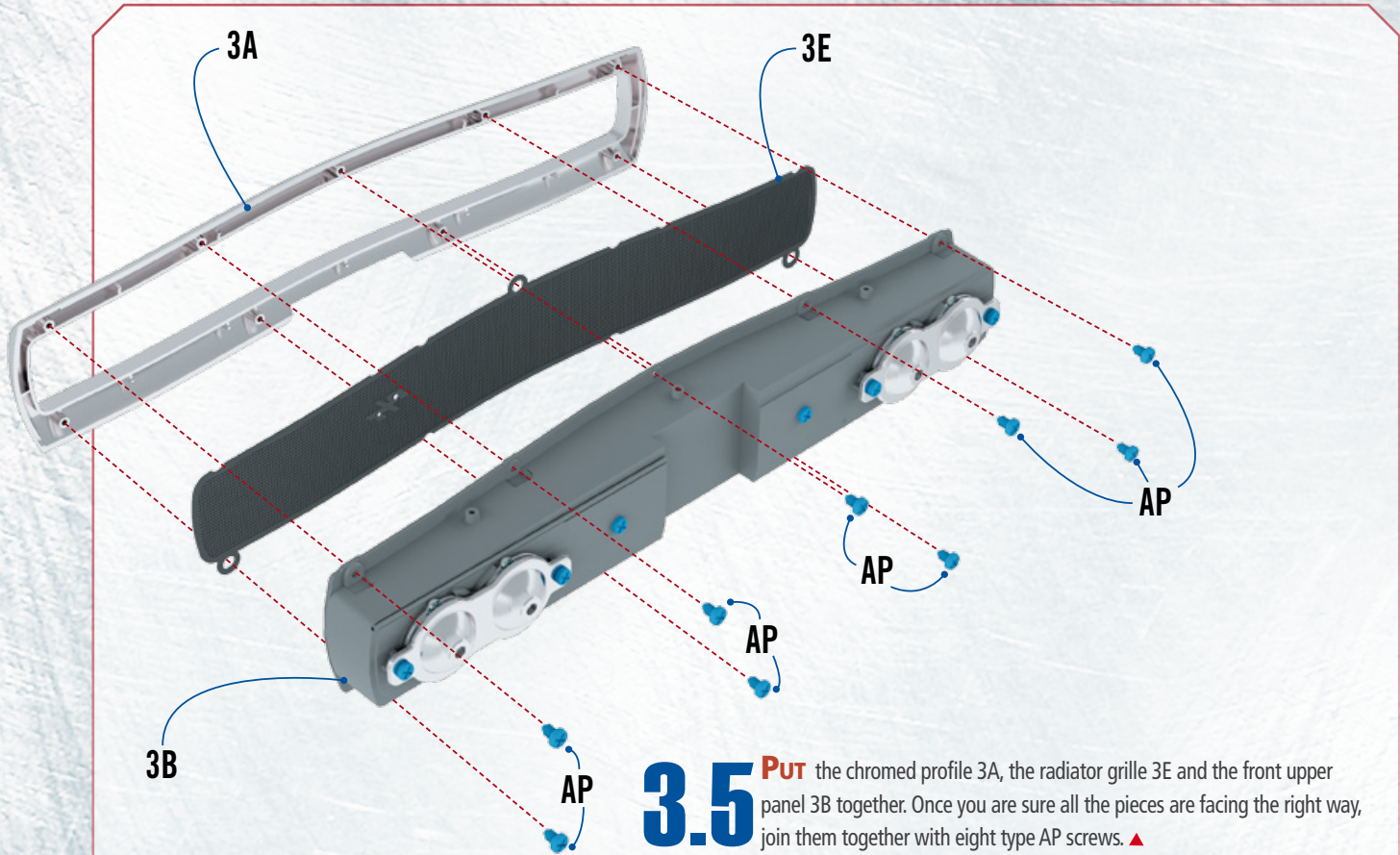

3.5 **PUT** the chromed profile 3A, the radiator grille 3E and the front upper panel 3B together. Once you are sure all the pieces are facing the right way, join them together with eight type AP screws. ▲

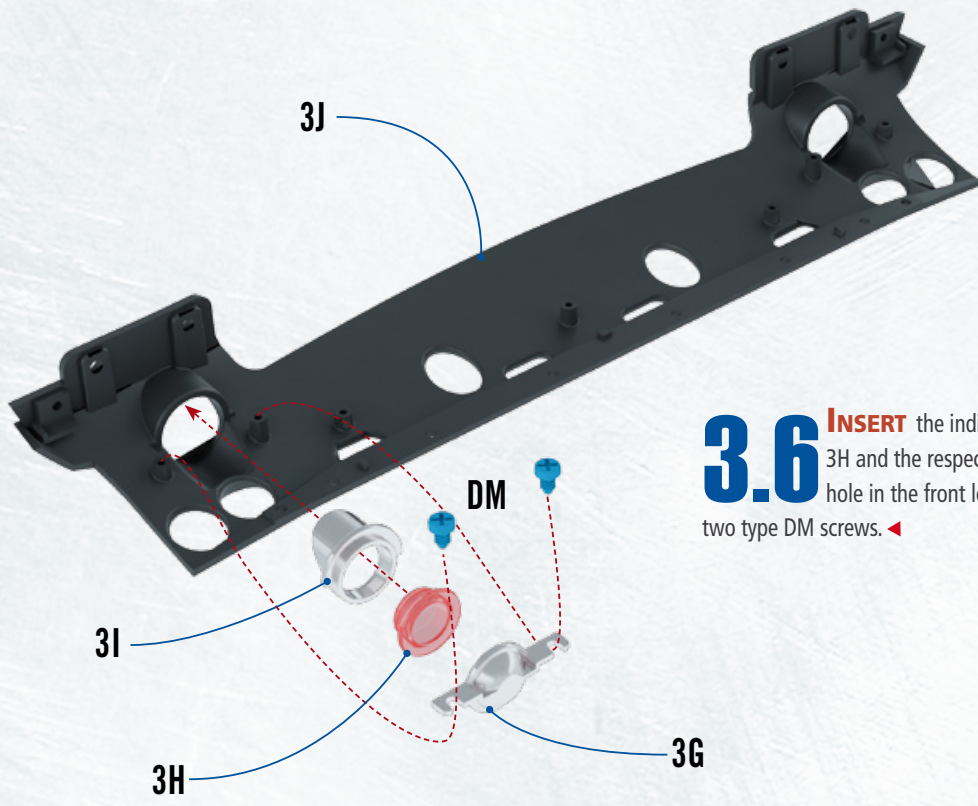

3.6 **INSERT** the indicator frame 3I, the glass cover 3H and the respective indicator unit into the left hole in the front lower panel 3J. Fix in place with two type DM screws. ◀



3.7 **MOUNT** the second indicator on the front lower panel 3J in the same way as you did on the left: insert the frame 3I, the glass cover 3H and the indicator unit 3G into the panel; fix in place with two type DM screws. ▶

3.8 **PUT** the front lower panel 3J and the upper panel 3B together, ensuring that the assembly holes match up. Join with four type CP screws. ▼

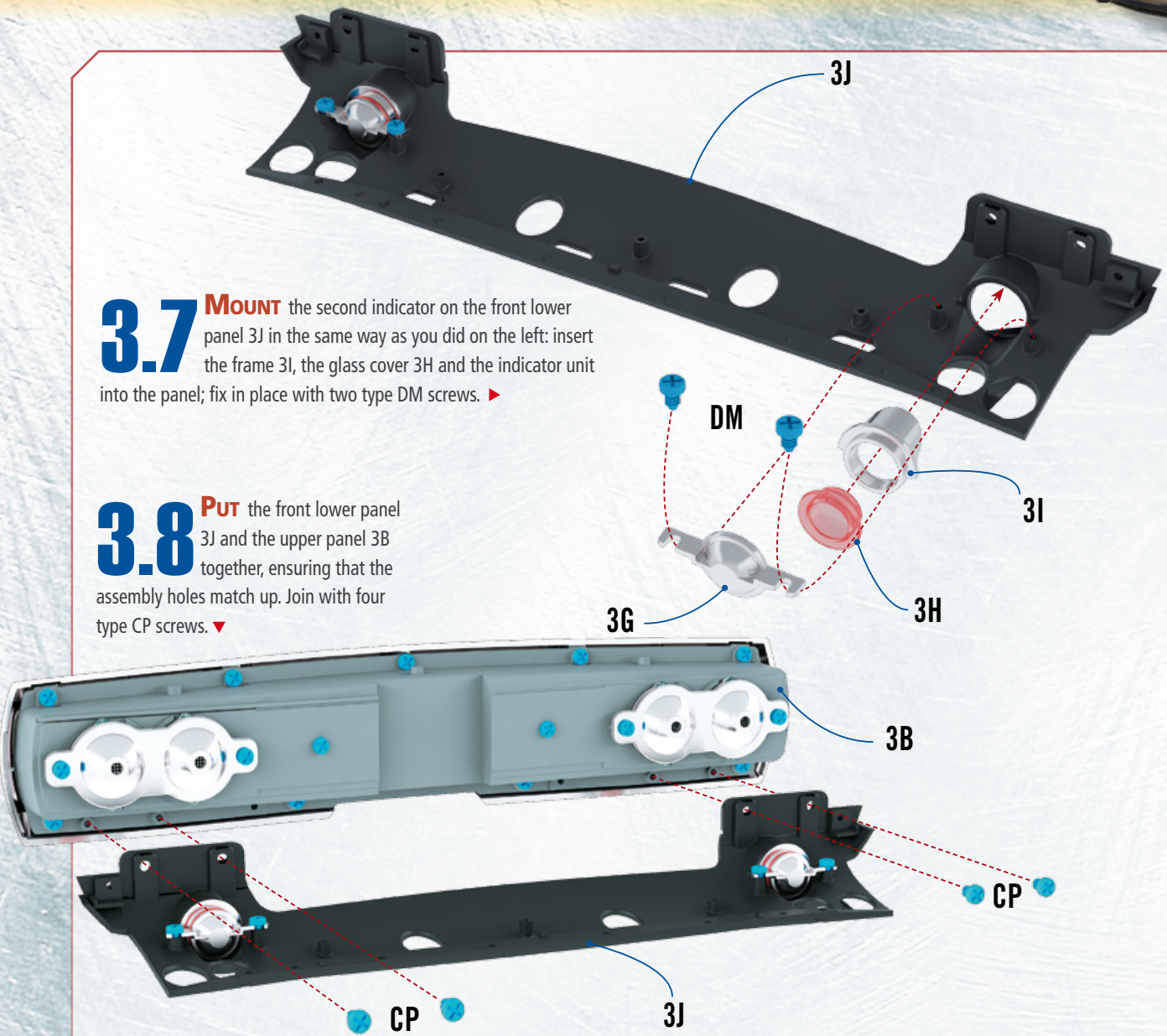

STAGE 3 FINAL RESULT

📌 The nose of your Dodge Charger RT is now finished. Put it in a safe place.



FRONT LEFT BRAKE AND SUSPENSION

STAGE

4

You can now make the brake disc and attach the wheel to the elements of the suspension.

PIECES FOR THIS STAGE

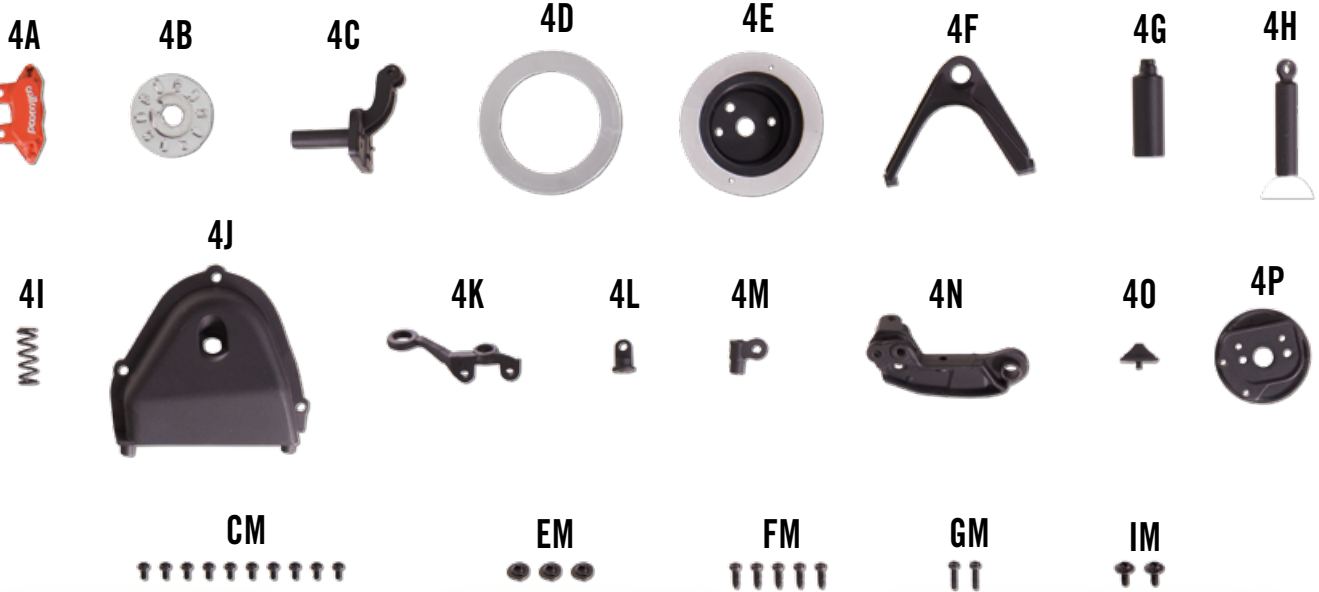

4A Front left brake caliper

4B Front left wheel hub

4C Front left spindle (piece 1)

4D Brake disc (piece 1)

4E Brake disc (piece 2)

4F Upper front left suspension arm

4G Shock absorber unit

4H Shock absorber piston

4I Spring

4J Front left suspension dome

4K Front left spindle (piece 2)

4L Suspension ball joint (piece 1)

4M Suspension ball joint (piece 2)

4N Front left suspension arm

4O Shock absorber disc

4P Front left brake caliper baseplate

CM Screw 1.7×3 mm (x 10)*

EM Screw 2×3×6 mm (x 3)*

FM Screw 2×5 mm (x 5)*

GM Screw 1.7×6×2 mm (x 2)*

IM Screw 2×5×5 mm (x 2)*



FRONT LEFT BRAKE AND SUSPENSION

Publisher Note: the appearance of the parts shown on these pages may differ from that of the pieces included in this pack. This in no way affects the quality or assembly instructions.

These items are not toys; keep out of reach of children. The product is part of an assembly kit intended for an adult audience. Assemble with the utmost care following the instructions in the attached manual; modifications or tampering are prohibited. Made in China. Read and keep for further reference.

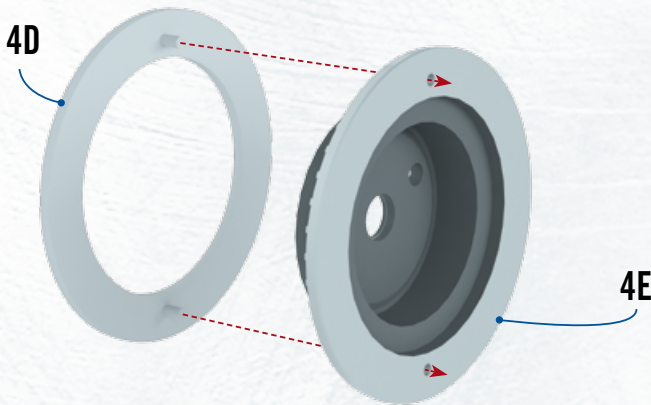

4.1 Put the parts of the brake disc (4D and 4E) together by inserting the linchpins on piece 1 into the corresponding holes in piece 2, as shown in the illustration. ◀

4.2 Put the wheel hub 4B and the convex side of the brake disc 4E together, by inserting the centering linchpin into the small hole in the brake disc 4E. Insert two CM type screws, from the convex side of the brake disc, to join the two parts together. ▶

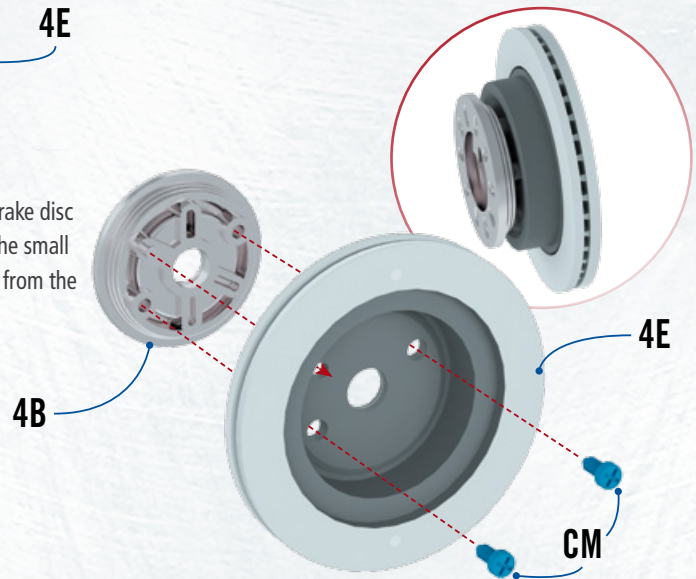

4.3 INSERT the axle spindle 4C into the hole in the middle of the brake caliper baseplate 4P. Join with two type CM screws. ▼

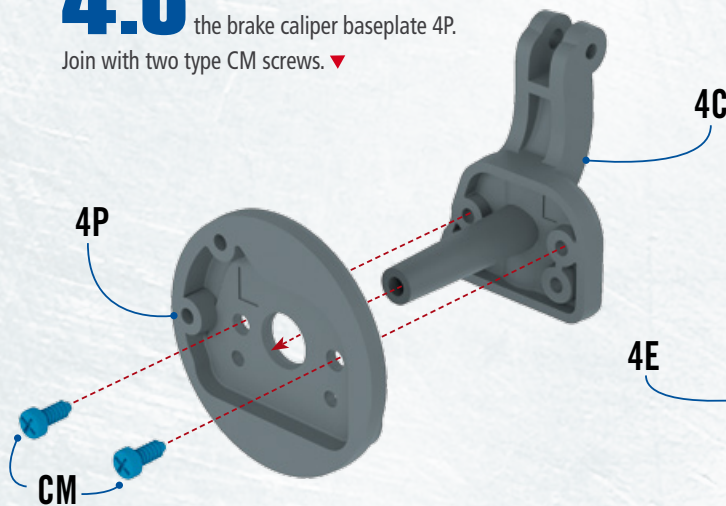

4.4 THE AXLE spindle 4C must now be inserted into the hole in the brake disc 4E. Slide the brake caliper 4A onto the disc (4D and 4E) and the spindle 4C. Fix the caliper in place with two type CM screws. ▶

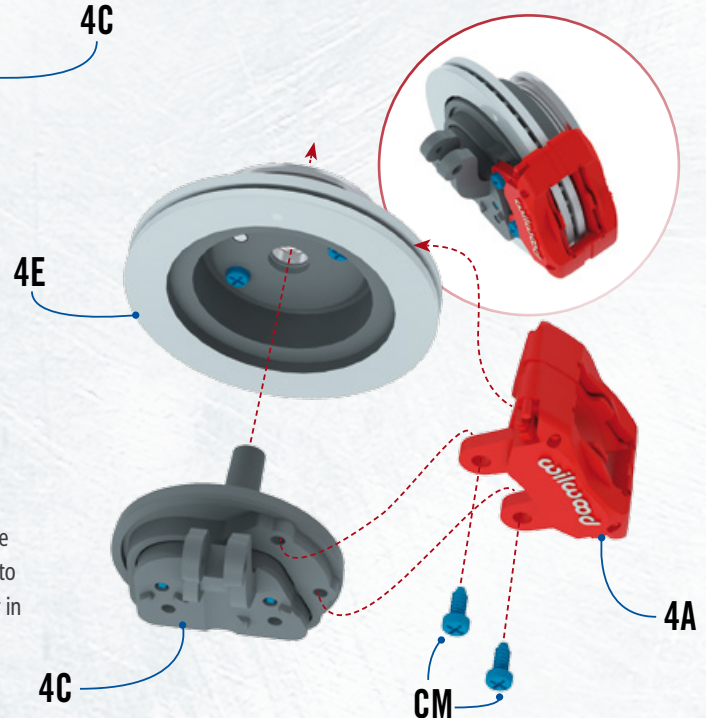



4.5 **ATTACH** the upper part of the shock absorber 4G to the inside of the suspension dome 4J using an EM type screw. ▼

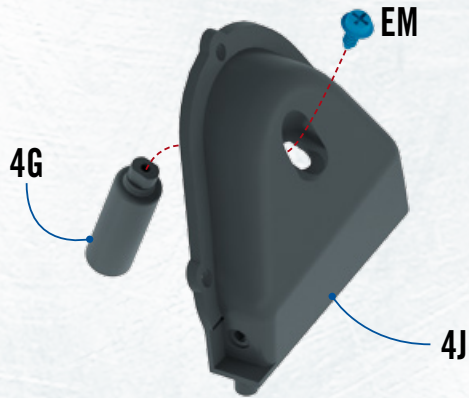

4.6 **ALIGN** the upper suspension arm 4F with the corresponding holes in the side of the dome 4J, ensuring that the pieces are facing the same way as shown in the illustration. Fix the arm in place with two type FM screws. ▼

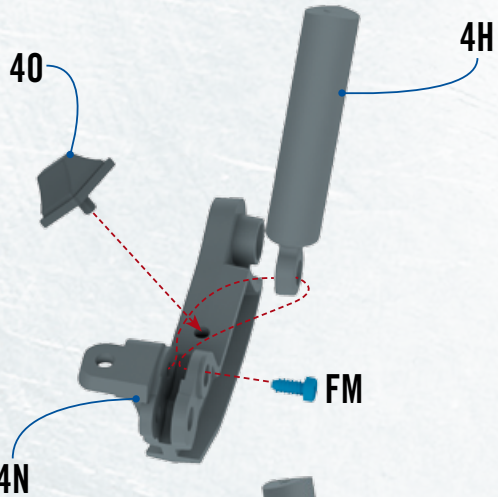
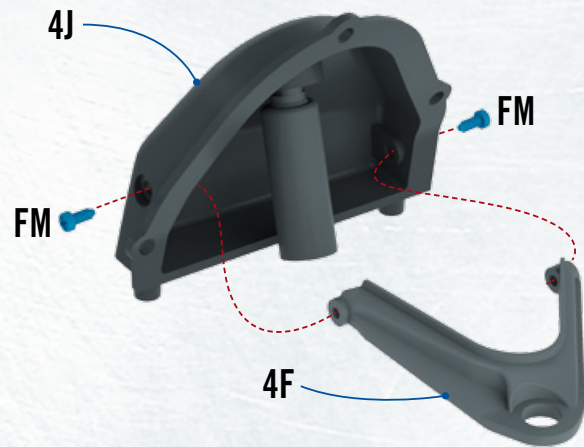

4.7 **INSERT** the fixing linchpin on the disc 40 into the hole on the upper part of the lower arm 4N. Insert the eye of the shock absorber piston 4H into the slot on the lower arm 4N. Align the eye with the hole closest to the disc 40 and fix it in place with a type FM screw. ◀

4.8 **IN THE SAME** slot on the lower arm 4N, arrange piece 2 of the ball joint 4M, with the cylindrical end facing downwards. Fix the part in place with a type FM screw. ▶



4.9 **SLIDE** piece 2 of the spindle 4K onto the end of the ball joint 4M that you have just fixed in place. Use a type EM screw to assemble these pieces. ◀





4.10 **PUT** the completed suspension and brake together. Use two type CM screws to join piece 2 4K and piece 1 of the spindle 4C. ▶

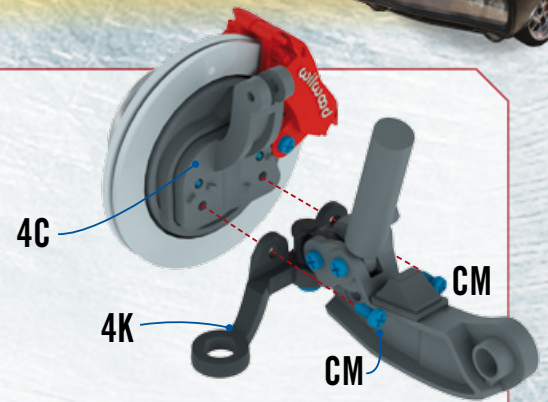

4.11 **INSERT** piece 1 of the ball joint 4L into the corresponding hole in the upper arm 4F. Now align it with the wishbone of piece 1 of the spindle 4C. Join everything together with one type GM screw. Slide the shock absorber piston 4H onto the upper part of the shock absorber unit 4G. ◀

4.12 **SLIDE** the front left wheel you made in the second assembly session onto the axle spindle 4C. Remove the hub cover 2J and the washer 2I. Then insert a type IM screw into the washer and attach the wheel to the axle spindle 4C. Finally, put the hub cover 2J back on. ▼

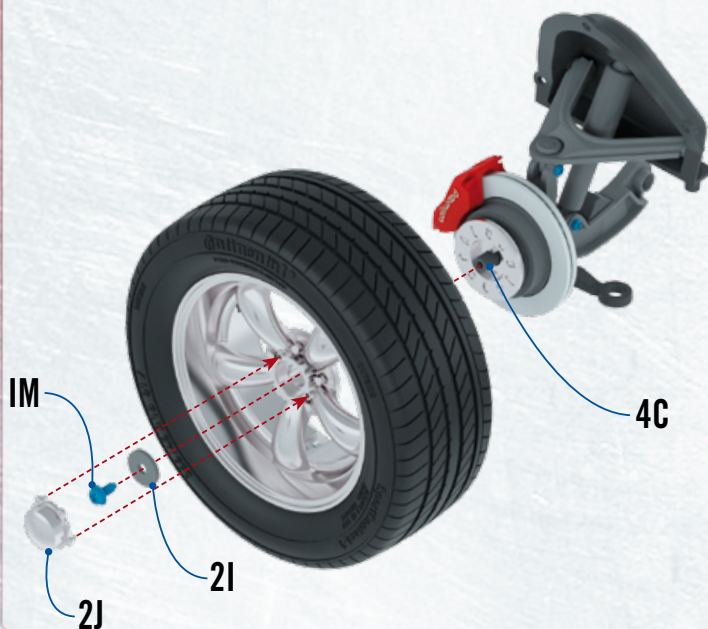

STAGE 4 FINAL RESULT

You have now attached the first wheel to the brake disc and suspension components. Keep what you have built so far in a safe place, together with the 4I spring that you will need in one of the next assembly sessions for your model car.

