

FAST & FURIOUS *pack™*

4

Build the Legendary
DODGE CHARGER R/T



D'AGOSTINI
MODELSPACE™
www.model-space.com



FAST & FURIOUS

Build the Legendary
DODGE CHARGER R/T

Editorial by: Milanoedit srl, milanoedit.com

Translation by: TperTradurre

Picture credits: NBCUniversal Archive

© 2019 Universal City Studios LLC.

Fast & Furious and all related marks and characters are trademarks and copyrights of Universal Studios.
All Rights Reserved.

Dodge, HEMI and related logos, vehicle model names and trade dress are trademarks of FCA US LLC and used under license by Premium and Collectibles Trading Co. Ltd. ©2019 FCA US LLC.

© 2019 Editorial Planeta DeAgostini S.A.U.

Todos los derechos reservados.

© 2019 De Agostini Publishing Italia S.p.A.

Tutti i diritti riservati.

Warning: Not suitable for children under the age of 14.

This product is not a toy and is not designed or intended for use in play.

Items may vary from those shown.



Pack 4

Stage 13

**Assembling
the engine block (I)**

Stage 14

**Assembling
the engine block (II)**

Stage 15

**Assembling
the engine block (III)**

Stage 16

**Assembling
the engine block (IV)**



DEAGOSTINI
MODELSPACE
www.model-space.com



ASSEMBLING THE ENGINE BLOCK (II)

STAGE

13

In this assembly session, you will start to build the engine block of your model car. Follow our instructions carefully, using the illustrations to help you.

PIECES FOR THIS STAGE

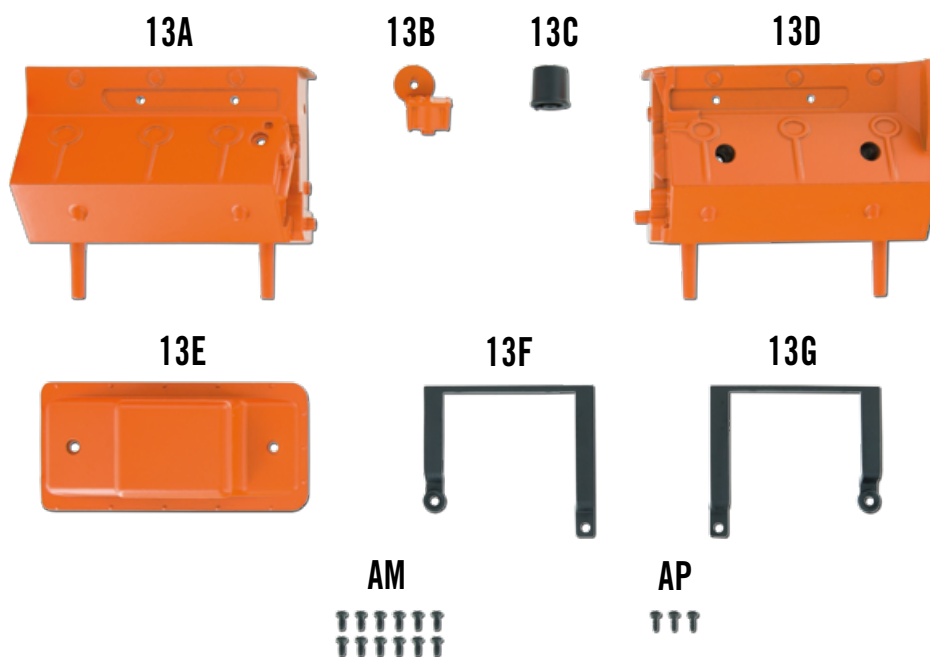

13A Engine block, left bank

13B Oil filter mount

13C Oil filter

13D Engine block, right bank

13E Oil pan

13F Left engine mounting bracket

13G Right engine mounting bracket

12H Starter motor, piece 2

AM Screw 2×4 mm (x 12)*

AP Screw 1.7×4 mm (x 2)*

* Some of the parts are spares.



ENGINE BLOCK

These items are not toys; keep out of reach of children. The product is part of an assembly kit intended for an adult audience. Assemble with the utmost care following the instructions in the attached manual; modifications or tampering are prohibited. Made in China. Read and keep for further reference.



13.1 **ALIGN** the linchpin inside the oil filter **13C** with the hole in the mount **13B**. Join the pieces together with a type **AP** screw. ►

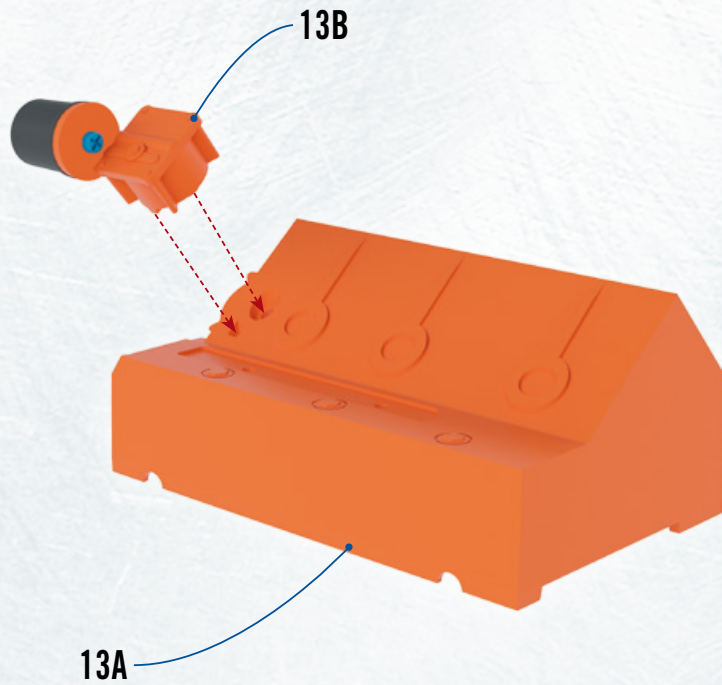
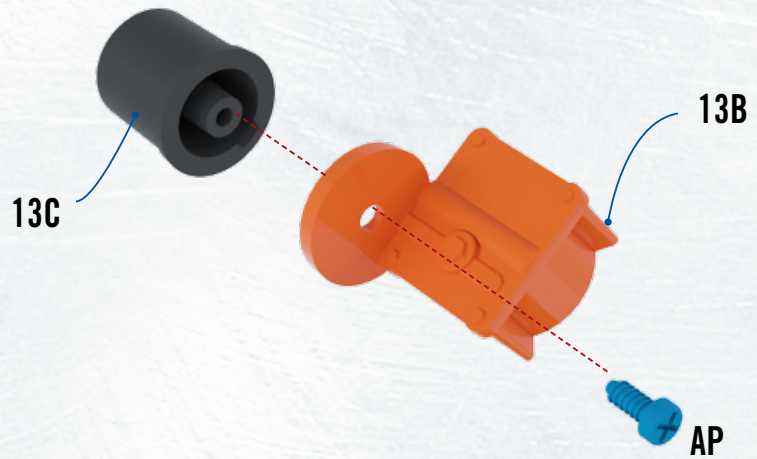

13.2 **NOW ATTACH** the piece you have just made to the left bank of the engine block **13A**. To do this, insert the linchpins on the oil filter mount **13B** into the corresponding holes. ◀

13.3 **NOW TURN** the left bank **13A** over and insert a type **AP** screw; tighten the screw to fix the piece in place. ►

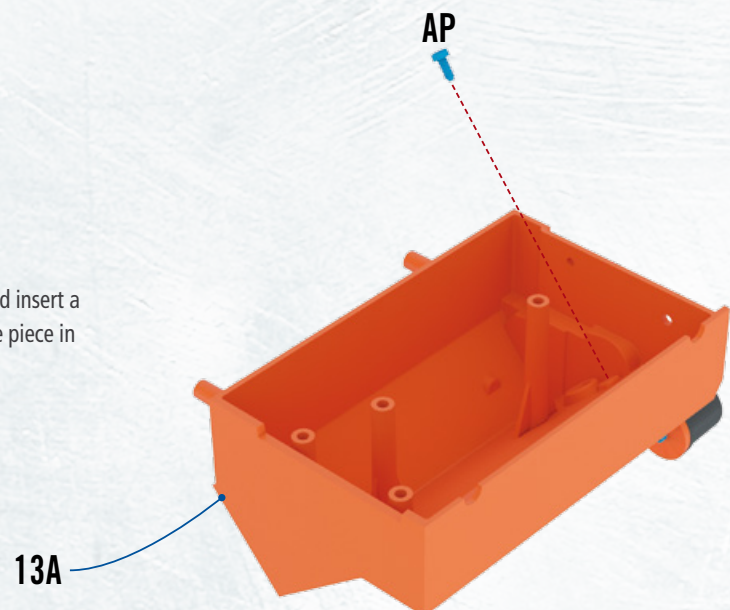



13.4 **FIND** the rectangular groove on the top surface of the left bank **13A**. Put the left engine mounting bracket **13F** into the groove, with the longest arm facing the oil filter. Join the pieces with two type **AM** screws. ►

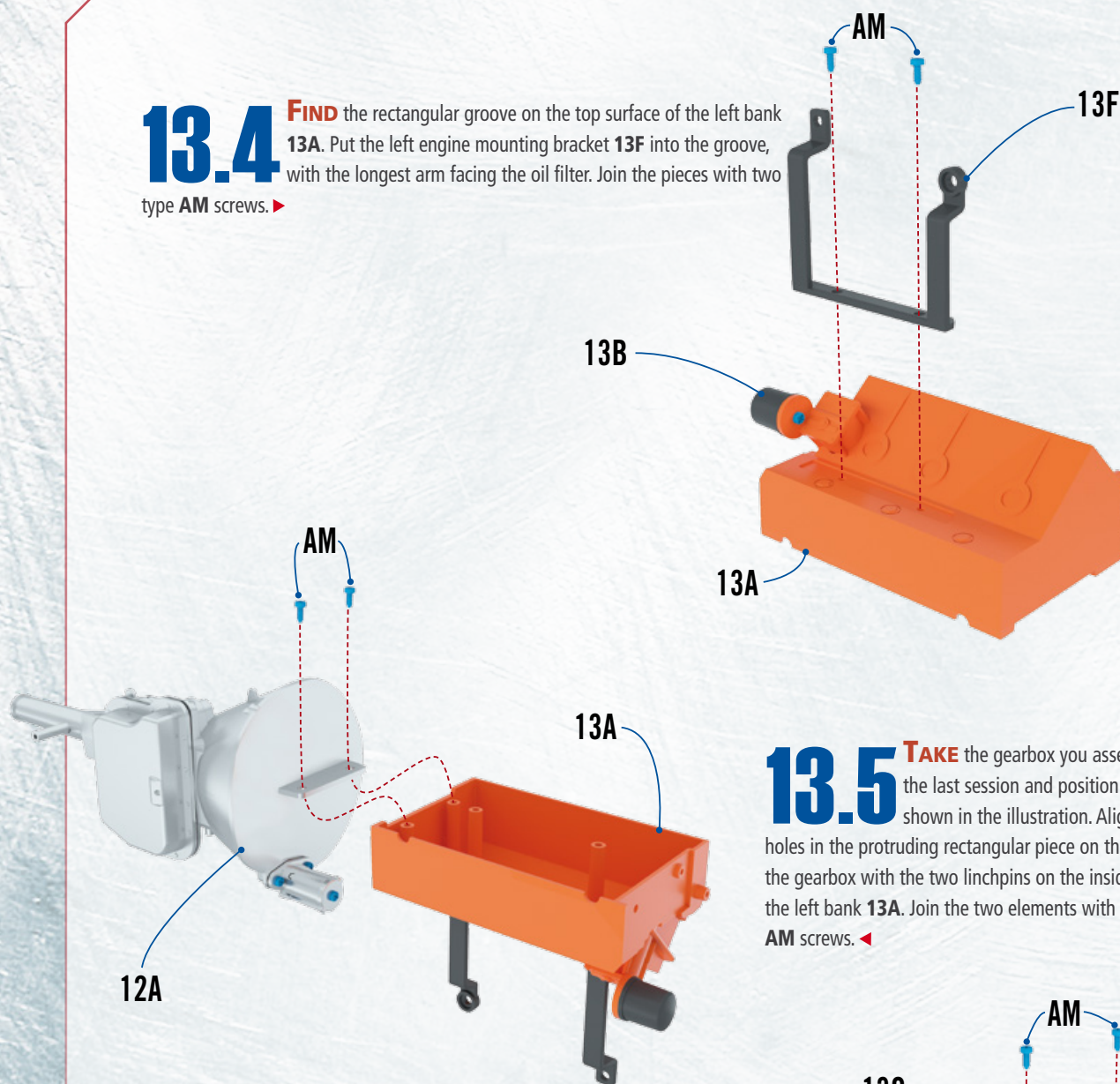

13.5 **TAKE** the gearbox you assembled in the last session and position it as shown in the illustration. Align the holes in the protruding rectangular piece on the base of the gearbox with the two linchpins on the inside wall of the left bank **13A**. Join the two elements with two type **AM** screws. ◀

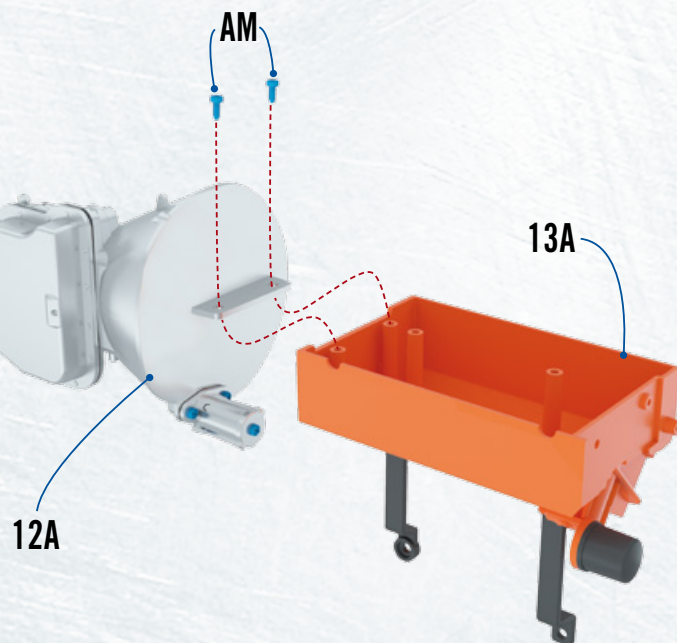

13.6 **NOW PUT** the right engine mounting bracket **13G** into the rectangular groove in the right bank **13D**. Position the pieces as shown in the illustration and join the two elements together with two type **AM** screws. ►

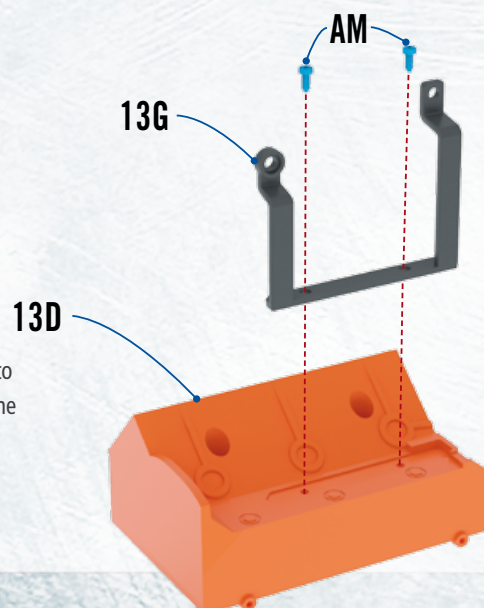



13.7 **Now PUT** the two banks of the engine block (**13A** and **13D**) together by aligning the holes with the fixing linchpins. Fix in place with two type **AM** screws. ▶

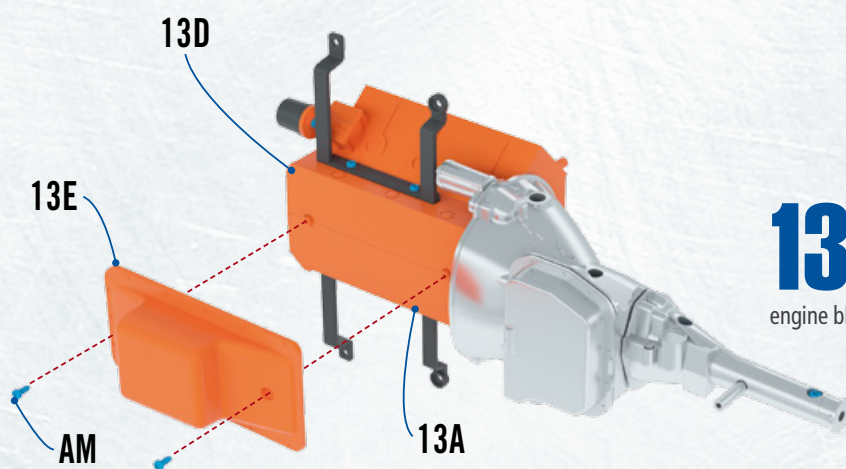
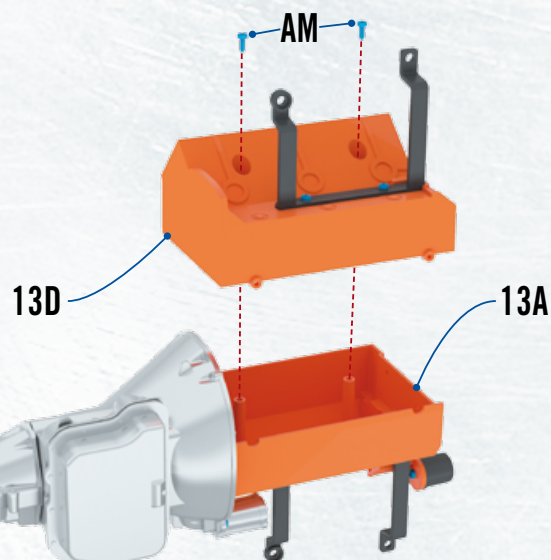

13.8 **Now ATTACH** the oil pan **13E**, ensuring that it is facing the same way as shown in the illustration. Attach it to the engine block with two type **AM** screws. ◀

STAGE 13 FINAL RESULT

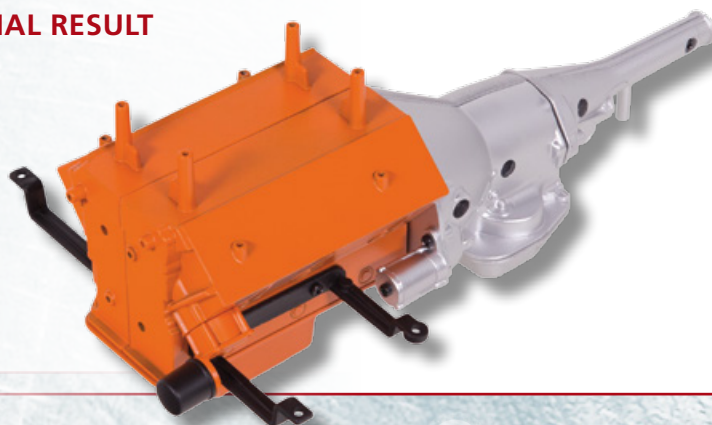

◀ This is the result of this interesting assembly session. Keep what you have built so far in a safe place until needed.

ASSEMBLING THE ENGINE BLOCK (II)

STAGE

14

In this assembly session, you will continue assembling the engine block of your model car. Follow our instructions carefully, using the illustrations to help you.

PIECES FOR THIS STAGE

14A



14B



14C



14D



14E



CM



DP



14A Cylinder head, left bank

14B Cylinder head, right bank

14C Cylinder head covers (x 2)

14D Oil filler caps (x 2)

14E Oil filler cap covers (x2)

CP Screws 1.7×3 mm (x 14)*

DP Screws 1.5 ×4 mm (x 3)*

* Some of the parts are spares.



ENGINE BLOCK

These items are not toys; keep out of reach of children. The product is part of an assembly kit intended for an adult audience. Assemble with the utmost care following the instructions in the attached manual; modifications or tampering are prohibited. Made in China. Read and keep for further reference.



14.1 **TAKE ONE** of the oil filler caps **14D** and slide it onto the corresponding linchpin on one of the two cylinder head covers **14C**. Attach with a type **DP** screw. ►

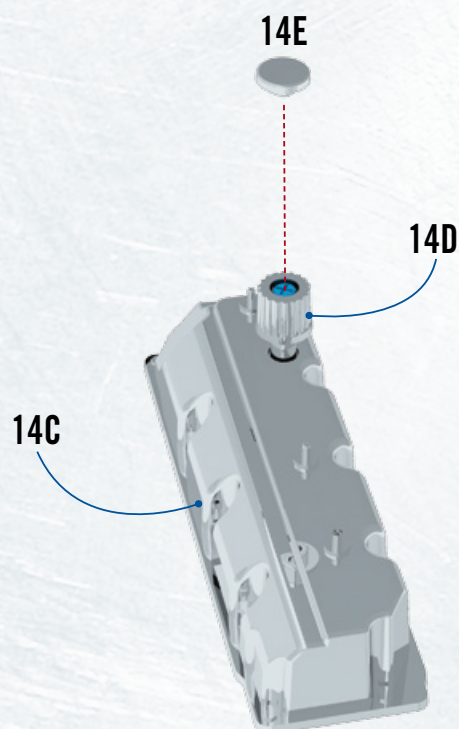
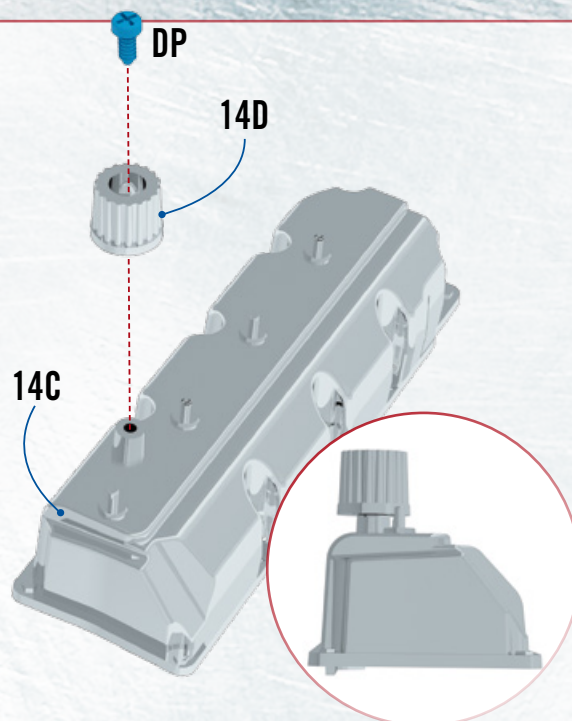

14.2 **PUT** a cap cover **14E** on it. Press down gently to attach it. ◀

14.3 **ATTACH** the left bank cylinder head **14A** (indicated with the letter "L" on the bottom) to the left side of the assembled engine block. Ensure that it is facing the same way as that shown in the illustration, then fix in place with two type **CM** screws. ►

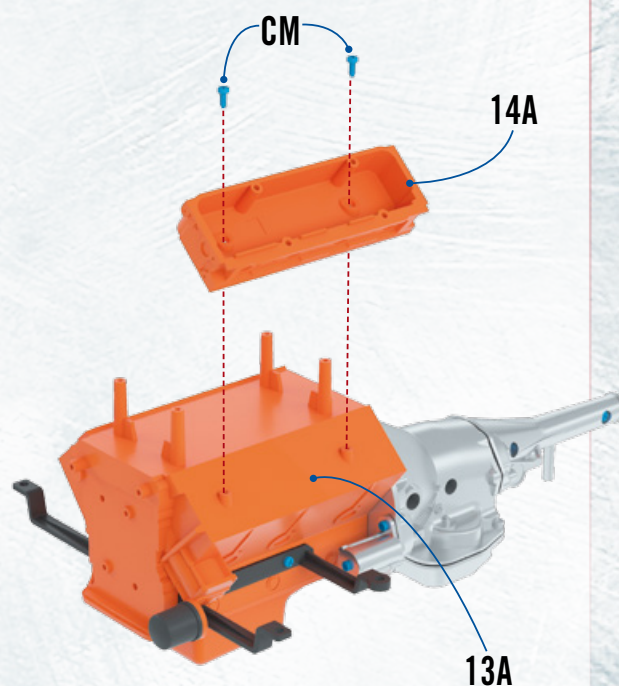



14.4 **PUT** the previously assembled cover **14C** onto the cylinder head **14A**. Ensure that both pieces are facing the correct way and then join them together with four type **CM** screws. ▶

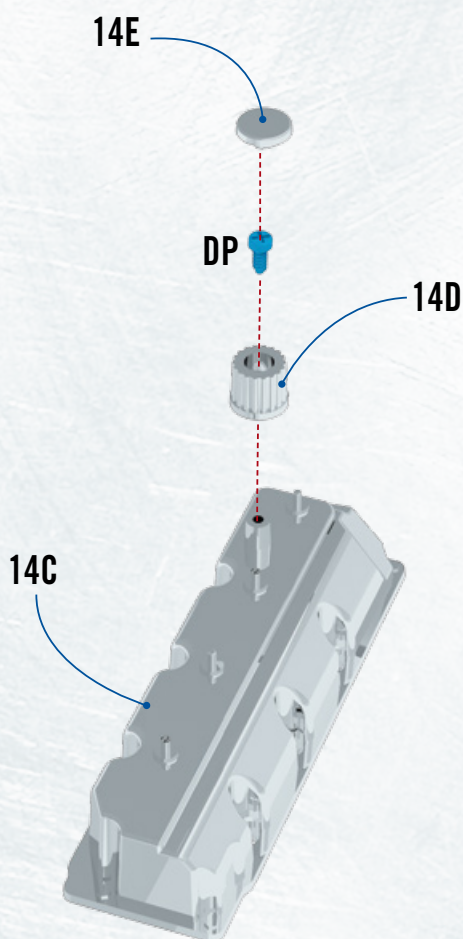
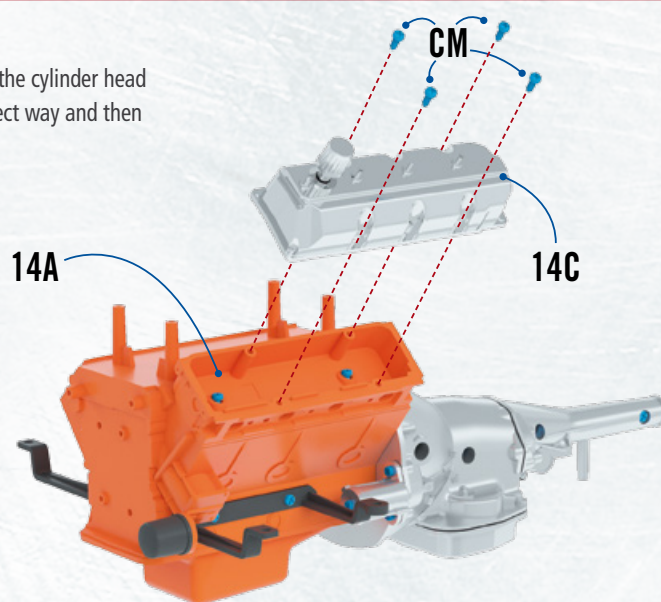

14.5 **PUT** the oil filler cap **14D** and the corresponding cap cover **14E** onto the second cover **14C**. ◀

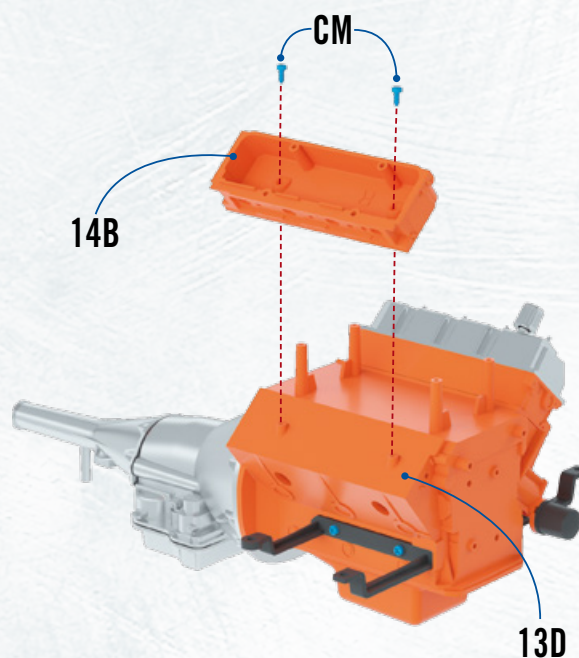

14.6 **ATTACH** the right cylinder head **14B** to the engine block **13D** using two type **CM** screws. ▶



14.7 **FINALLY**, attach the right cylinder head cover to the engine block with four type **CM** screws.▶

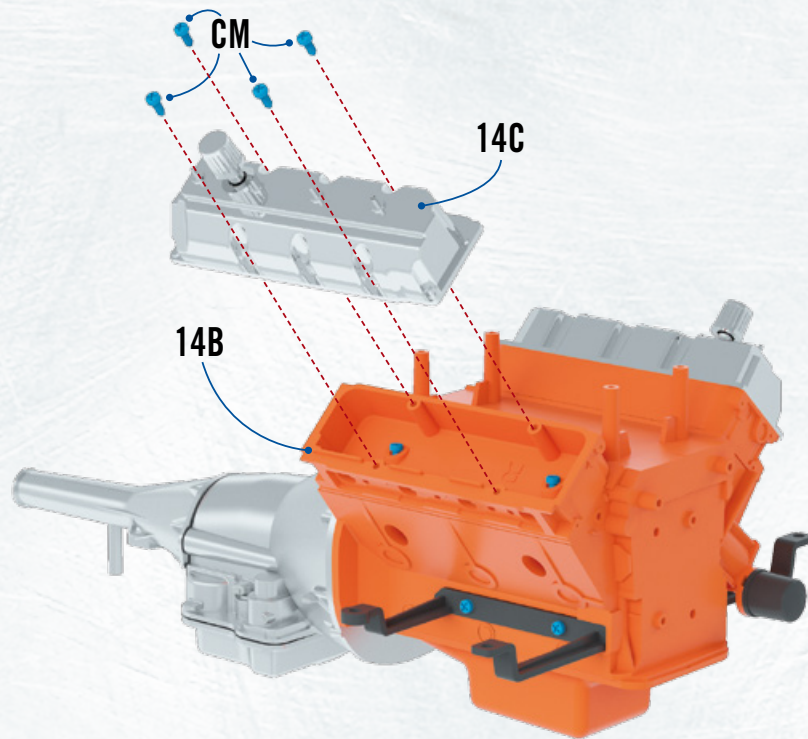

STAGE 14 FINAL RESULT

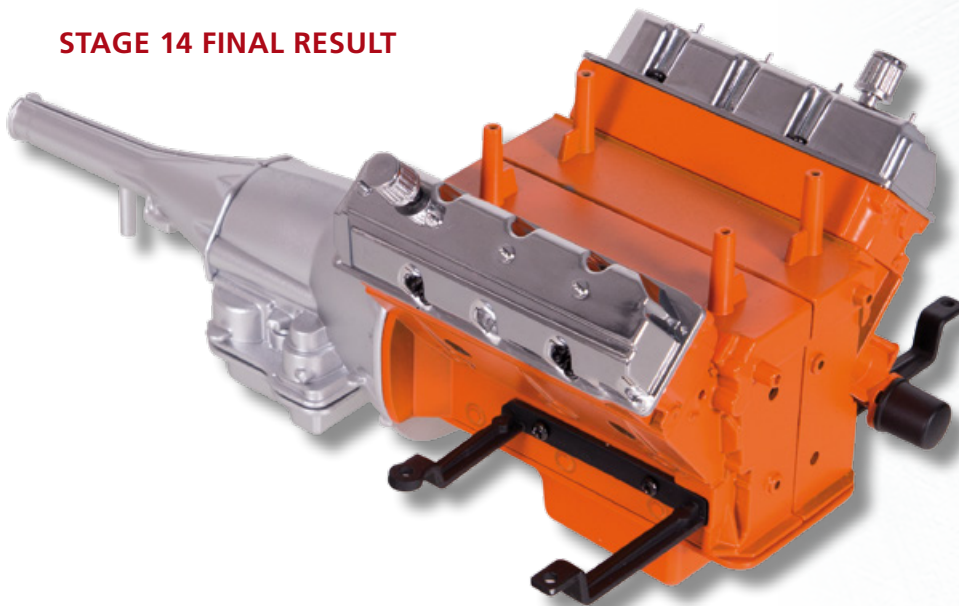

◀ The engine for your model now has two cylinder heads with covers. You will continue building the engine in the following assembly sessions.

ASSEMBLING THE ENGINE BLOCK (III)

STAGE

15

In this assembly session, you will be working with the inlet manifold and the air intake of the supercharger. Follow our instructions carefully, using the illustrations to help you.

PIECES FOR THIS STAGE

15A



15B



15C



15D

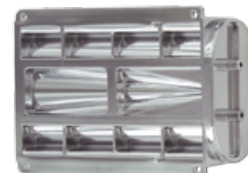

15E



15F



15G



15H



15I



15J



AP



CM



15A Inlet manifold (piece 1)

15B Inlet manifold (piece 2)

15C Inlet manifold (piece 3)

15D Supercharger housing

15E Rear plate of supercharger

15F Fuel injectors (x 10)*

15G Fuel injection lines 1 (x 2)

15H Fuel injection lines 2 (x 2)

15I Fuel injection lines 3 (x 2)

15J Fuel injection lines 4 (x 2)

AP Screws 1.7x4 mm (x 19)*

CM Screws 1.7x3 mm (x 5)*

* Some of the parts are spares.



ENGINE BLOCK

These items are not toys; keep out of reach of children. The product is part of an assembly kit intended for an adult audience. Assemble with the utmost care following the instructions in the attached manual; modifications or tampering are prohibited. Made in China. Read and keep for further reference.



15.1 **ALIGN** the four mounting holes in piece 1 of the inlet manifold **15A** with the corresponding linchpins on piece 2 **15B**, ensuring the pieces face the same way as those in the illustration. Attach with four type **AP** screws. ▶

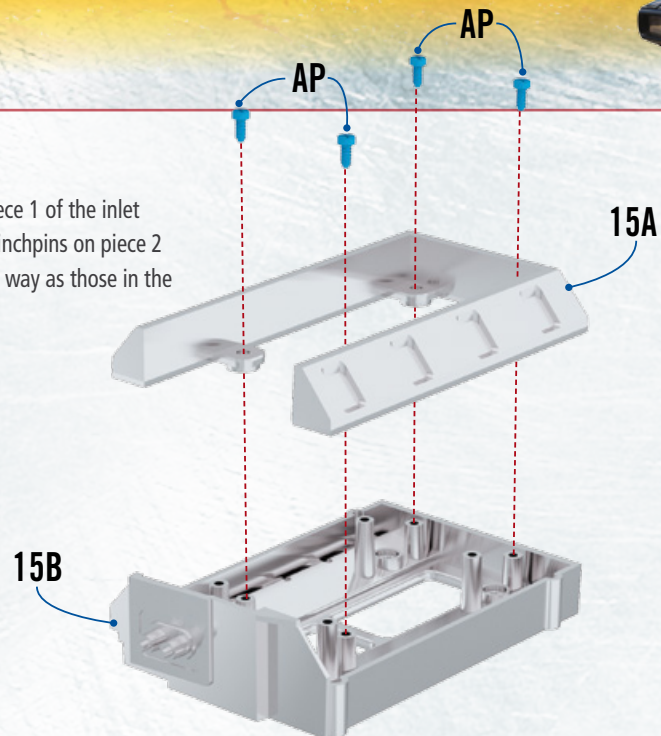

15.2 **YOU WILL NOW** attach piece 3 of the inlet manifold **15C**. Align the four mounting holes with the linchpins on piece 2 **15B**. Join with four type **AP** screws. ◀

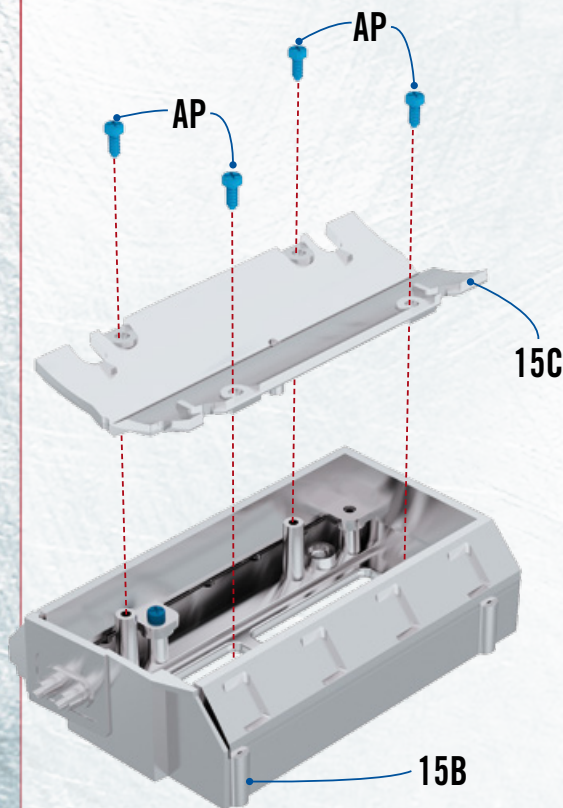

15.3 **TAKE** the engine block you assembled in the previous sessions. Attach the completed inlet manifold by aligning the four holes with the corresponding linchpins, then fix in place with four type **CM** screws. ▶

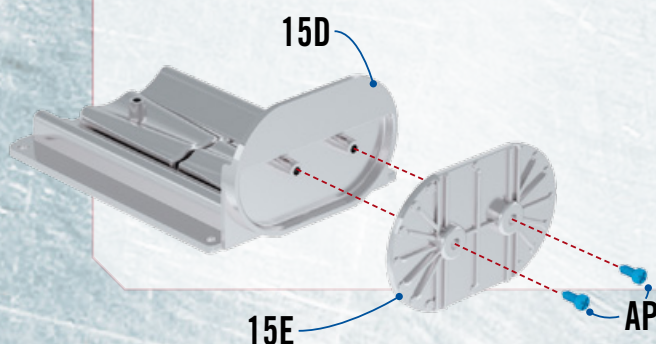
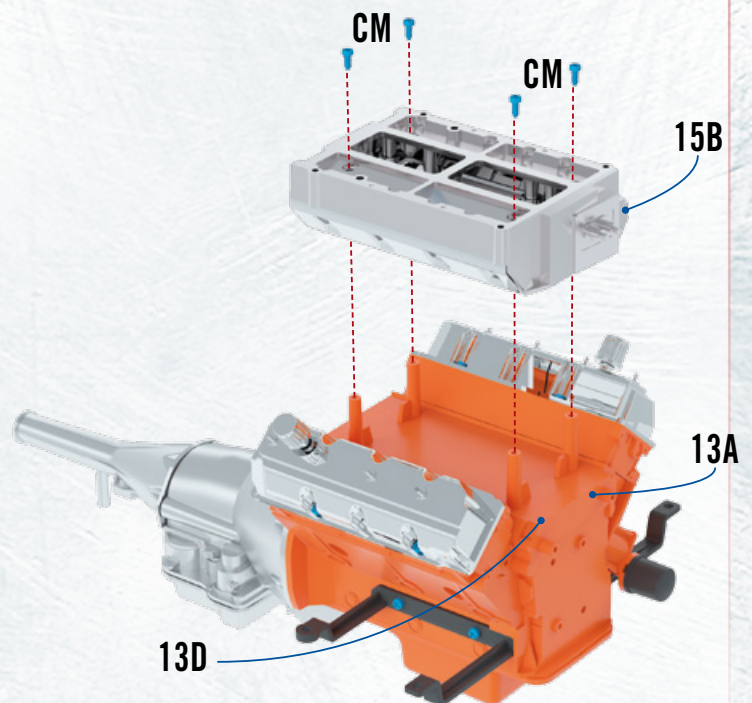

15.4 **JOIN** the two parts **15E** and **15D** of the supercharger together, using two type **AP** screws. ◀



15.5 **ATTACH** the piece you assembled above to piece 2 of the inlet manifold **15B**, with the parts facing the same way as those in the illustration. Join with four type **AP** screws. ▶

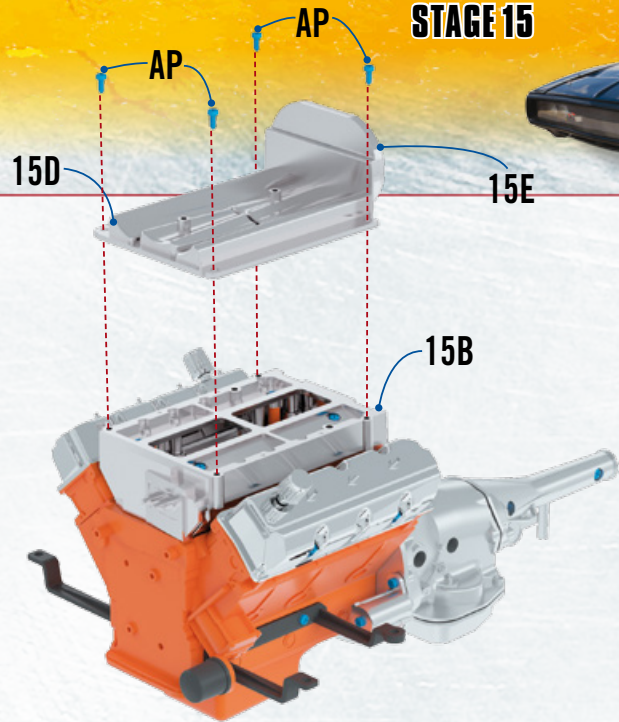
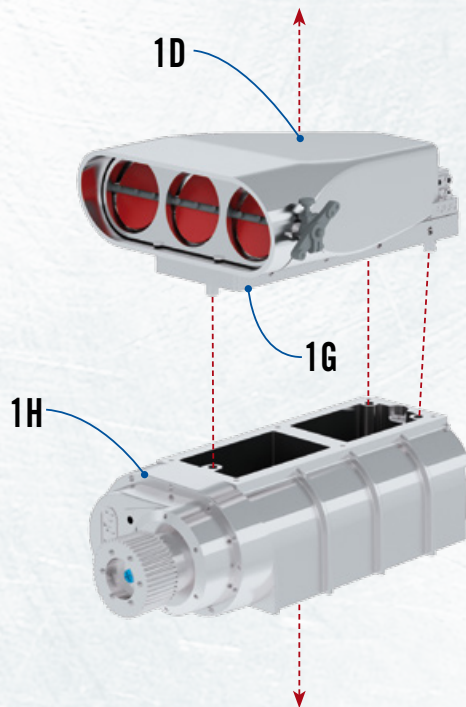

15.6 **TAKE** the air intake unit you assembled in the first assembly session. Carefully detach the air intake from the supercharger. ◀

15.7 **PUT** the supercharger unit **1H** and the housing **15D** together. Make sure the side with the pulley is facing the right way. ▶

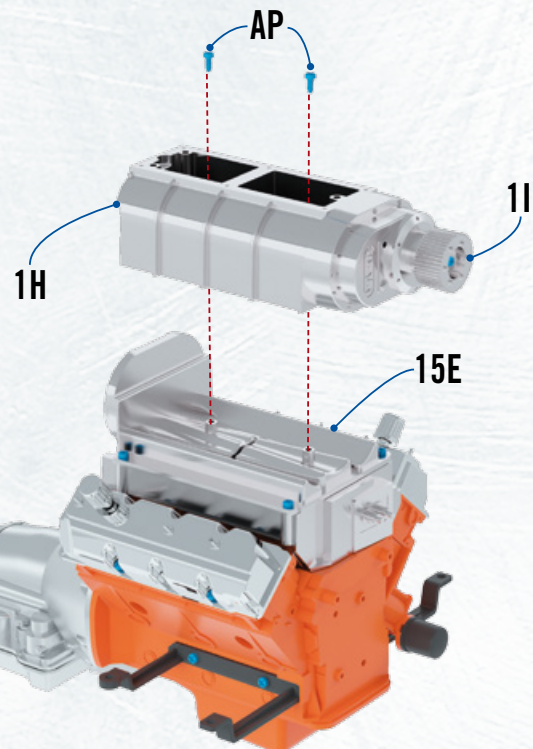
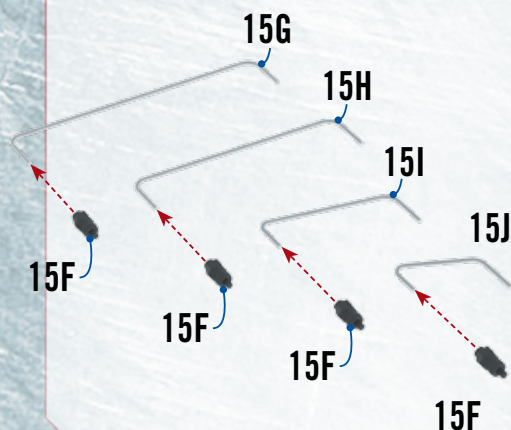

15.8 **ATTACH** the fuel injectors **15F** to the fuel injection lines **15G**, **15H**, **15I** and **15J**, by inserting the shortest end of each line into the fuel injectors. ◀



15.9 **TURN** the air intake over, as shown in the illustration. Insert the free end of the fuel injection line 3 **15I** into the top left hole in the distributor **1L**, and the linchpin on its fuel injector **15F** into the third hole from the left in the injector plate **1G**. Insert the free end of the fuel injection line 1 **15G** into the bottom left hole in the distributor **1L**, and the linchpin on its injector **15F** into the first hole on the left in the injector plate **1G**. ▶

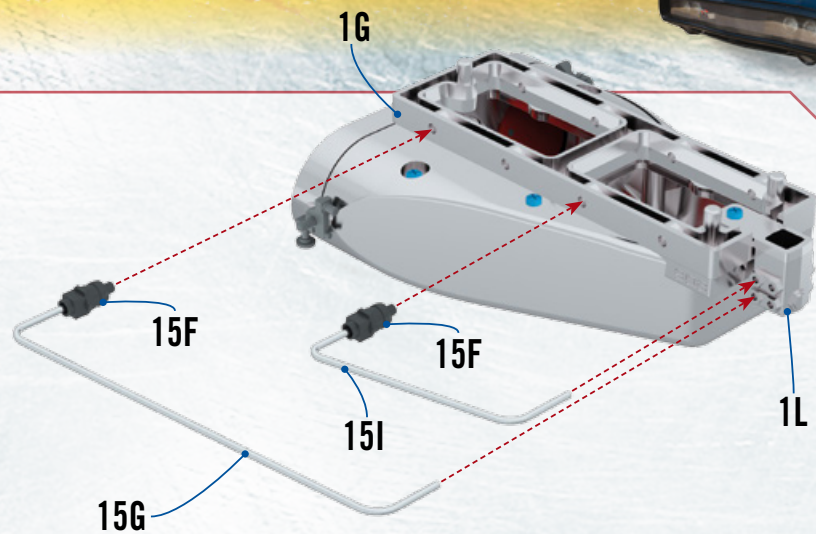

15.10 **INSERT** the free end of the fuel injection line 4 **15J** into the top right hole in the distributor **1L**, and the linchpin on its fuel injector **15F** into the last hole in the injector plate **1G**. Now insert the free end of the fuel injection line 2 **15H** into the bottom right hole in the distributor **1L**, and the linchpin on its injector **15F** into the second a last hole in the injector plate **1G**. ▶

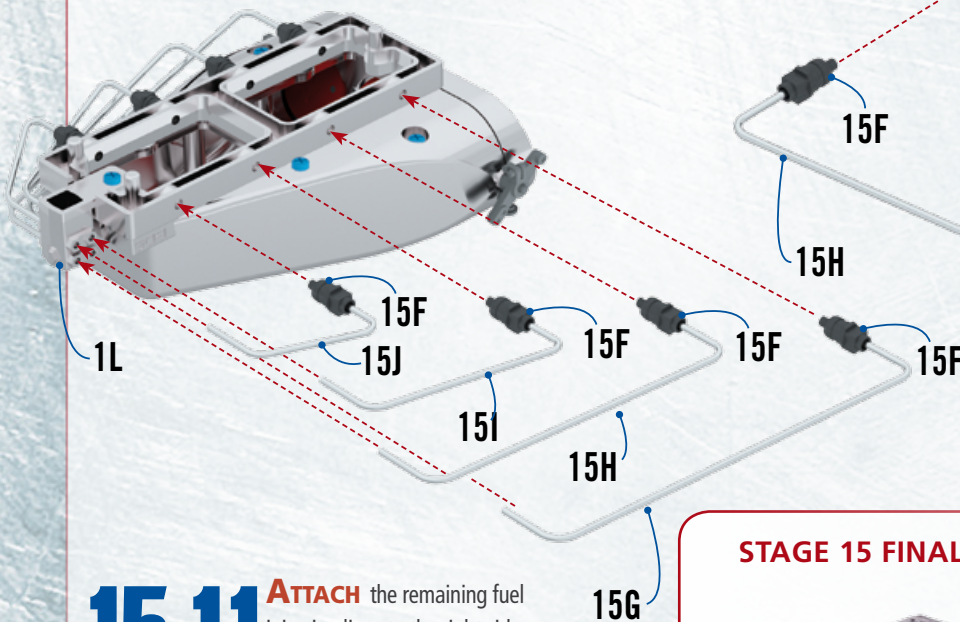
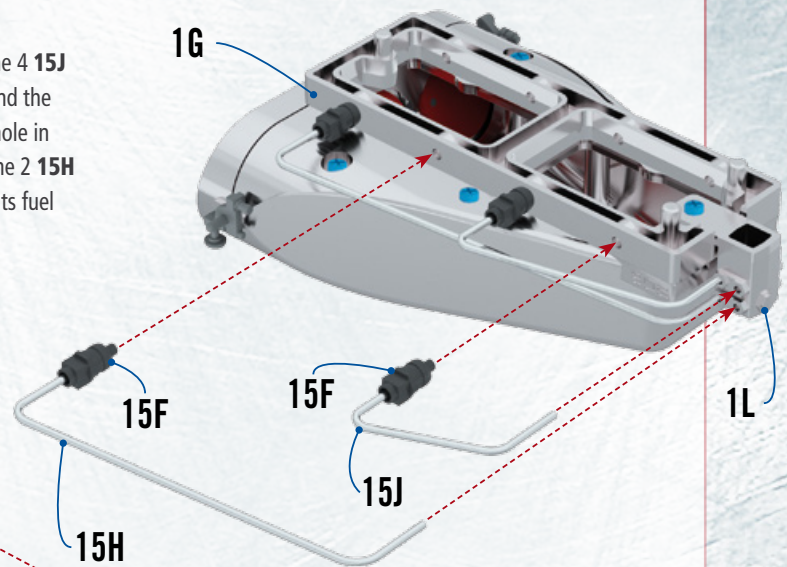

15.11 **ATTACH** the remaining fuel injection lines to the right side of the injector plate **1G**, in the same way you did for the left side. ▲

STAGE 15 FINAL RESULT



ASSEMBLING THE ENGINE BLOCK (IV)

STAGE

16

In this assembly session, you will prepare the second wheel and attach the front section of the chassis to your model car.

PIECES FOR THIS STAGE

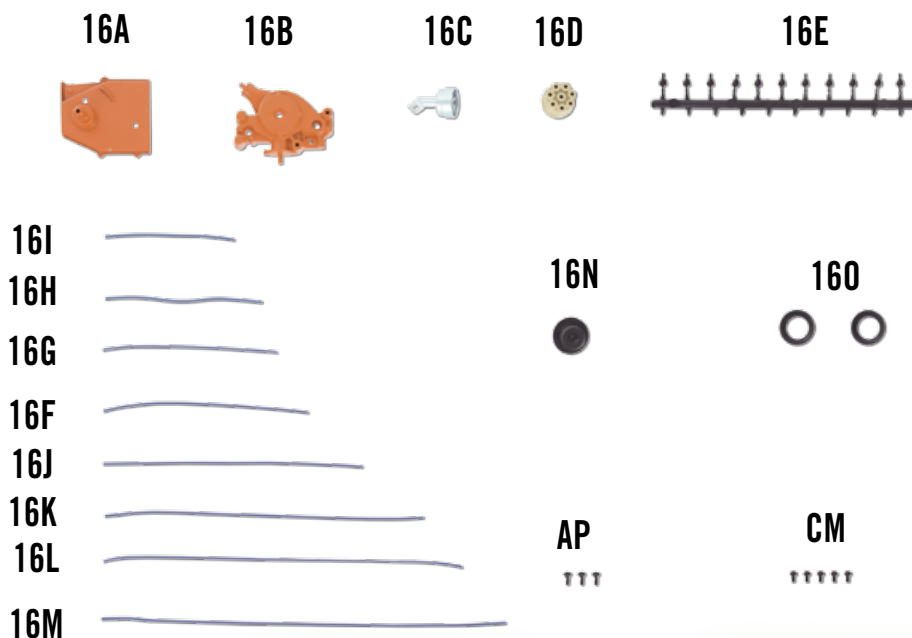

16A Timing cover

16B Water pump

16C Rotor

16D Distributor cap

16E Spark plug wire connectors (x 10)*

16F Spark plug wire 8 cm

16G Spark plug wire 7 cm

16H Spark plug wire 6 cm

16I Spark plug wire 5 cm

16J Spark plug wire 10 cm

16K Spark plug wire 12 cm

16L Spark plug wire 14 cm

16M Spark plug wire 15 cm

16N Fan sprocket

16O Bushings (x 2)

AP Screws 1.7×4 mm (x 19)*

CM Screws 1.7×3 mm (x 5)*

* Some of the parts are spares.



ENGINE BLOCK

These items are not toys; keep out of reach of children. The product is part of an assembly kit intended for an adult audience. Assemble with the utmost care following the instructions in the attached manual; modifications or tampering are prohibited. Made in China. Read and keep for further reference.



16.1 CAREFULLY DETACH

the connectors **16E** from the sprue, ensuring that you don't break the mounting linchpins. Now insert eight connectors into the distributor cap **16D**, ensuring they are facing the same way as those in the illustration. ►

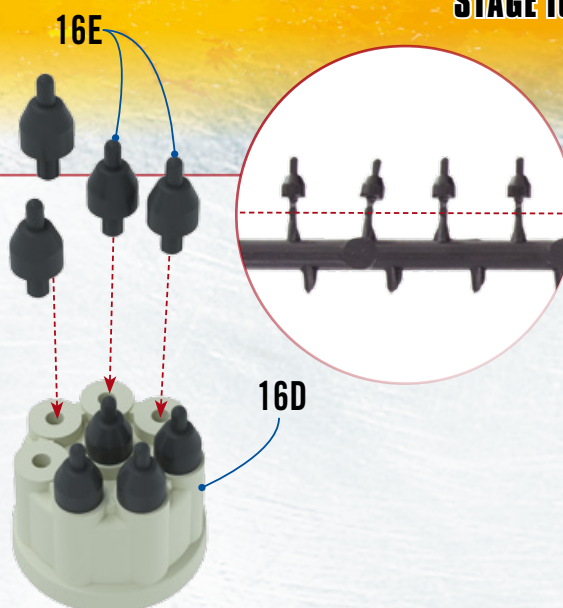

16.2 ATTACH

the distributor cap to the rotor **16C**, using the corresponding fixing linchpin. ▼

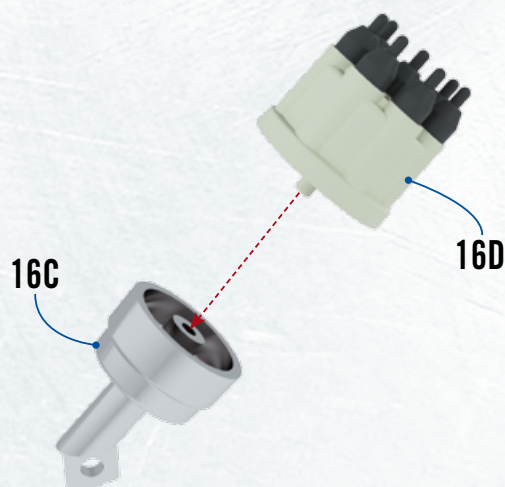

16.3 ALIGN

the mounting hole in the rotor **16C** with the corresponding hole in the water pump **16B**. Join the pieces with a type **AP** screw. ▼

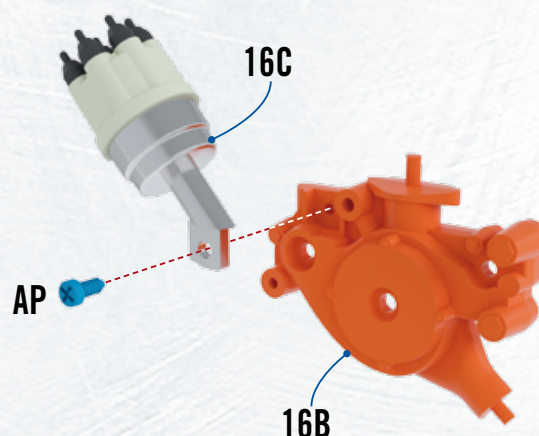

16.4 SLIDE

the two bushings **160** onto the smooth end of the fan sprocket **16N**. Note: the pieces must be positioned in exactly the same way as those in the illustration. ▼

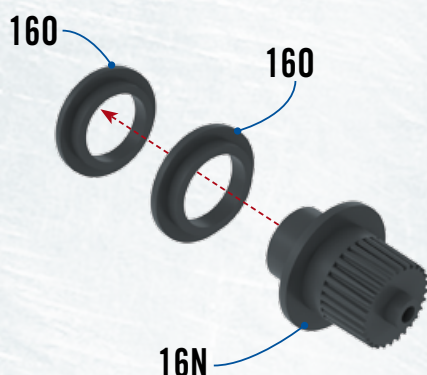

16.5 NOW ATTACH

what you have just assembled to the water pump **16B**, using the four small fixing linchpins. Use a type **AP** screw to make the piece more stable. ►

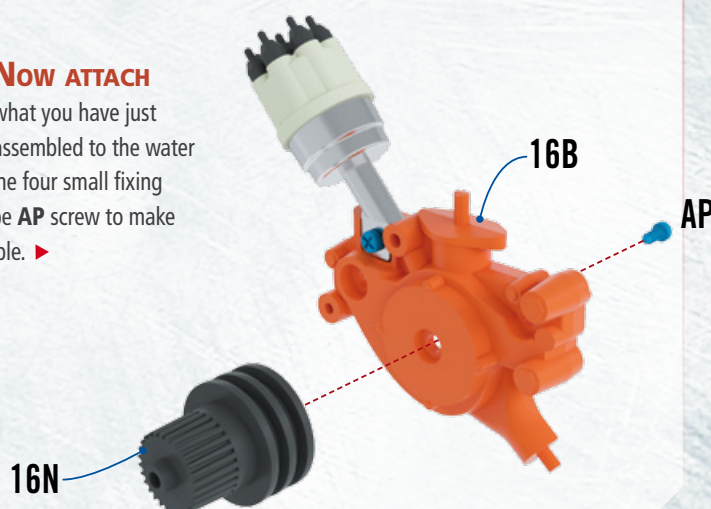



16.6 **TAKE** the engine block. Put the timing cover **16A** onto the front of the block and fix in place with two type **CM** screws. ▼

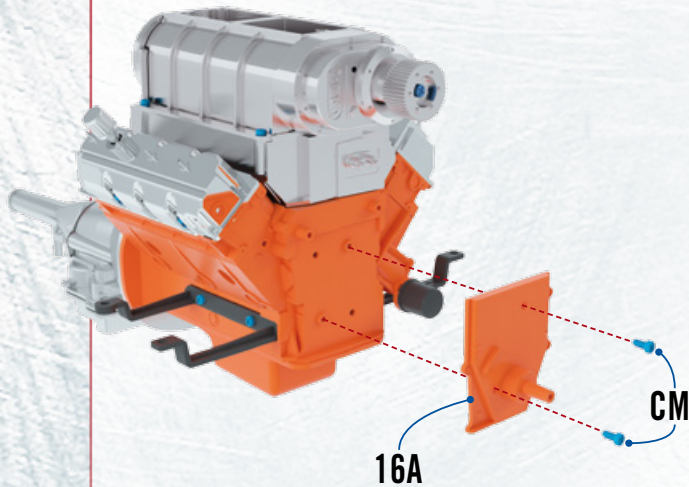

16.7 **ATTACH** the water pump **16B** to the front of the engine and fix in place with two type **CM** screws. ▼

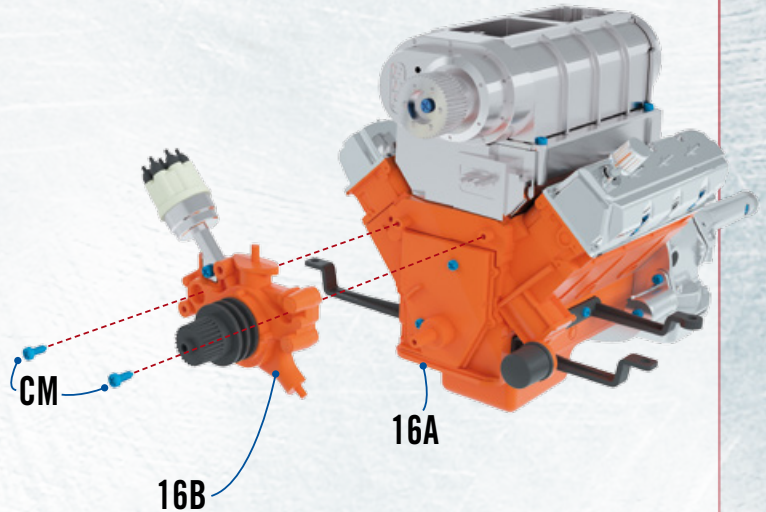

16.8 **SLIDE** one end of the spark plug wire **16I** (5 cm) onto the central spark plug wire connector **16E**. Connect the other end to the linchpin closest to the cylinder head cover **14C**. Now connect the wire **16H** (6 cm) to the second linchpin on the cylinder head cover and to the bottom left spark plug wire connector **16E**. ▼

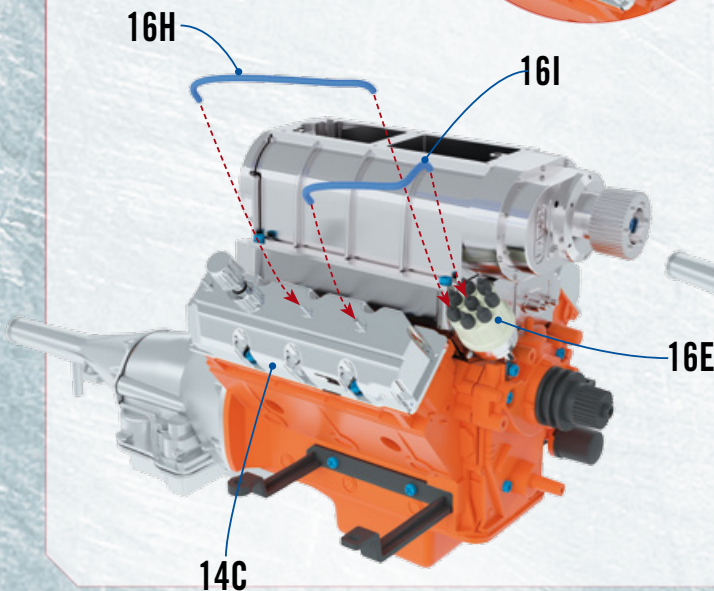

16.9 **CONNECT** spark plug wire **16G** (7 cm) to the left spark plug wire connector **16E** and to the third linchpin on the cylinder head cover **14C**. Using the spark plug wire **16F** (8 cm), connect the top left spark plug wire connector **16E** to the last linchpin on the cylinder head cover **14C**. ▼

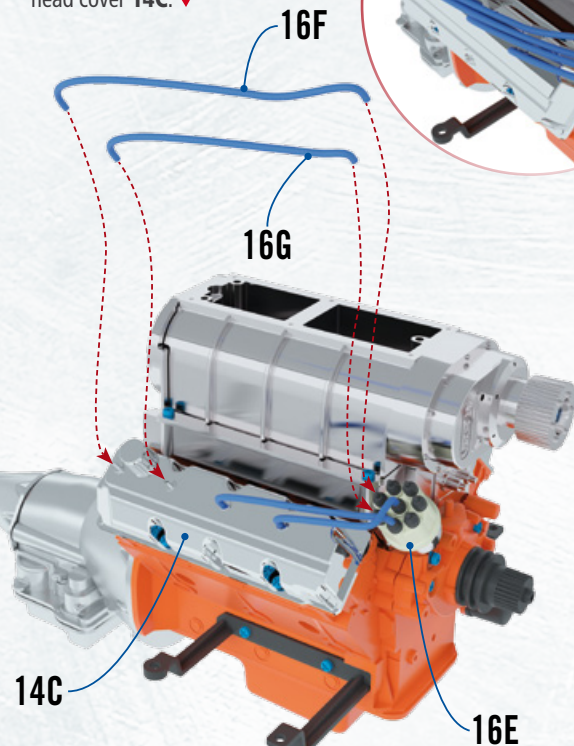
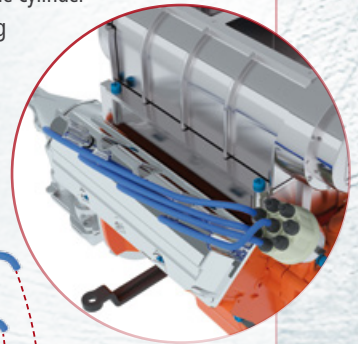

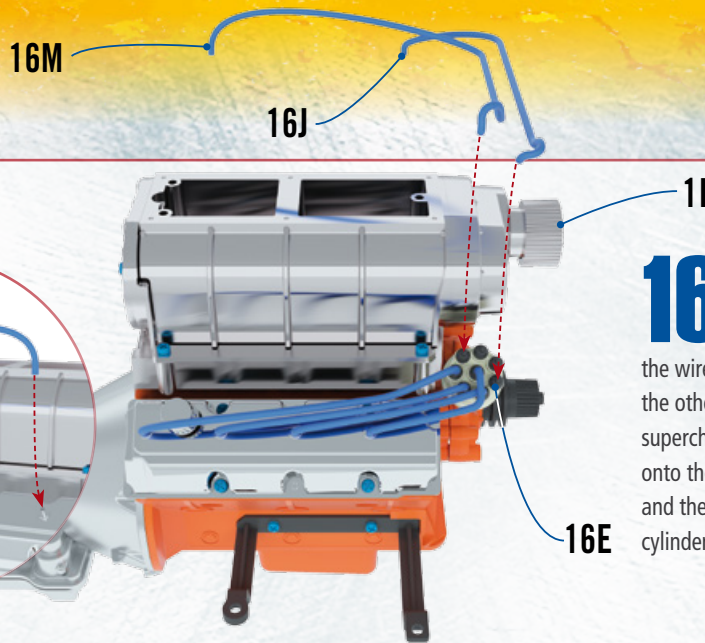

16.10 **SLIDE** one end of the spark plug wire **16M** (15 cm) onto the top left spark plug wire connector **16E** and the wire **16J** (10 cm) onto the bottom right connector. On the other side, by passing the wires underneath the supercharger pulley **11**, slide the free end of the wire **16M** onto the furthest linchpin on the cylinder head cover **14C**, and the free end of wire **16J** onto the first linchpin on the cylinder head cover **14C**. ◀

16.11 **SLIDE** the spark plug wire **16L** (14 cm) onto the top spark plug wire connector **16E**, and the wire **16K** (12 cm) onto the remaining connector. Pass the wires underneath the supercharger pulley and connect wire **16L** to the furthest linchpin on the cylinder head cover **14C**. Finally, connect wire **16K** to the remaining linchpin on the cylinder head cover. ▶

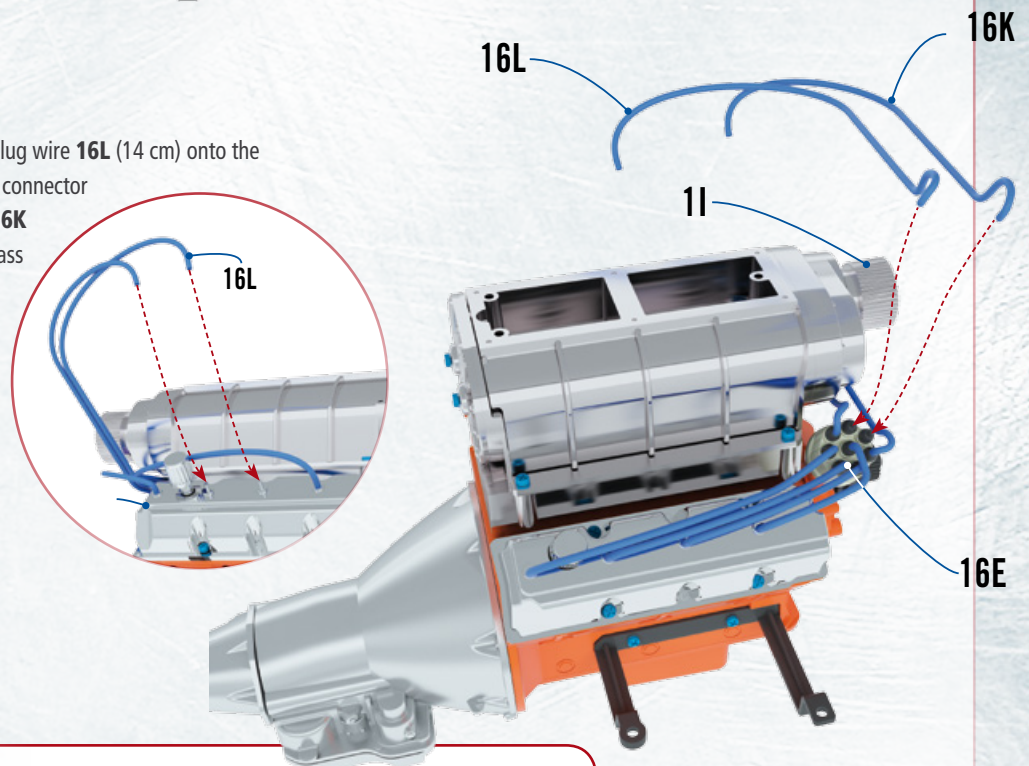

STAGE 16 FINAL RESULT

➔ You have now installed the rotor and the spark plug wires in the engine of your model car. Put what you have built so far in a safe place.

