

FAST & FURIOUS *pack™*

10

Build the Legendary
DODGE CHARGER R/T



D'AGOSTINI
MODELSPACE™
www.model-space.com



FAST & FURIOUS

Build the Legendary

DODGE CHARGER R/T

Editorial by: Milanoedit srl, milanoedit.com

Translation by: TperTradurre

Picture credits: NBCUniversal Archive

© 2019 Universal City Studios LLC.

Fast & Furious and all related marks and characters are trademarks and copyrights of Universal Studios.

All Rights Reserved.

Dodge, HEMI and related logos, vehicle model names and trade dress are trademarks of FCA US LLC and used under license by Premium and Collectibles Trading Co. Ltd. ©2019 FCA US LLC.

© 2019 Editorial Planeta DeAgostini S.A.U.

Todos los derechos reservados.

© 2019 De Agostini Publishing Italia S.p.A.

Tutti i diritti riservati.

Warning: Not suitable for children under the age of 14.

This product is not a toy and is not designed or intended for use in play.

Items may vary from those shown.



Pack 10

Stage 37

Installing the rear brakes

Stage 38

Left rear leaf spring

Stage 39

Right rear leaf spring

Stage 40

Attaching the leaf springs to the axle



INSTALLING THE REAR BRAKES

STAGE

37

In this assembly session you will install the two brake discs and the calipers on the rear axle. You will also connect the relevant hoses.

PIECES FOR THIS STAGE

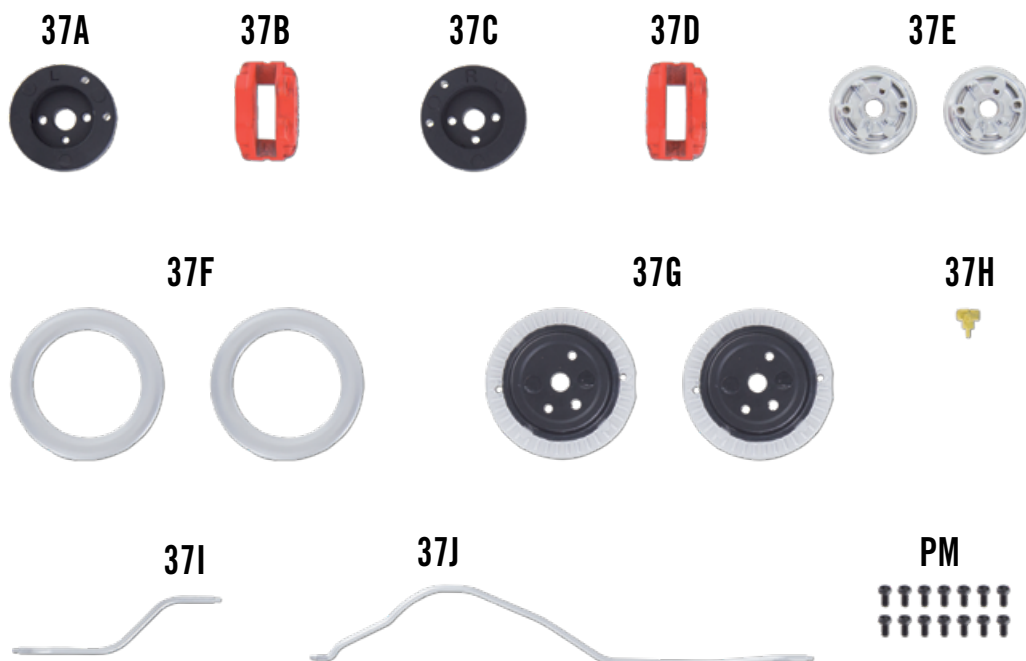

37A Left rear brake caliper mounting bracket
 37B Left rear brake caliper
 37C Right rear brake caliper mounting bracket
 37D Right rear brake caliper
 37E Rear wheel hub (x 2)
 37F Brake disc (piece 1) (x 2)

37G Brake disc (piece 2) (x 2)
 37H Rear brake hose fitting
 37I Left rear brake hose
 37J Right rear brake hose
 PM Screws 1.7×3,5 mm (x 3)*

* Some of the parts are spares.



REAR AXLE

Publisher Note: the appearance of the parts shown on these pages may differ from that of the pieces included in this pack.
 This in no way affects the quality or assembly instructions.

These items are not toys; keep out of reach of children. The product is part of an assembly kit intended for an adult audience. Assemble with the utmost care following the instructions in the attached manual; modifications or tampering are prohibited. Made in China. Read and keep for further reference.



37.1 **JOIN** one of the piece 1 brake discs **37F** to a piece 2 **37G**, inserting the linchpins on the first into the corresponding holes in the second. ►

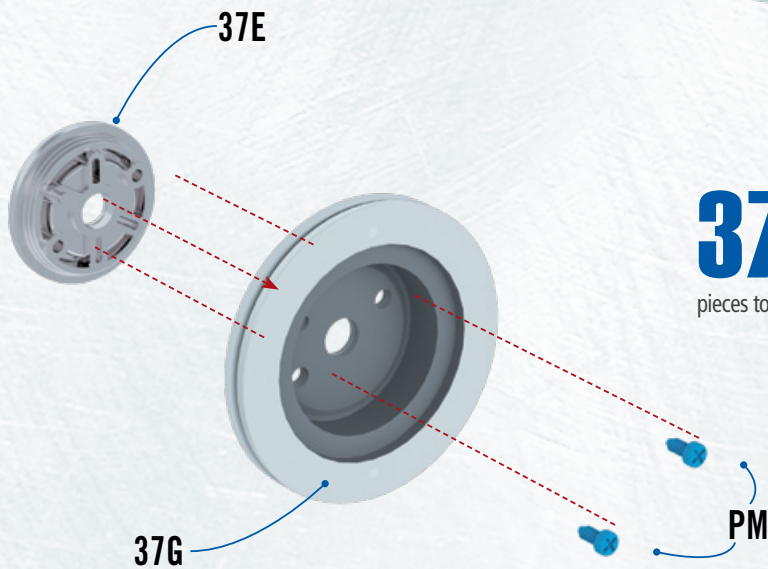
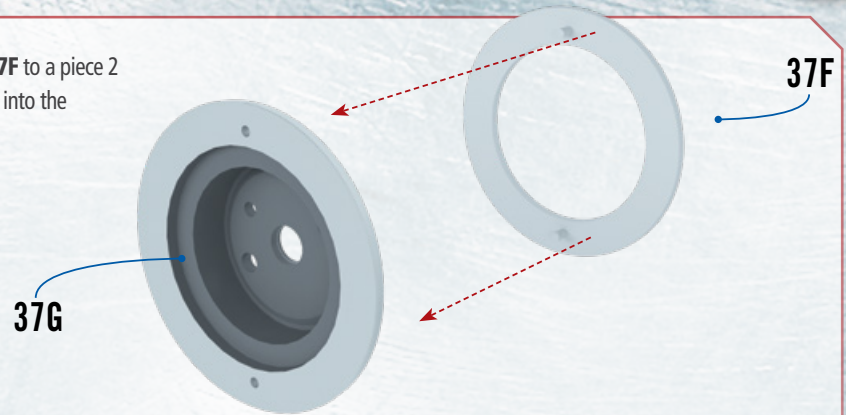

37.2 **NOW ATTACH** the rear wheel hub **37E**, as shown in the illustration. Insert two type **PM** screws from the concave side of the brake disc to join the pieces together. ◀

37.3 **SLIDE** the mounting bracket **37A** onto the left end of the rear axle **36A**. The letter "L" on piece **37A** must be facing outwards. Use two type **PM** screws to secure the piece. ►

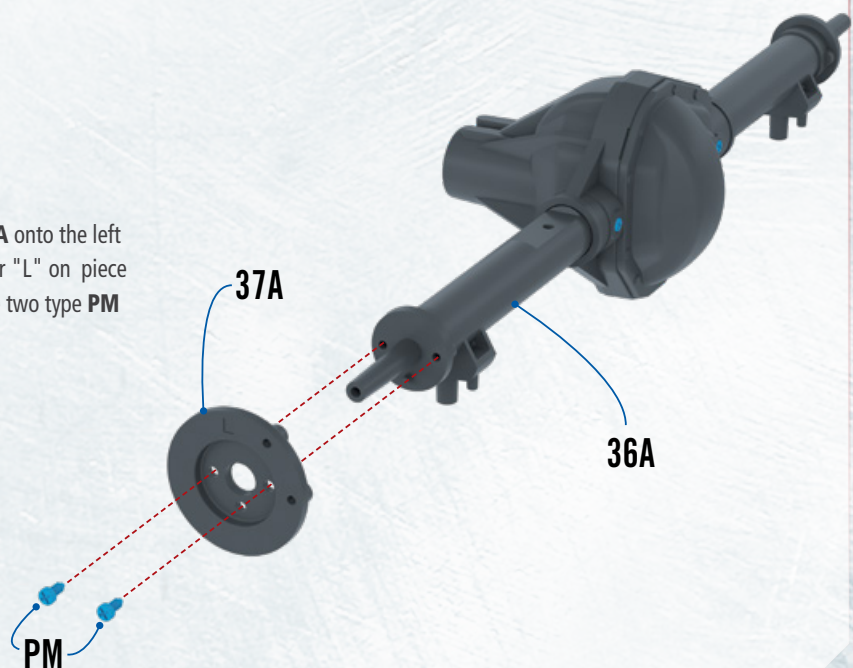

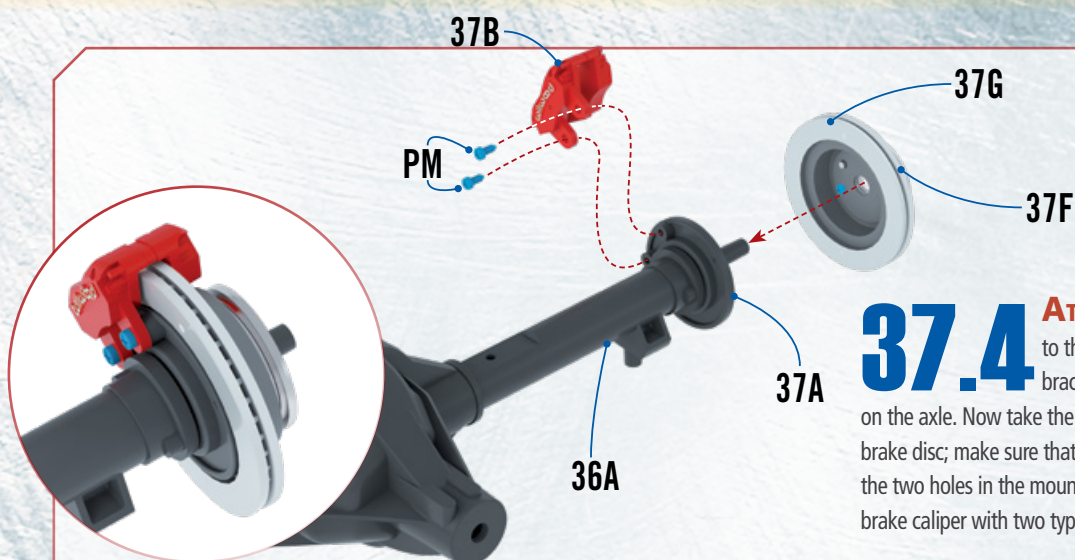

37.4 **ATTACH** the brake disc (37G and 37F) to the left rear brake caliper mounting bracket 37A that you have just mounted on the axle. Now take the left caliper 37B and attach it to the brake disc; make sure that the holes in the tabs are aligned with the two holes in the mounting bracket 37A. Now secure the brake caliper with two type PM screws. ◀

37.5 **ASSEMBLE** the second brake disc by attaching the remaining pieces 37G, 37F and 37E. Join with two type PM screws. ▶

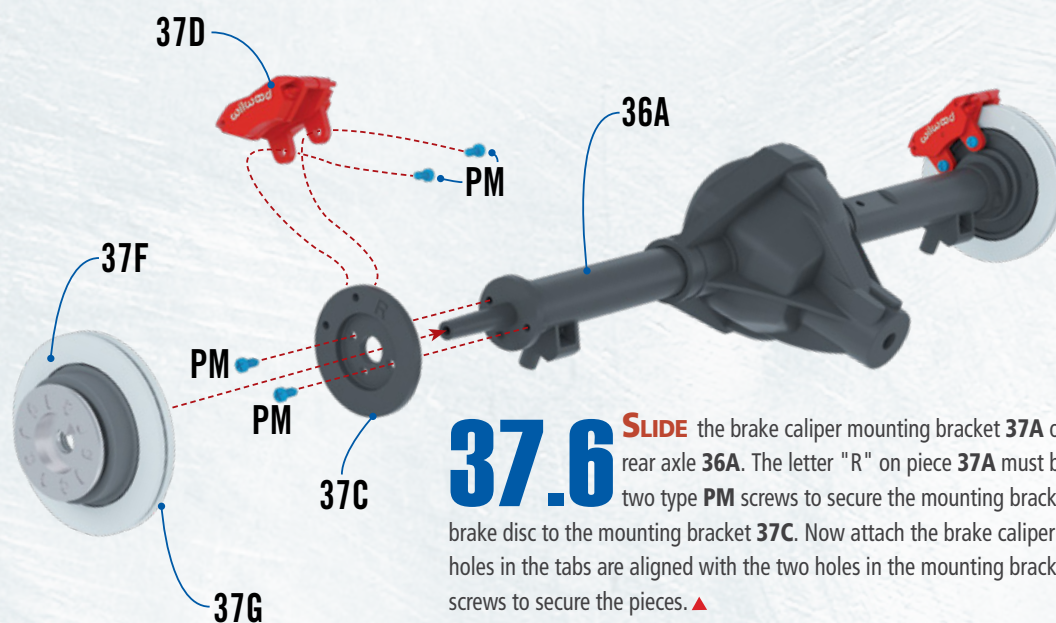
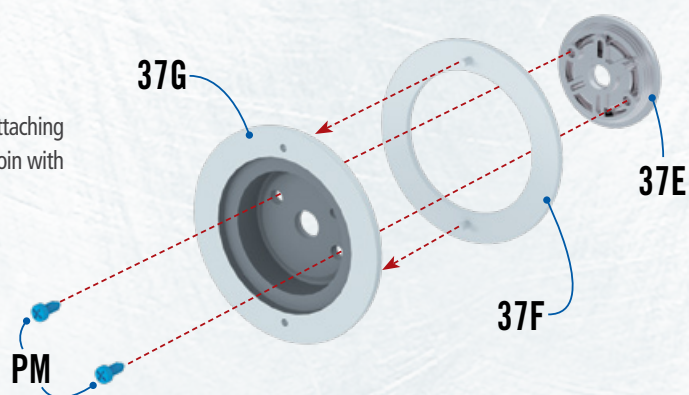

37.6 **SLIDE** the brake caliper mounting bracket 37A onto the right end of the rear axle 36A. The letter "R" on piece 37A must be facing outwards. Use two type PM screws to secure the mounting bracket. Attach the completed brake disc to the mounting bracket 37C. Now attach the brake caliper 37D, making sure that the holes in the tabs are aligned with the two holes in the mounting bracket 37C. Use two type PM screws to secure the pieces. ▲

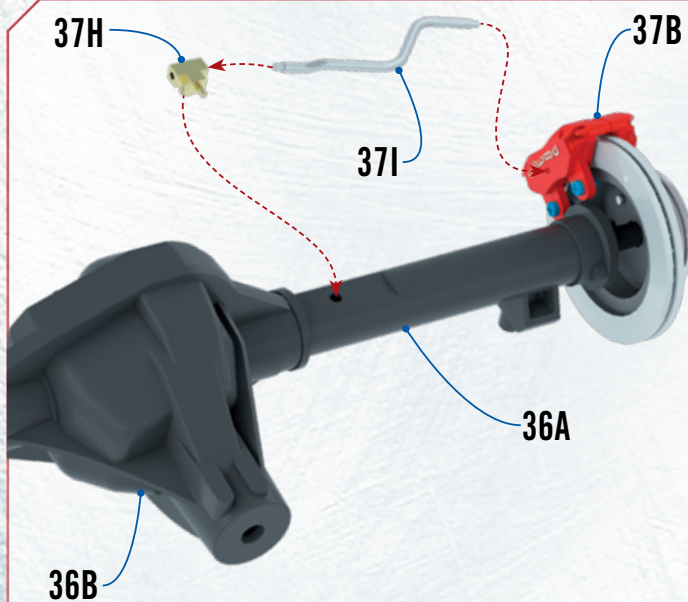

37.7 **INSERT** one end of the left rear brake hose **37I** into the hole in the caliper **37B**. The other end has to be joined to the rear brake hose fitting **37H**. Insert the linchpin on the fitting into the hole in the left side of the rear axle **36A**, next to the differential **36B**. ◀

37.8 **ON THE RIGHT SIDE** of the axle, insert one end of the right rear brake hose **37J** into the hole in the caliper **37D**, and the other end into the fitting **37H**, as shown in the illustration. ▶

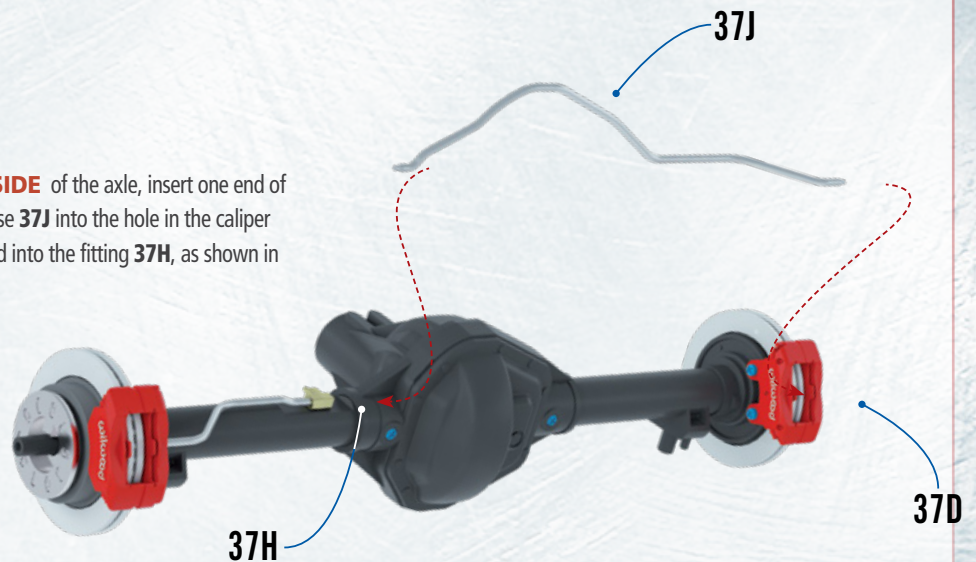

STAGE 37 FINAL RESULT



◀ You have now installed the two completed brake discs on the rear axle, to which you have also connected the hoses.

LEFT REAR LEAF SPRING

STAGE

38

In this assembly session you will assemble part of the left rear suspension, preparing the leaf spring that will subsequently be attached to the chassis.

PIECES FOR THIS STAGE

38A



38B



38C



38D



38E



38F



AM



FM



OM



38A Left rear leaf spring

38B Front leaf spring mounting bracket

38C Front reinforcement plate

38D Leaf spring shackle 1

38E Leaf spring shackle 2

38F Rear reinforcement plate

AM Screws 2x4 mm (x 3)*

FM Screws 2x5 mm (x 3)*

OM Screws 3x11 mm (x 3)*

* Some of the parts are spares.



REAR SUSPENSION

These items are not toys; keep out of reach of children. The product is part of an assembly kit intended for an adult audience. Assemble with the utmost care following the instructions in the attached manual; modifications or tampering are prohibited. Made in China. Read and keep for further reference.



AN OVERVIEW

In this illustration you can see the mechanism of the right rear leaf spring (in green).

The other parts of the suspension system, brakes, axle and rear axle transmission are highlighted in red.

The Dodge Charger had a type of rear suspension system called "rigid axle." This is when the axle rests on the leaf springs, which act as a spring to counteract oscillations caused by rough road surfaces. The suspension system is completed with shock absorbers, which ensure that the wheels remain in contact with the road surface.

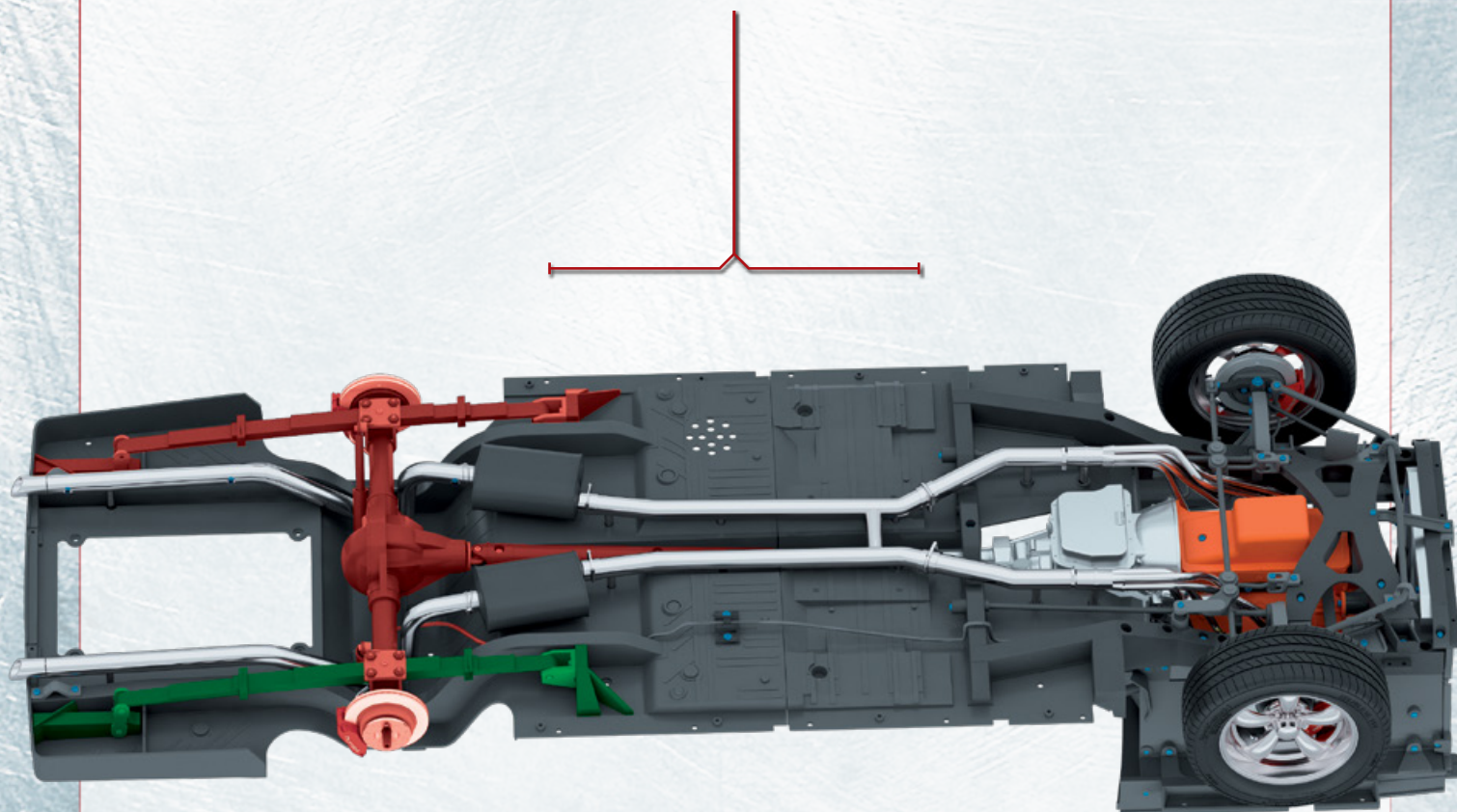



38.1 **ALIGN** the smallest hole in the leaf spring shackle **38D** with the corresponding hole in the rear reinforcement plate **38F**. Secure the pieces with a type **AM** screw. ▼

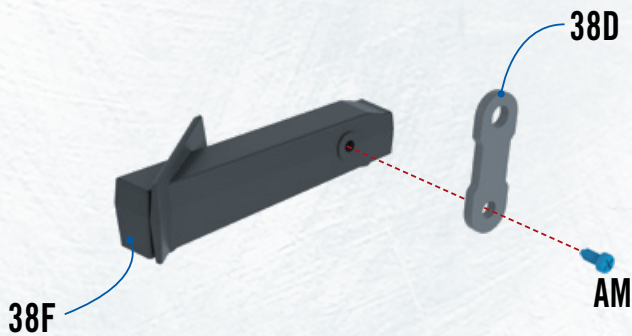

38.2 **IN THE SAME WAY**, align the smaller hole in the shackle **2 38E** with the hole on the other side of the rear reinforcement plate **38F**. Again, secure the pieces with a type **AM** screw. ▼

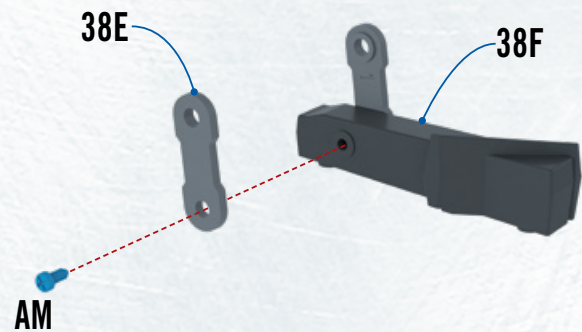

38.3 **INSERT** the rear end of the left rear leaf spring **38A** between the two shackles **38D** and **38E**. Insert a type **OM** screw through the shackle **1**. ►

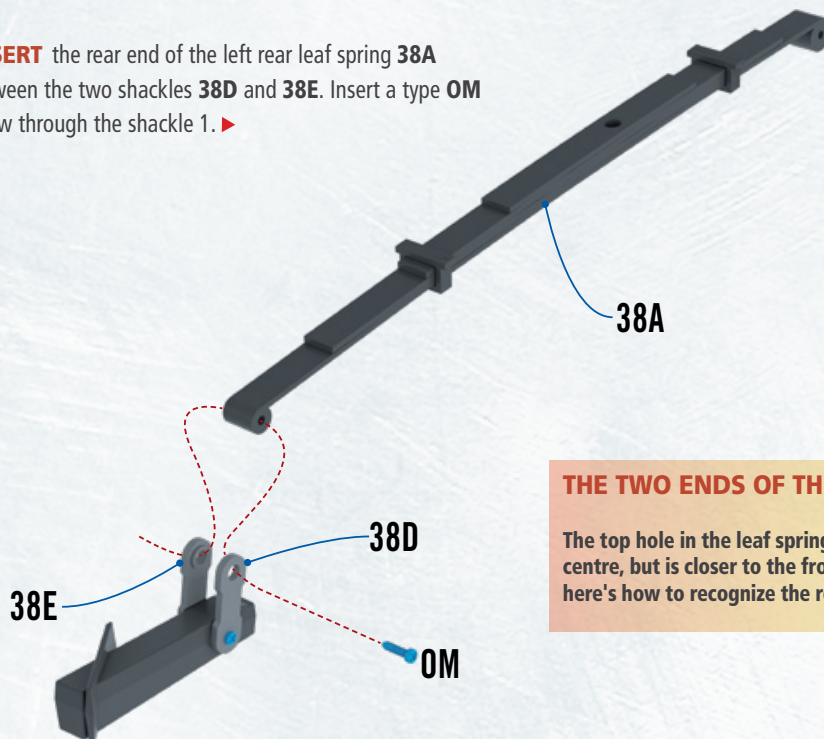

THE TWO ENDS OF THE LEAF SPRING

The top hole in the leaf spring is not exactly in the centre, but is closer to the front end of the piece: here's how to recognize the rear end.

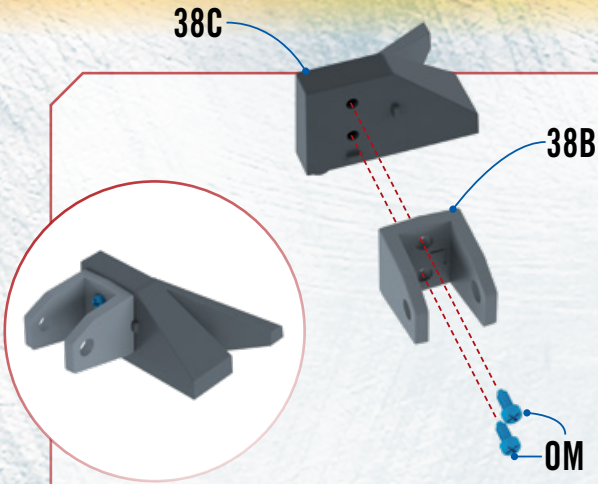

38.4 **ALIGN** the front leaf spring mounting bracket **38B** with the holes in the front reinforcement plate **38C**, which you can distinguish from the illustration. Secure with two type **FM** screws. ◀

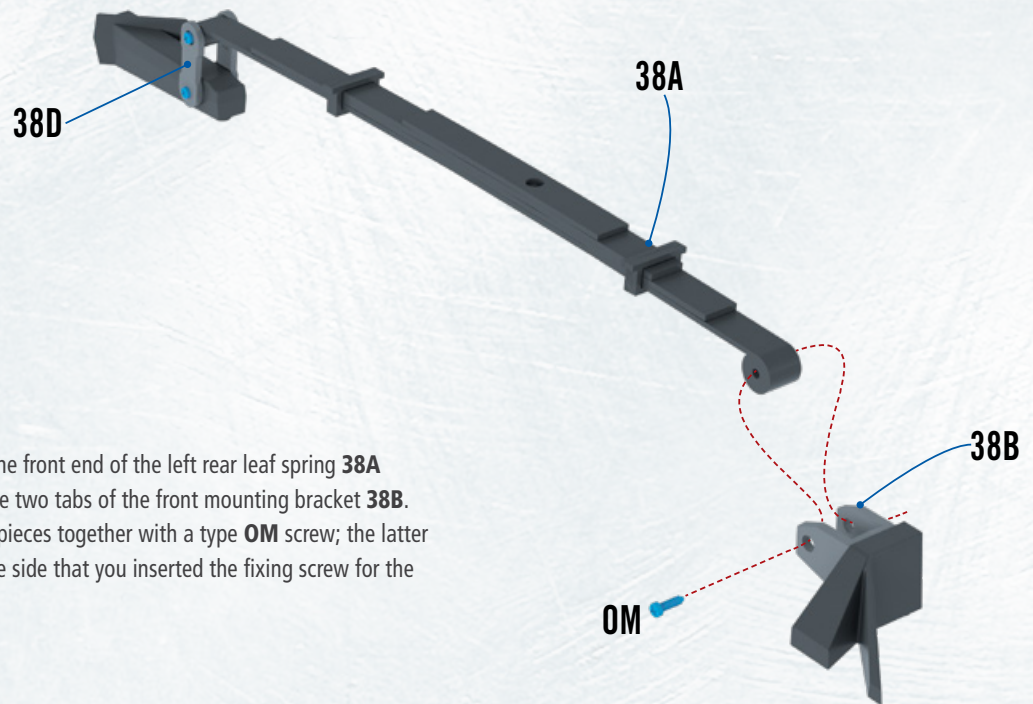

38.5 **INSERT** the front end of the left rear leaf spring **38A** between the two tabs of the front mounting bracket **38B**. Secure the pieces together with a type **OM** screw; the latter must be inserted from the same side that you inserted the fixing screw for the rear end of the leaf spring. ▶

STAGE 38 FINAL RESULT



◀ You have now prepared the left rear leaf spring, which will subsequently be installed on your model car.

RIGHT REAR LEAF SPRING

STAGE

39

In this assembly session you will assemble part of the right rear suspension, preparing the leaf spring that will subsequently be attached to the chassis.

PIECES FOR THIS STAGE

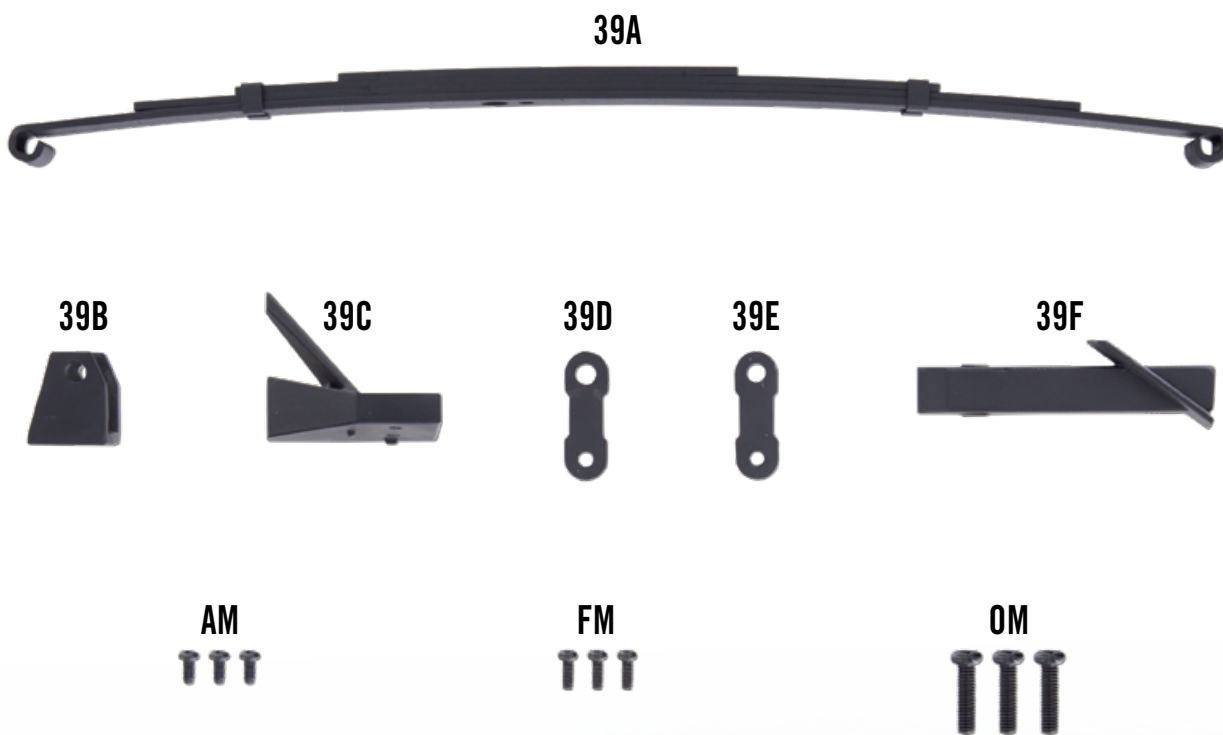

39A Right rear leaf spring

39B Rear leaf spring mounting bracket

39C Front reinforcement plate

39D Leaf spring shackle 1

39E Leaf spring shackle 2

39F Rear reinforcement plate

AM Screws 2x4 mm (x 3)*

FM Screws 2x5 mm (x 3)*

OM Screws 3x11 mm (x 3)*

* Some of the parts are spares.



REAR SUSPENSION

These items are not toys; keep out of reach of children. The product is part of an assembly kit intended for an adult audience. Assemble with the utmost care following the instructions in the attached manual; modifications or tampering are prohibited. Made in China. Read and keep for further reference.



AN OVERVIEW

This illustration shows a detail of the chassis of your Dodge Charger R / T; the right leaf spring, highlighted in green, is what you will be preparing during this work session. In red, you can see the left rear leaf spring, which you have already assembled.

Generally, the leaf springs in a suspension system are composed of numerous steel plates, which decrease in length.

The two eyes at each end of the longer blade are attached to the vehicle. This type of suspension is common on heavy vehicles, off-road vehicles and muscle cars. In the latter case, it was customary to use these suspensions longitudinally or transversely on the rear bridge, where they offered more advantages than coil springs.

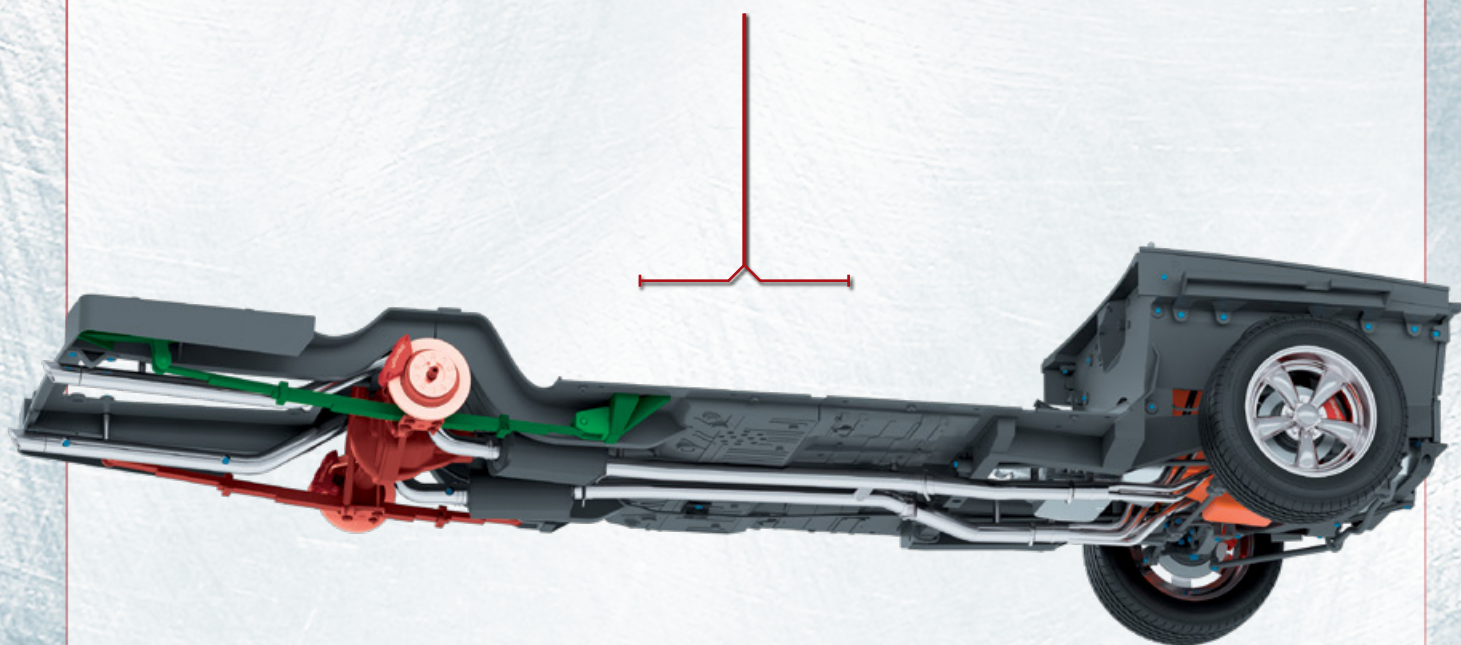



39.1 **ALIGN** the smallest hole in the leaf spring shackle 1 **39D** with the corresponding hole in the rear reinforcement plate **39F**. Secure the pieces with a type **AM** screw. ▼

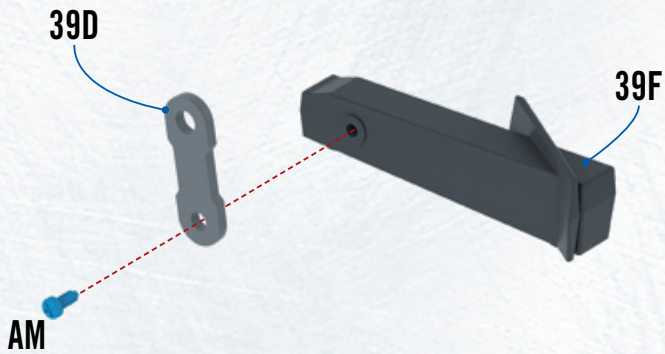

39.2 **IN THE SAME WAY**, align the smallest hole in the shackle 2 **39E** with the hole on the other side of the rear reinforcement plate **39F**. Again, secure with a type **AM** screw. ►

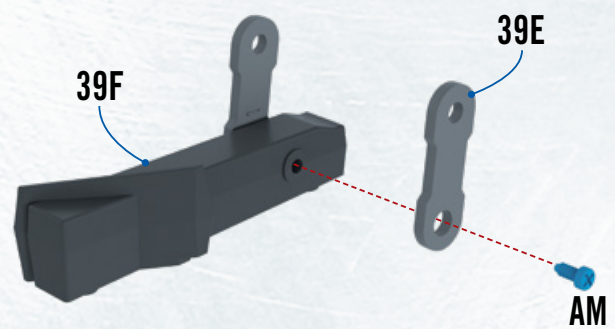

39.3 **INSERT** the rear end of the left rear leaf spring **39A** between the two shackles **39D** and **39E**. Insert a type **OM** screw through the shackle 1. ►

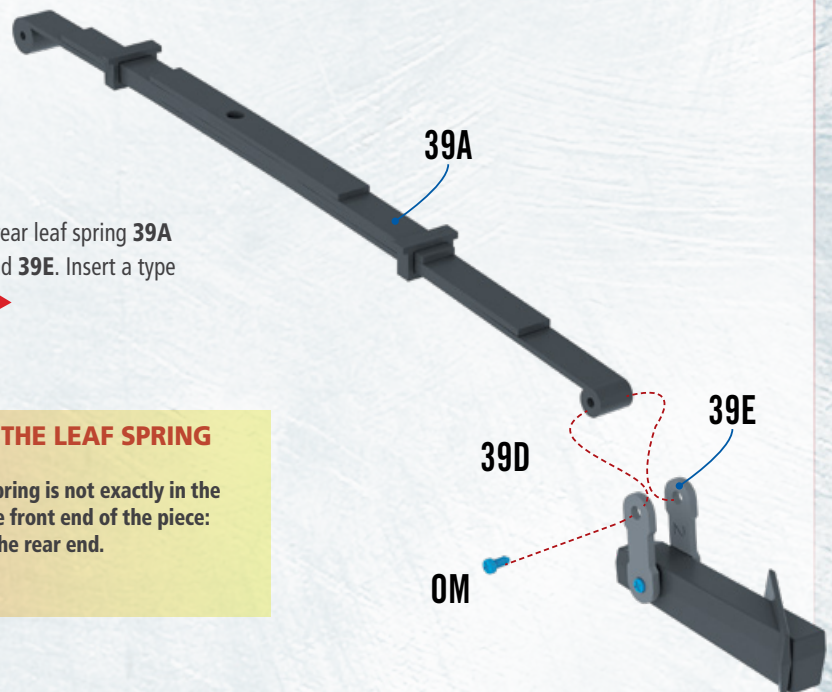

THE TWO ENDS OF THE LEAF SPRING

The top hole in the leaf spring is not exactly in the centre, but is closer to the front end of the piece: here's how to recognize the rear end.

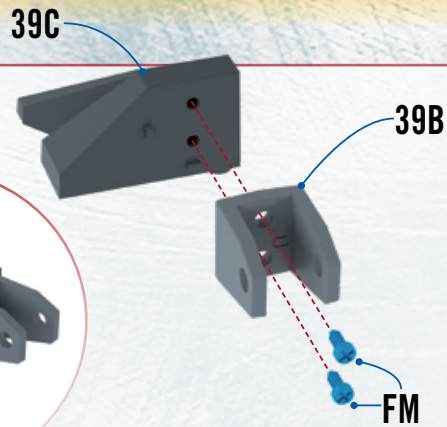

39.4 **ALIGN** the front leaf spring mounting bracket **39B** with the holes in the front reinforcement plate **39C**, which you can distinguish from the illustration. Secure with two type **FM** screws. ◀

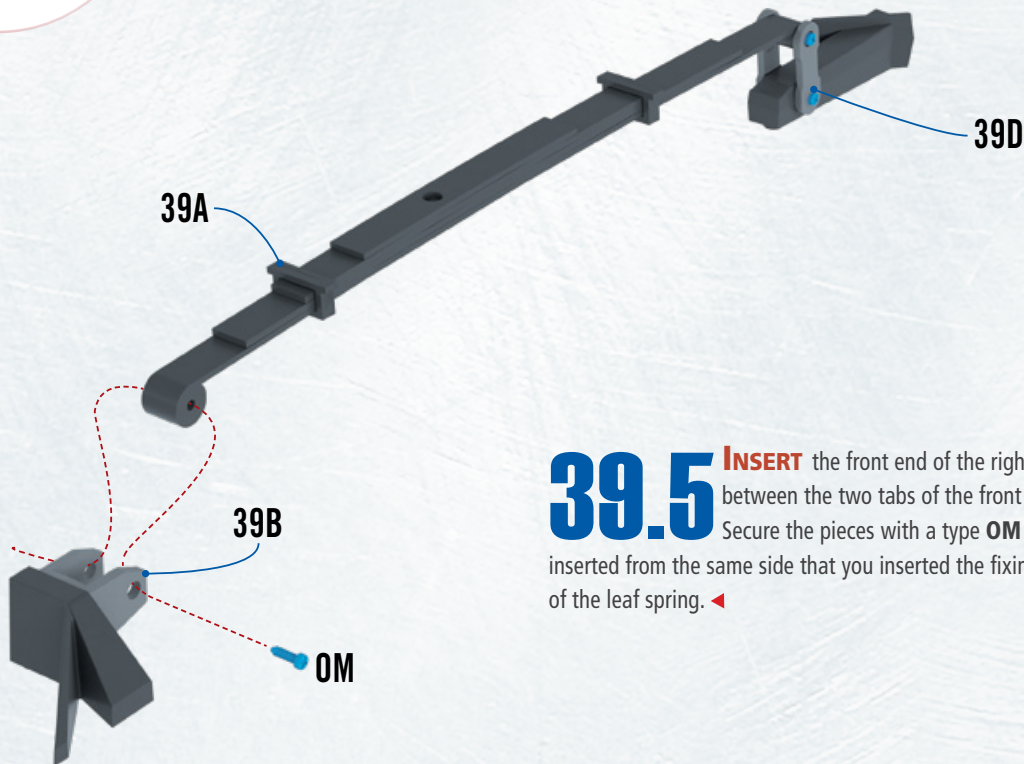

39.5 **INSERT** the front end of the right rear leaf spring **39A** between the two tabs of the front mounting bracket **39B**. Secure the pieces with a type **OM** screw; the latter must be inserted from the same side that you inserted the fixing screw for the rear end of the leaf spring. ◀

STAGE 39 FINAL RESULT



◀ You have now prepared right rear leaf spring, which will subsequently be installed on your model car.

ATTACHING THE LEAF SPRINGS TO THE AXLE

STAGE

40

In this assembly session you will assemble part of the right rear suspension, preparing the leaf spring that will subsequently be attached to the chassis.

PIECES FOR THIS STAGE

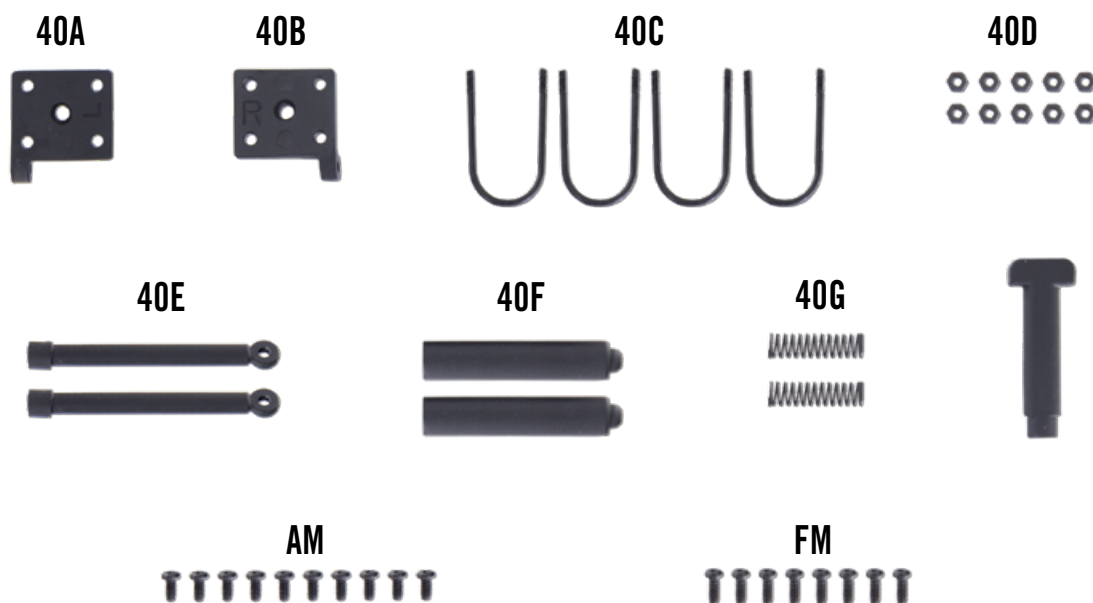

40A Left leaf spring plate

40B Right leaf spring plate

40C U hooks (x 4)

40D Hex nuts (x 10)

40E Rear shock absorber rods (x 2)

40F Rear shock absorber cylinders (x 2)

40G Rear shock absorber springs (x 2)

Hex key

AM Screws 2x4 mm (x 10)*

FM Screws 2x5 mm (x 8)*

* Some of the parts are spares.



REAR AXLE

ASSISTENZA
AL MONTAGGIO

These items are not toys; keep out of reach of children. The product is part of an assembly kit intended for an adult audience. Assemble with the utmost care following the instructions in the attached manual; modifications or tampering are prohibited. Made in China. Read and keep for further reference.



40.1 **WITH** the pieces facing the same way as those in the illustration, align the eye on one of the shock absorber rods **40E** with the corresponding eye on the left leaf spring plate **40A** (marked with a letter "L"). Join the pieces with a type **AM** screw. ▶

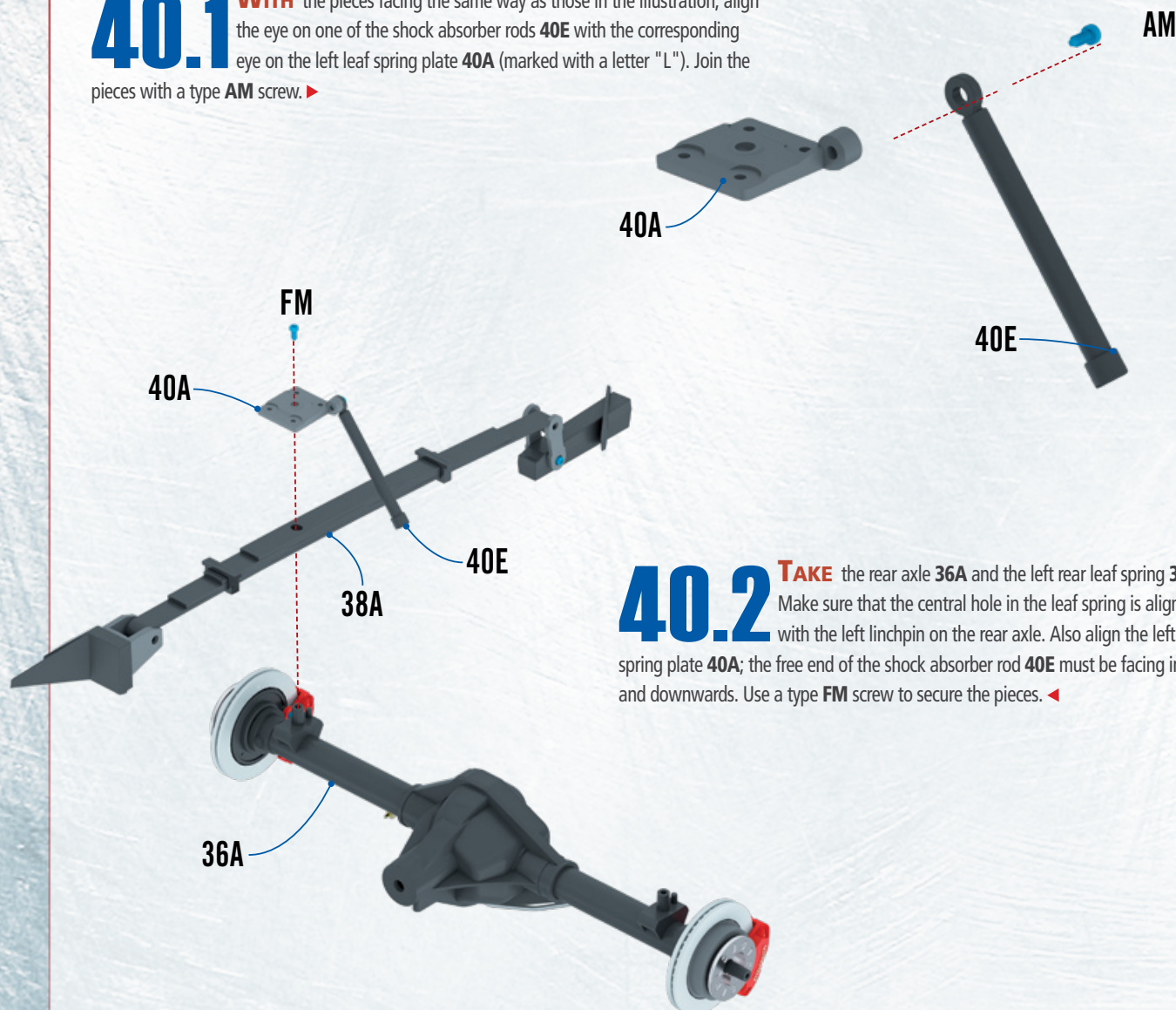

40.2 **TAKE** the rear axle **36A** and the left rear leaf spring **38A**. Make sure that the central hole in the leaf spring is aligned with the left linchpin on the rear axle. Also align the left leaf spring plate **40A**; the free end of the shock absorber rod **40E** must be facing inwards and downwards. Use a type **FM** screw to secure the pieces. ◀

40.3 **SLIDE** two U hooks **40C** onto the axle from underneath. The ends of the hooks must enter the corresponding holes in the left leaf spring plate **40A**. ▶

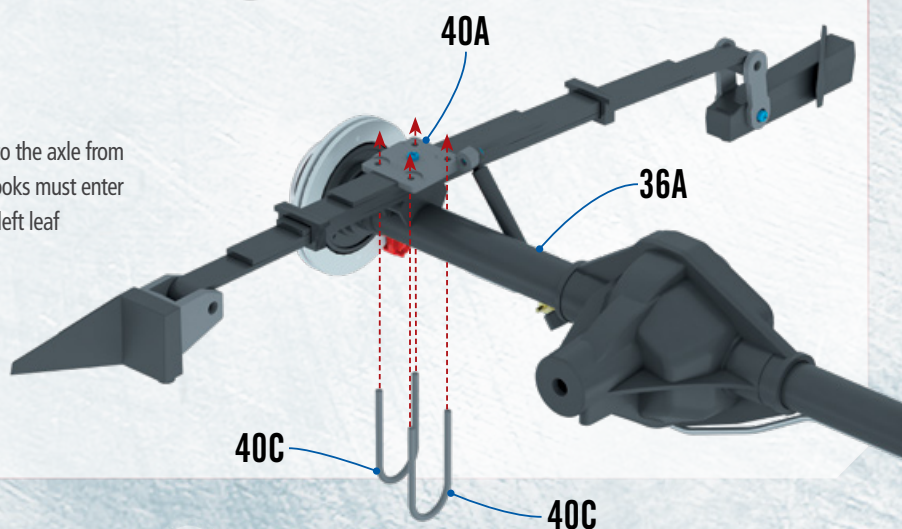

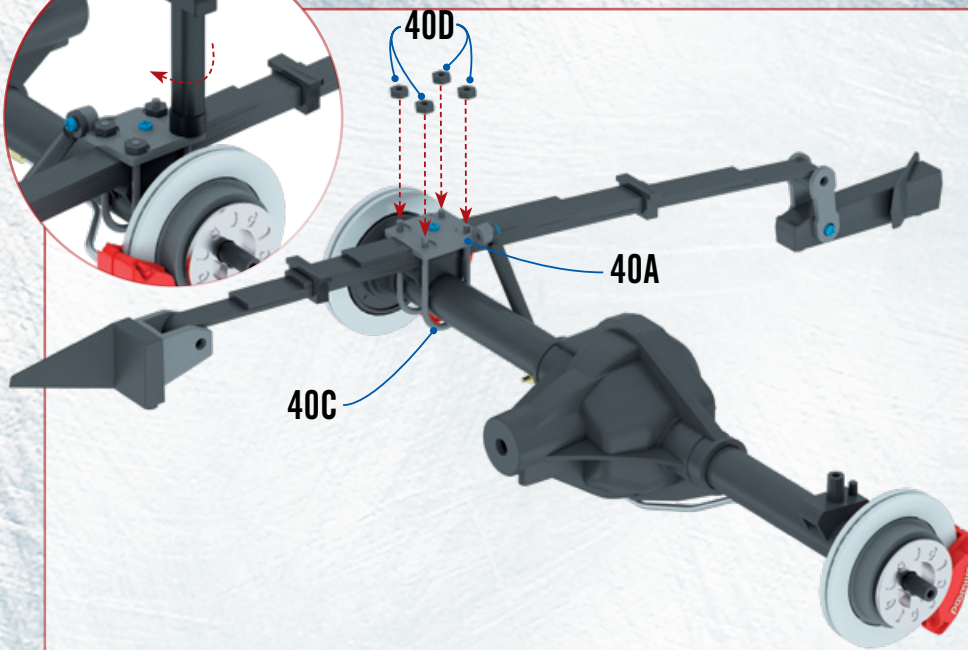

40.4 **PUT** a hex nut **40D** onto all the ends of the U hooks. Tighten the nuts using the hex key that was provided with this stage. ◀

40.5 **ATTACH** the second shock absorber rod **40E** to the right leaf spring plate **40B** in the same way, using a type **AM** screw. ▶

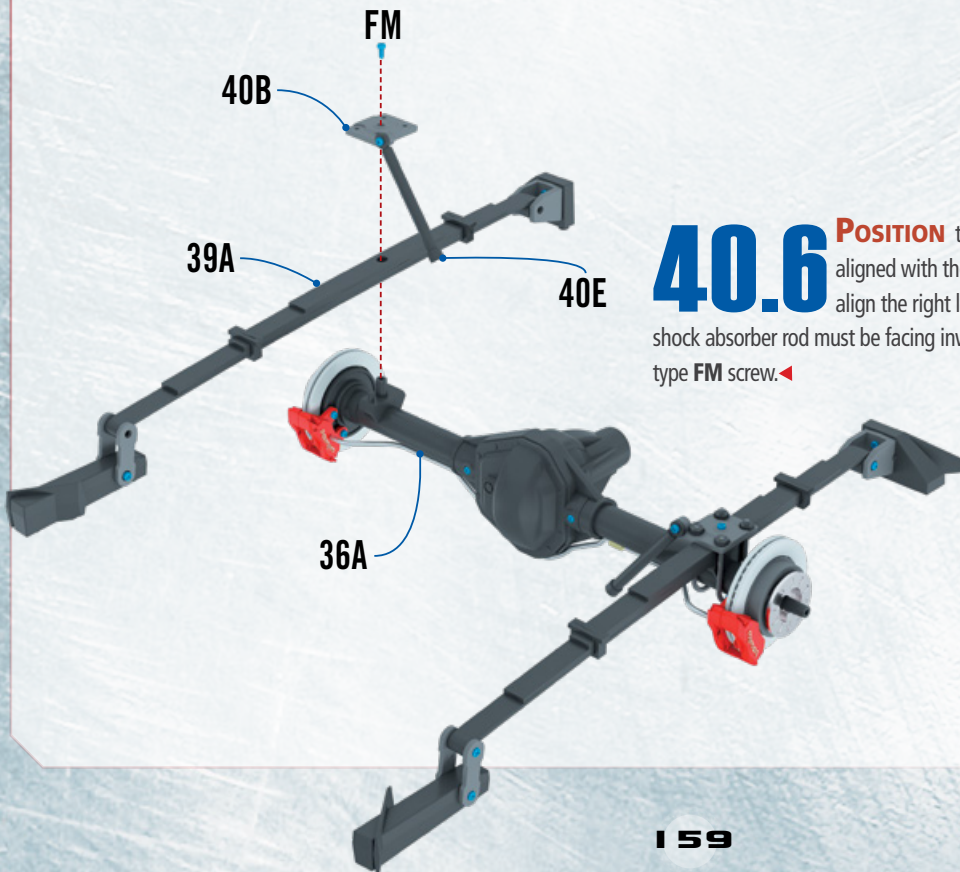
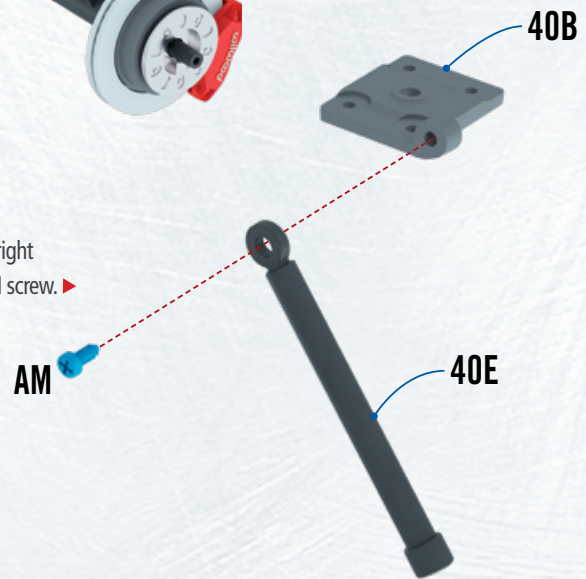

40.6 **POSITION** the right leaf spring so that the central hole is aligned with the right linchpin on the rear axle **36A**. Also align the right leaf spring plate **40B** with the same hole (the shock absorber rod must be facing inwards and downwards). Join the pieces with a type **FM** screw. ◀

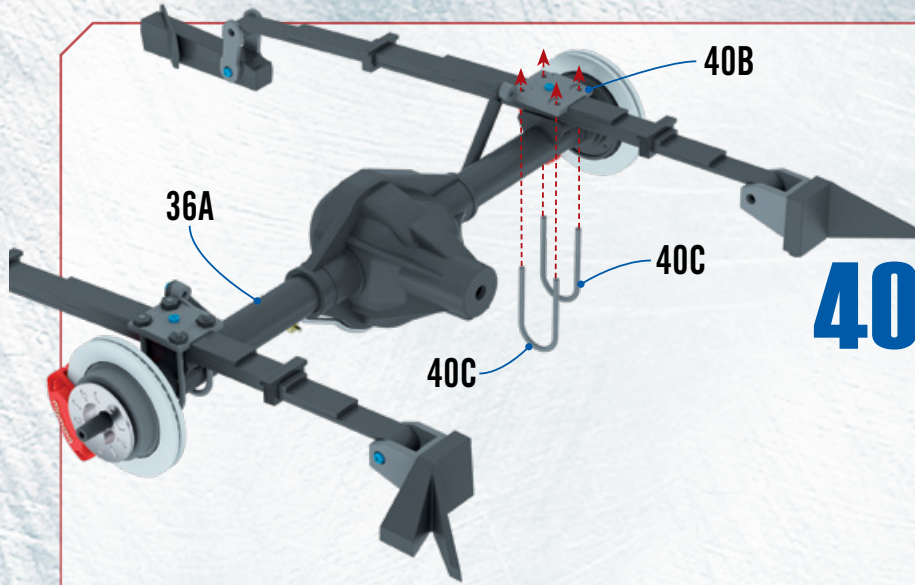

40.7 **SLIDE** two U hooks **40C** onto the axle from underneath, making sure that the ends enter the corresponding holes in the plate **40B**. ◀

40.8 **PUT** a hex nut **40D** onto all the ends of the U hooks. Tighten the nuts using the hex key that was provided. ▶

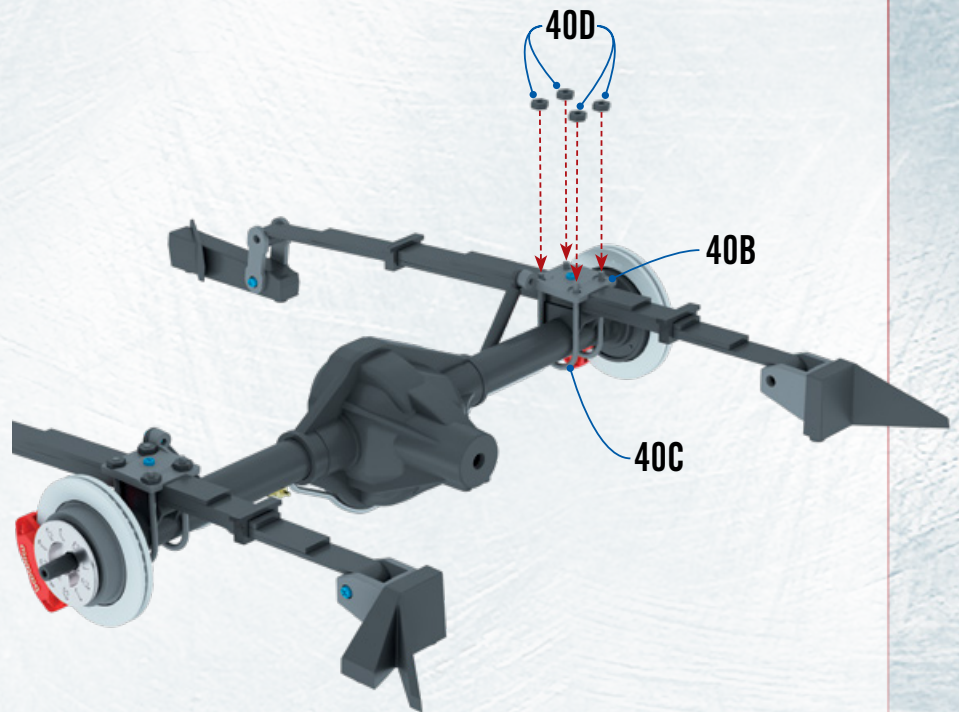

STAGE 40 FINAL RESULT



◀ You have now attached the two leaf springs to the rear axle. Put everything you have assembled in a safe place, along with the shock absorber springs and cylinders, which you will need in a future work session.