

BUILD YOUR OWN

POLSKI FIAT

126p

**Pack
3**



BUILD YOUR OWN

POLSKI FIAT

126p

DEAGOSTINI
MODELSPACE™
www.model-space.com

STAGE

PAGE

11	Engine assembly	37
12	Engine assembly	40
13	Silencer assembly	43
14	The fuel pump	46
15	The chassis	49



Editorial and design by Continuo Creative Ltd, London.
Published in the UK by De Agostini UK Ltd, Royds Withy King, 65 Carter Lane, London EC4V 5EQ.
Published in the USA by De Agostini Publishing USA, Inc., 299 Park Avenue • New York, New York 10171.
All rights reserved © 2019

Warning: Not suitable for children under the age of 14.
This product is not a toy and is not designed or intended for use in play.
Items may vary from those shown.

Stage 11: Engine assembly



Your parts:

- 11A. Joint covers x 2
- 11B. Upper transmission cover
- 11C. Transmission mounting bracket
- 11D. Heater pipe part 1
- 11E. Heater pipe part 2
- 11F. Transmission mounting crossbar
- AM. 1.7 x 3mm screws
- AP. 1.7 x 3mm screws
- BM. 2 x 4mm screws

11A



11E



11B

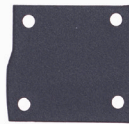

11F



11C



AM



11D



BM



AP



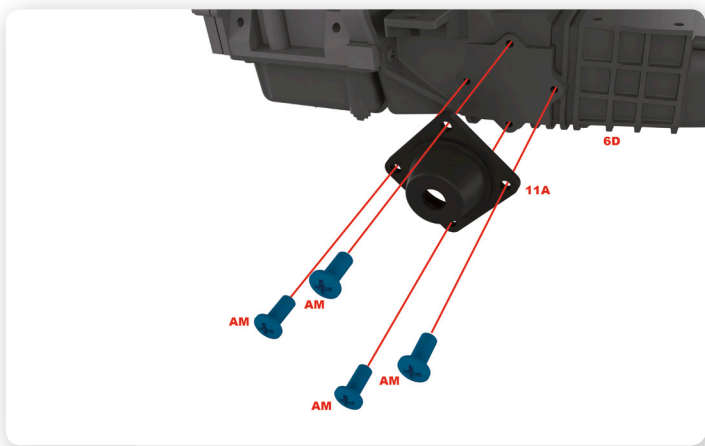

1 Secure one of the two joint covers (11A) to the side of the transmission case with four AM screws.

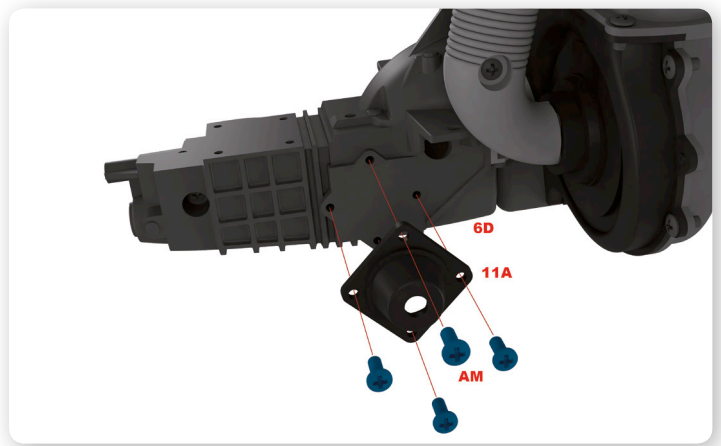

2 Secure the second joint cover (11A) to the other side of the transmission case with four more AM screws.

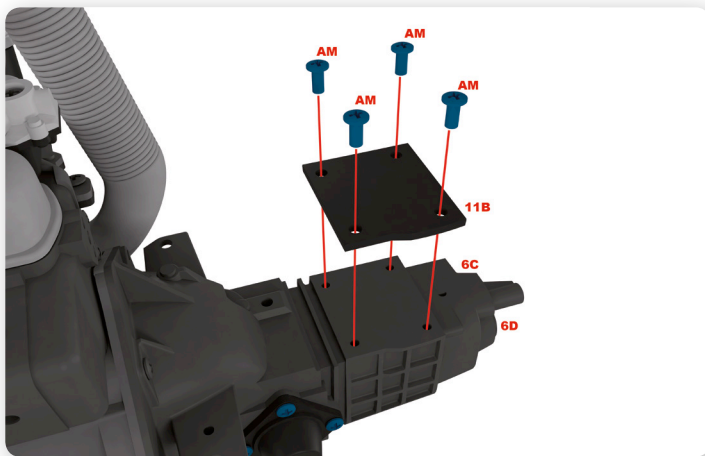

3 Place the upper transmission cover (11B) onto the top of the transmission case, aligning the holes of both parts and secure with four AM screws.

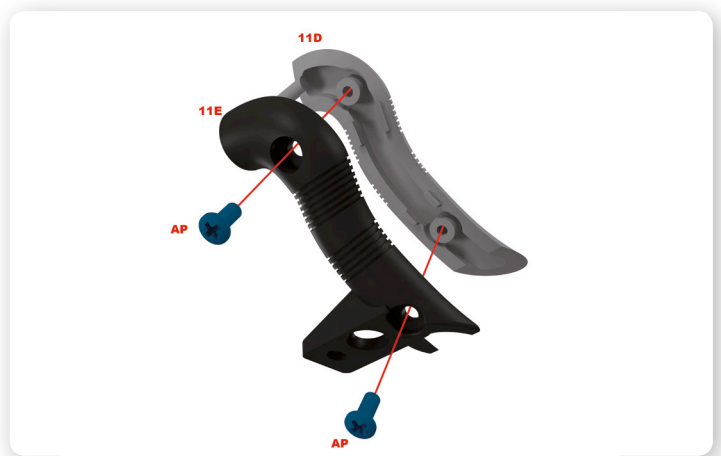

4 Assemble the two parts of the heater pipe (11D, 11E) with two AP screws.



5 Install the heater pipe on the side of the engine, as shown, securing it with an AM screw.

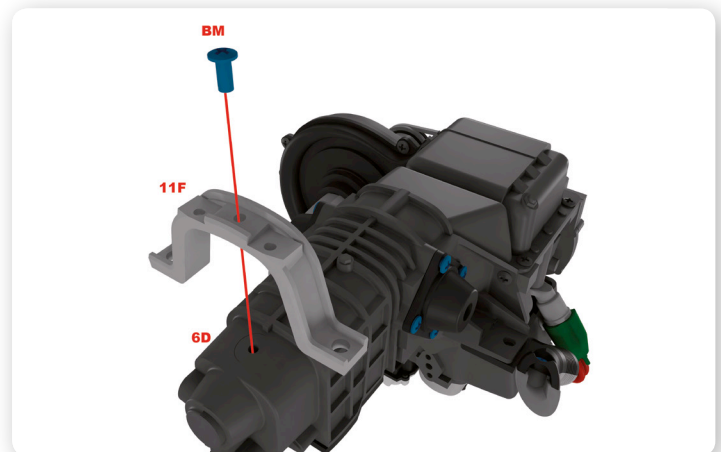

6 Turn the engine block over and fix the transmission mounting crossbar (11E) to the transmission case with a BM screw.

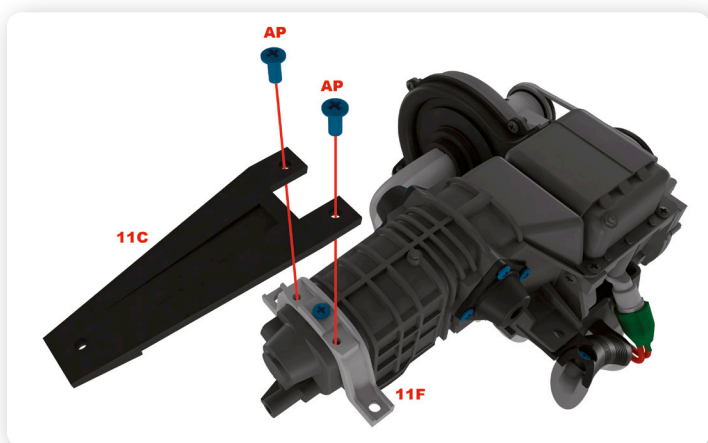

7 Place the transmission mounting bracket (11C) onto the crossbar and secure with two AP screws.



Here is how your assembly should look at the end of this stage. Keep any assemblies, unused parts and spares labelled to one side for later use.



Stage 12: Engine assembly



12A



12E

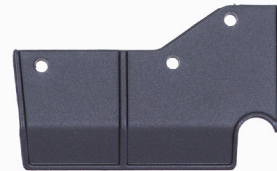

12B



12F

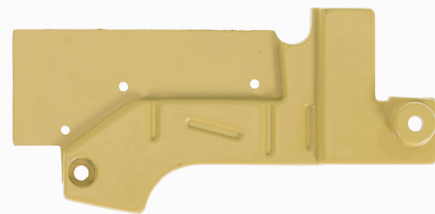

12C



AM



12D



AP



Your parts:

- 12A. Exhaust manifold pipe 1
- 12B. Exhaust manifold 1
- 12C. Exhaust manifold 2
- 12D. Exhaust manifold pipe 2
- 12E. Engine side cover 1
- 12F. Engine side cover 2
- AM. 1.7 x 3mm screws
- AP. 1.7 x 3mm screws

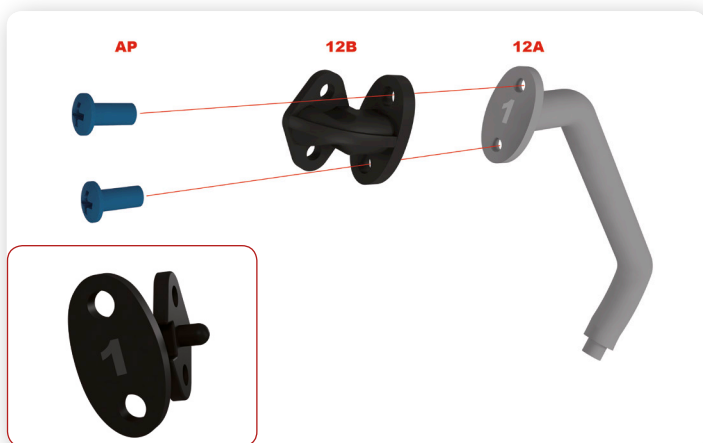

1 Secure exhaust manifold 1 (12B) to exhaust manifold pipe 1 (12A) with two AP screws. Both parts are labelled 1.

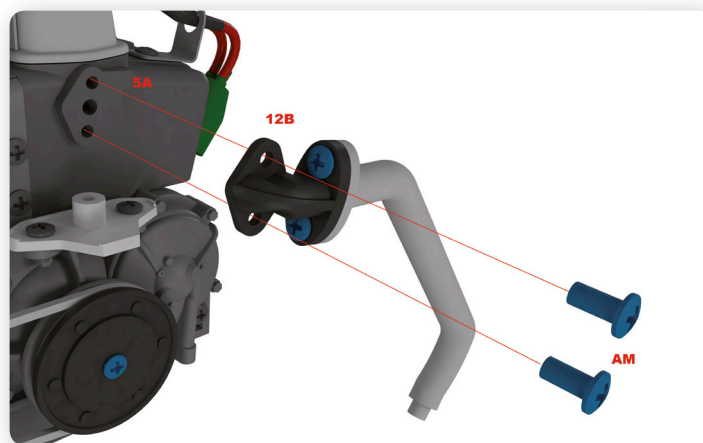

2 Fix the assembly to the side of the engine block with two AM screws.

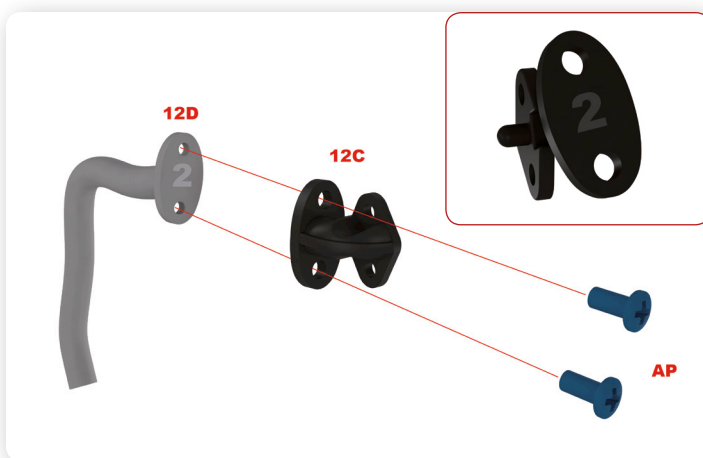

3 Connect exhaust manifold pipe 2 (12D) to exhaust manifold 2 (12C) with two AP screws. Both parts are labelled 2.

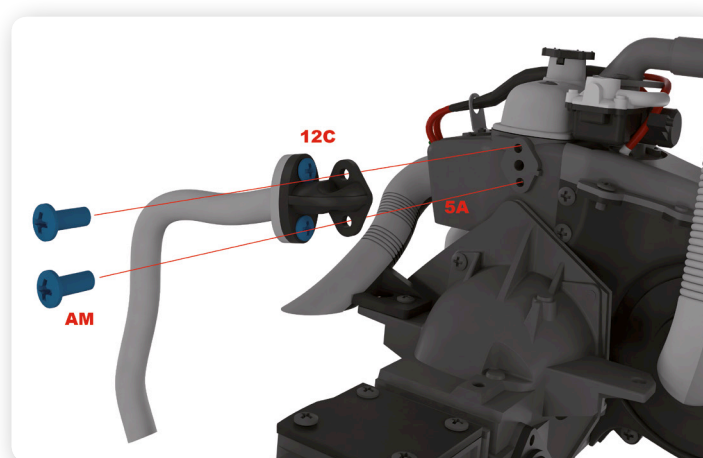

4 Fix the assembly to the side of the engine block with two AM screws.

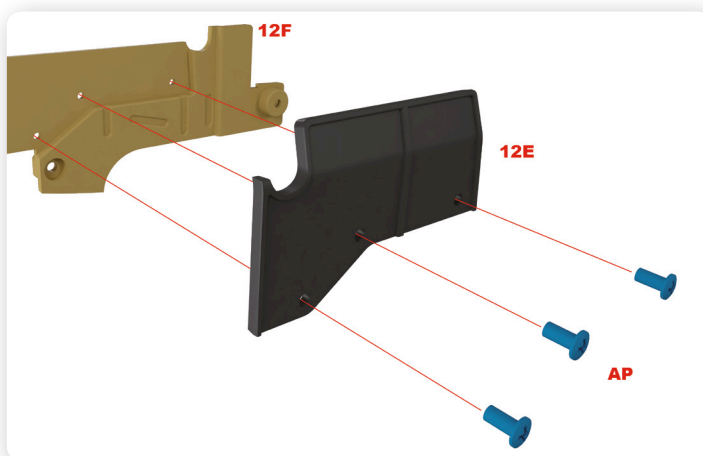

5 Secure the two engine side covers (12E and 12F) together with three AP screws (AP).



Here is how your assembly should look at the end of this stage. Keep any assemblies, unused parts and spares labelled to one side for later use.

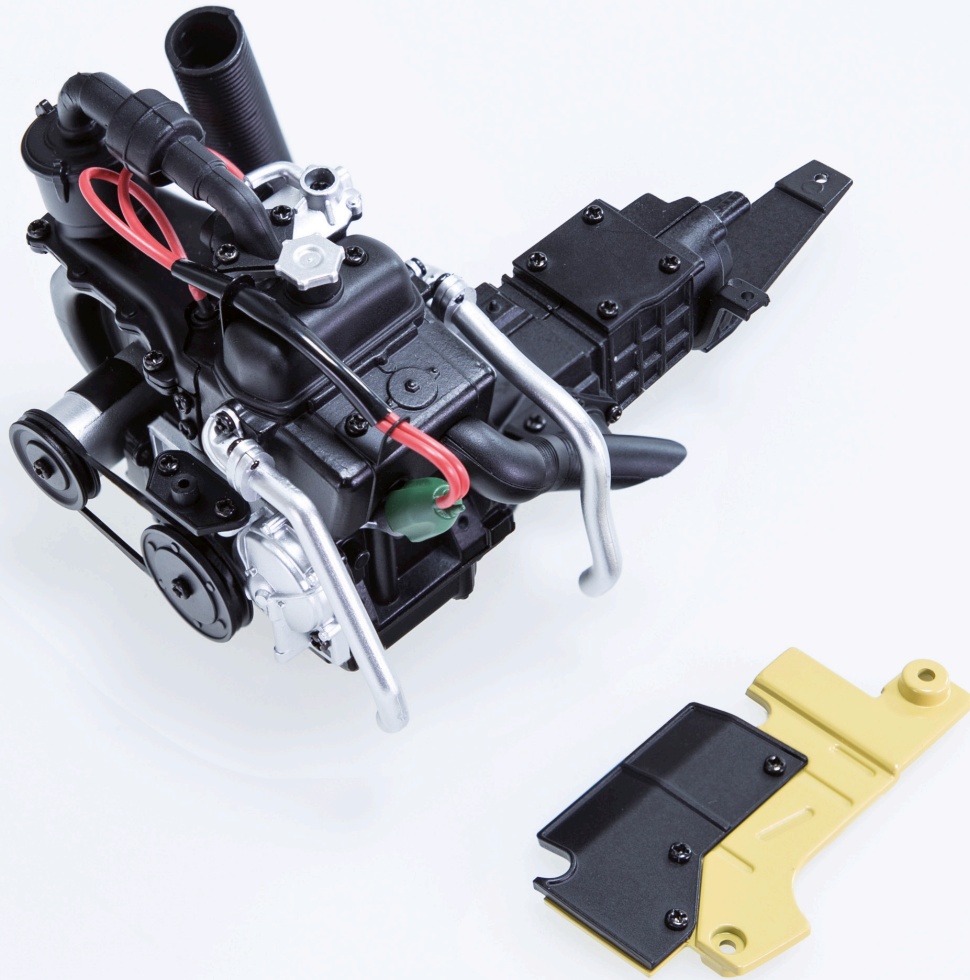

Stage 13: Silencer assembly



13A



13D



13B



13E



13C

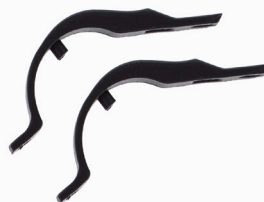

AP



DP



Your parts:

- 13A. Silencer part 1
- 13B. Silencer part 2
- 13C. Silencer brackets 1
- 13D. Silencer brackets 2
- 13E. Exhaust pipe
- AP. 1.7 x 3mm screws
- DP. 1.7 x 5mm screws



1 Fix the exhaust pipe (13E) to the inside of silencer part 2 (13B) with a DP screw.

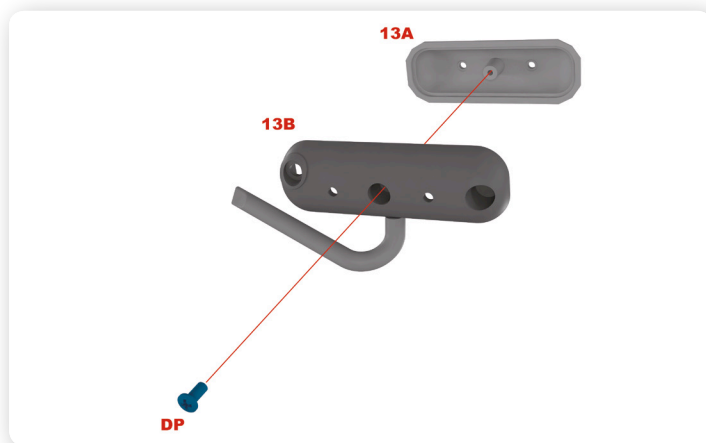

2 Secure silencer part 1 (13A) to the assembly with a DP screw.

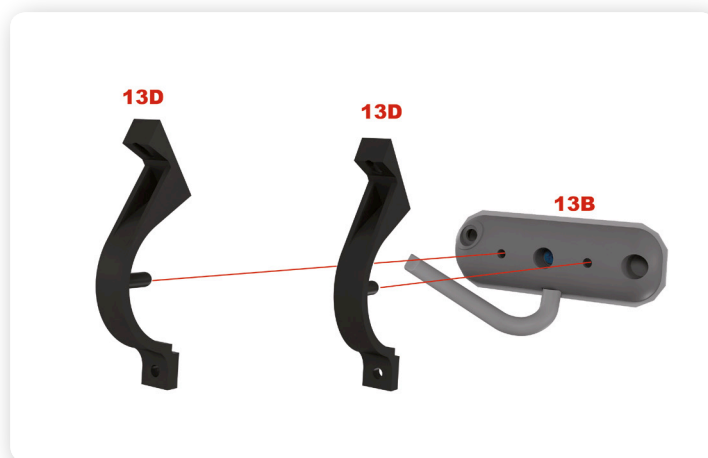

3 Insert the two silencer brackets 2 (13D) into the indicated holes in silencer part 2, as shown.

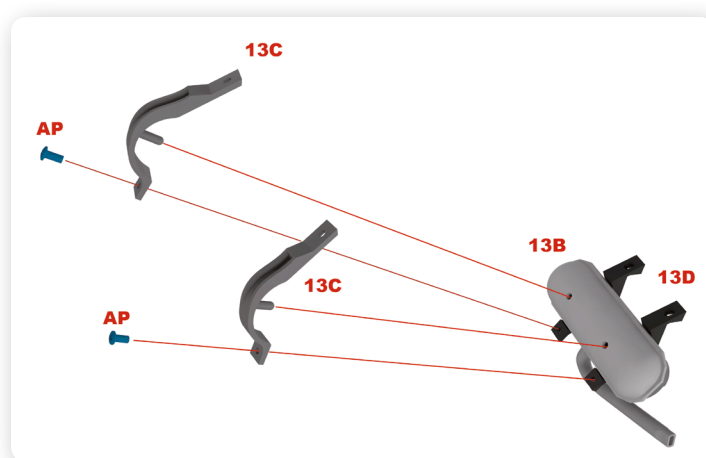

4 Fit the two silencer brackets 1 (13C) into the holes on the other side of the silencer.



Here is how your assembly should look at the end of this stage. Keep any assemblies, unused parts and spares labelled to one side for later use.

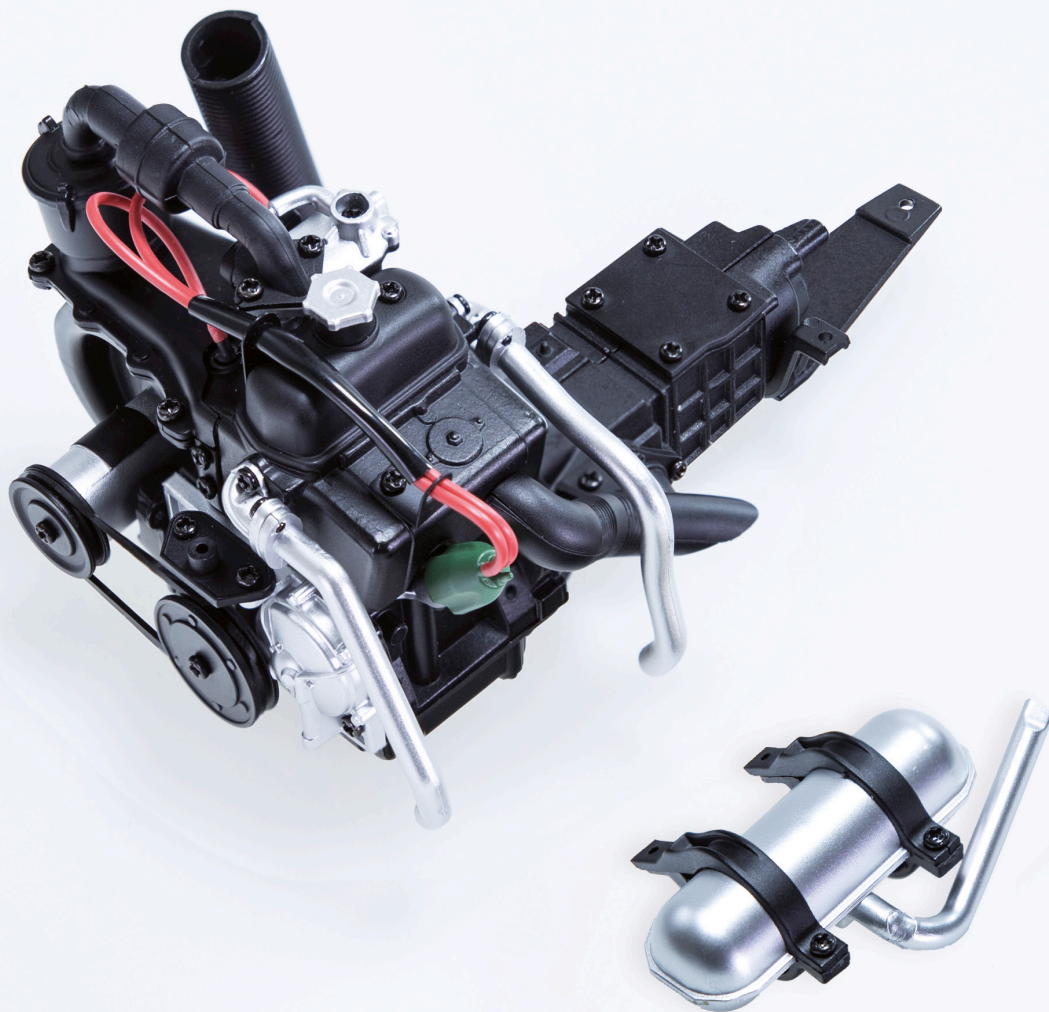

Stage 14: The fuel pump



Your parts:

- 14A. Fuel line 1
- 14B. Fuel filter
- 14C. Fuel line 2
- 14D. Fuel pump
- 14E. Fuel pump top
- 14F. Fuel line 3
- 14G. Cover
- AM. 1.7 x 3mm screws

14A



14B



14C



14D



14E



14F



14G



AM





1 Insert the fuel pump top (14E) into the fuel pump (14D).

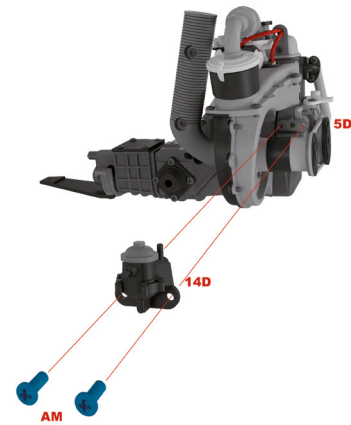

2 Secure the fuel pump to the side of the engine with two AM screws, as shown.

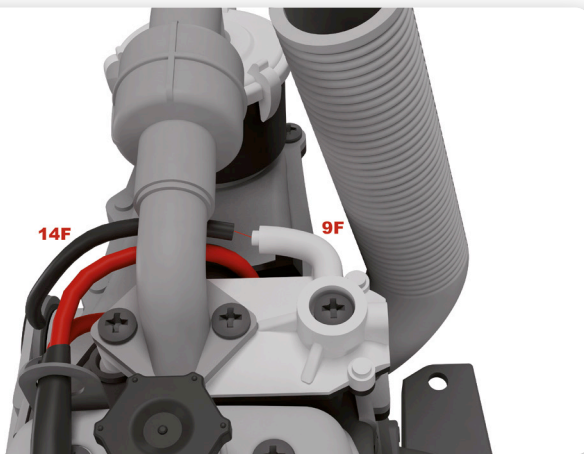

3 Fit fuel line 3 (14F) onto the end of the carburettor.

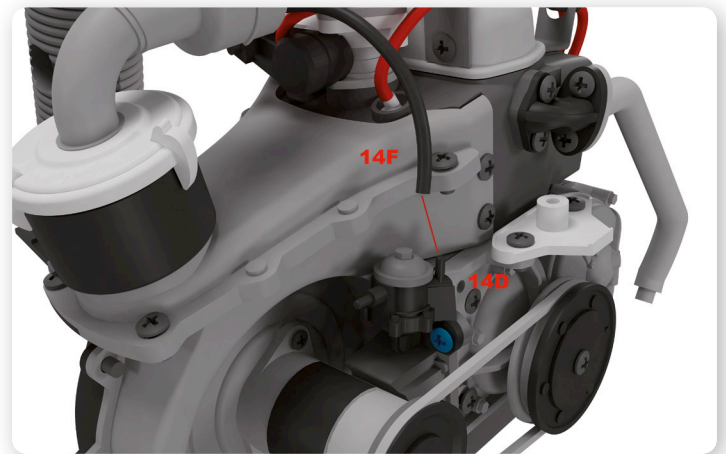

4 Fit the other end of fuel line 3 to the top of the fuel pump.

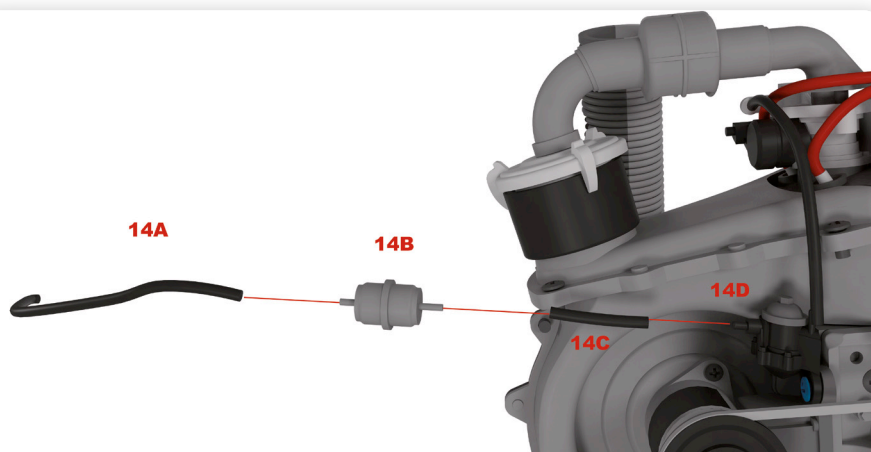

5 Connect fuel line 1 (14A) to the fuel filter (14B). Then connect fuel line 2 (14C) between the filter and pump, as shown.

Here is how your assembly should look at the end of this stage. Keep any assemblies, unused parts and spares labelled to one side for later use.

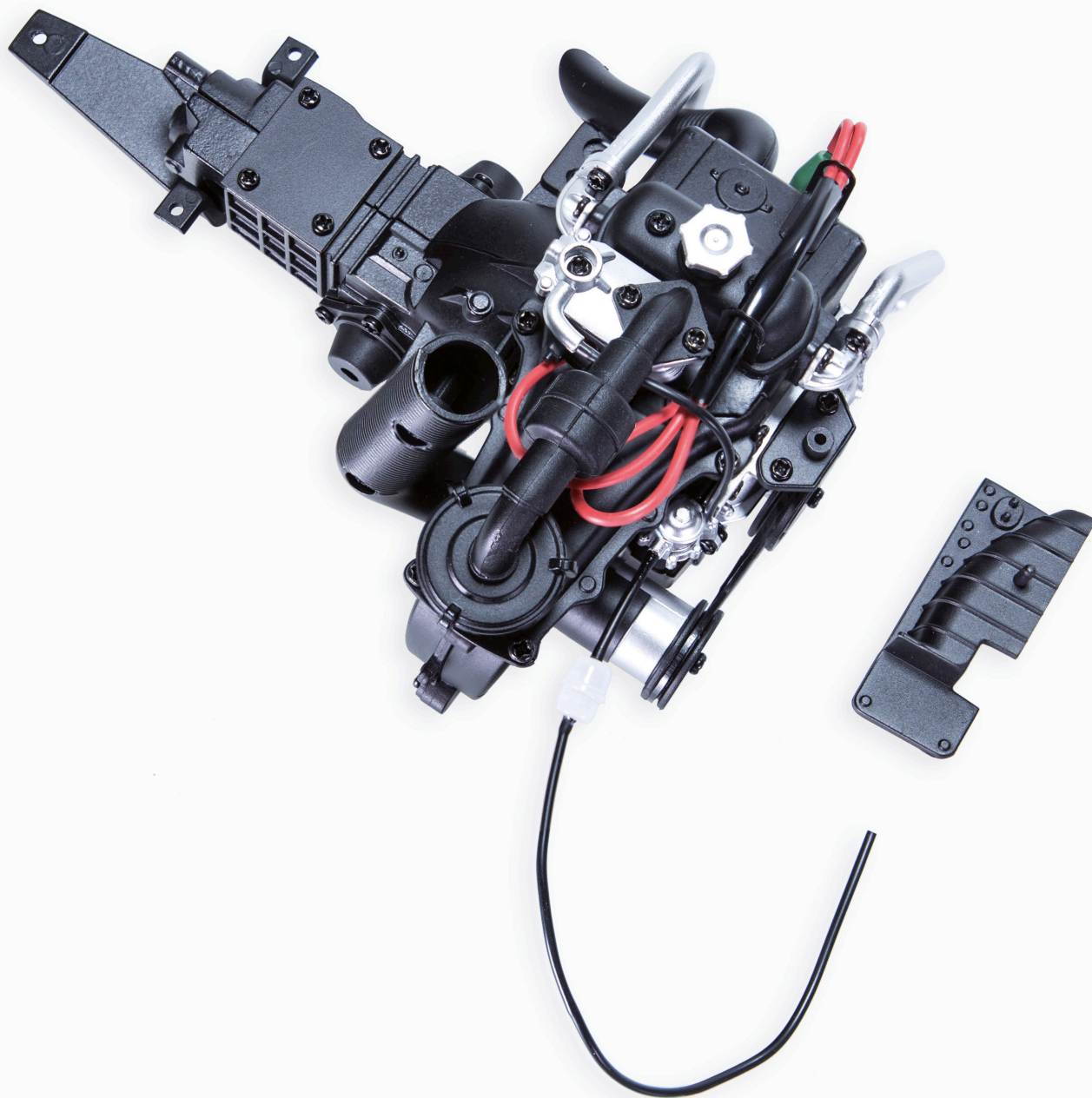

Stage 15: The chassis

Your parts:

15A. Chassis

BM. 2 x 4mm screws

IM. 1.7 x 5mm screws

CP. 1.7 x 4mm screws



15A

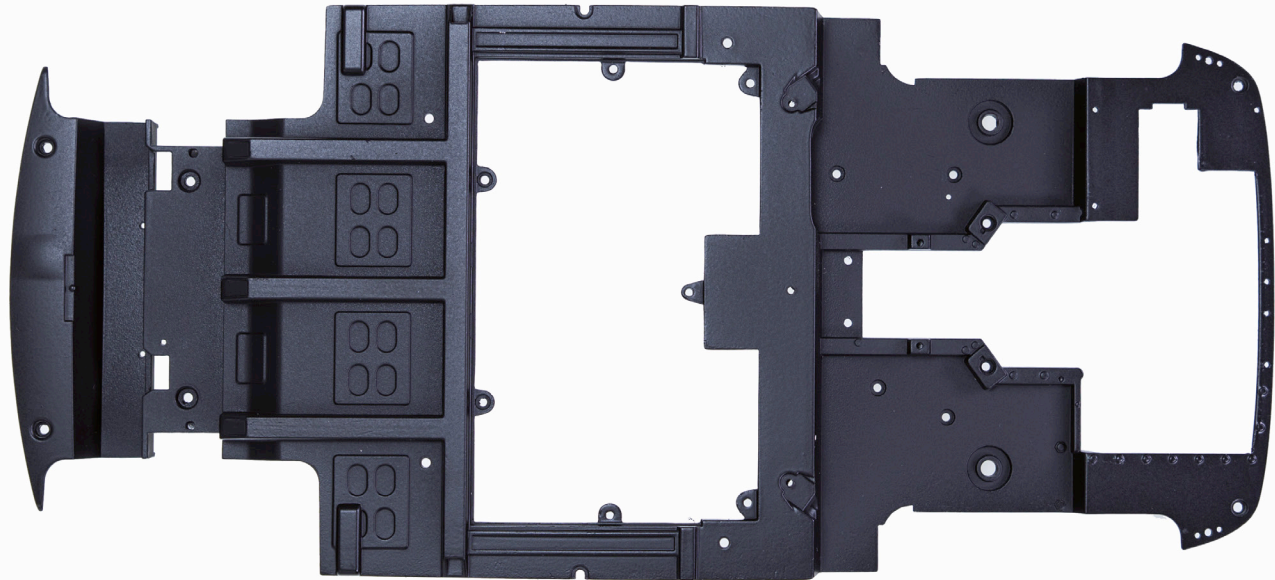

BM



IM



CP



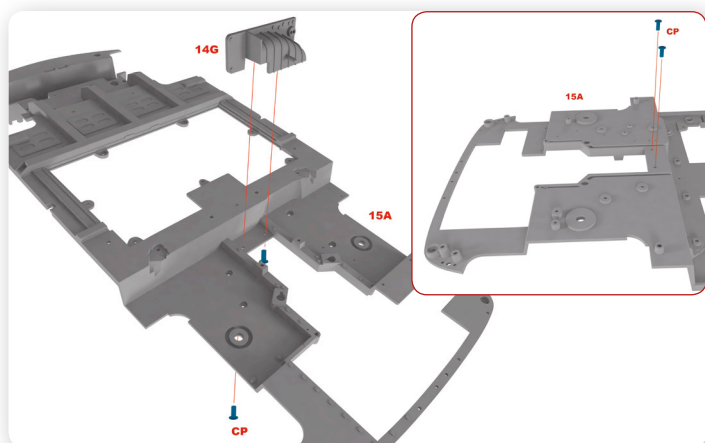

1 Fix the cover (14G) to the chassis with two CP screws from below.

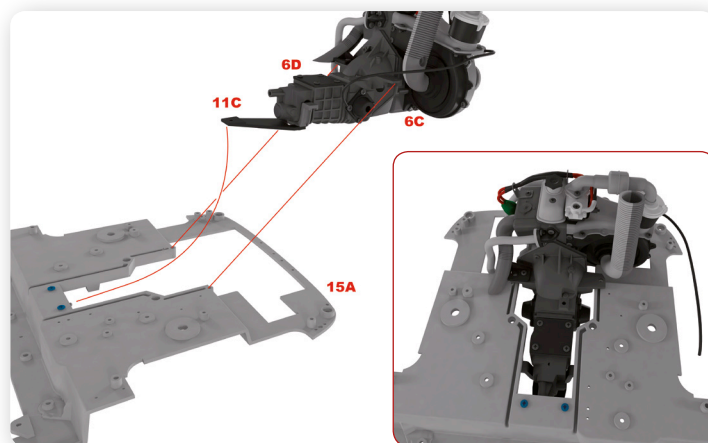

2 Turn the chassis over and place the engine block in the opening, as shown.

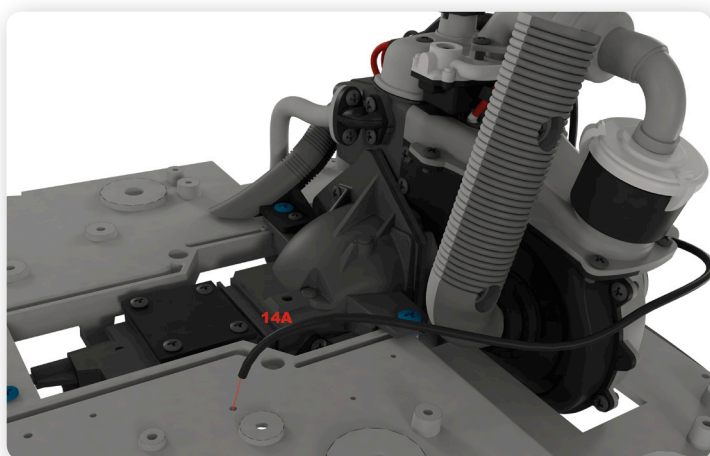

3 Insert the free end of fuel pipe 1 into the indicated hole in the chassis.

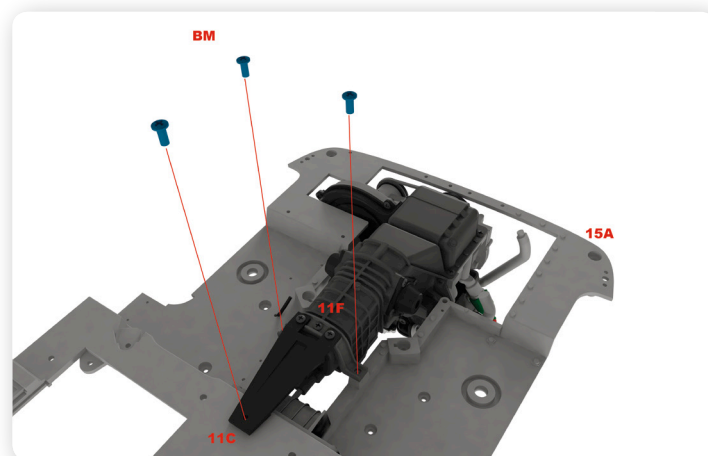

4 Hold the engine block in place and turn the chassis over. Secure the engine to the chassis with three BM screws.

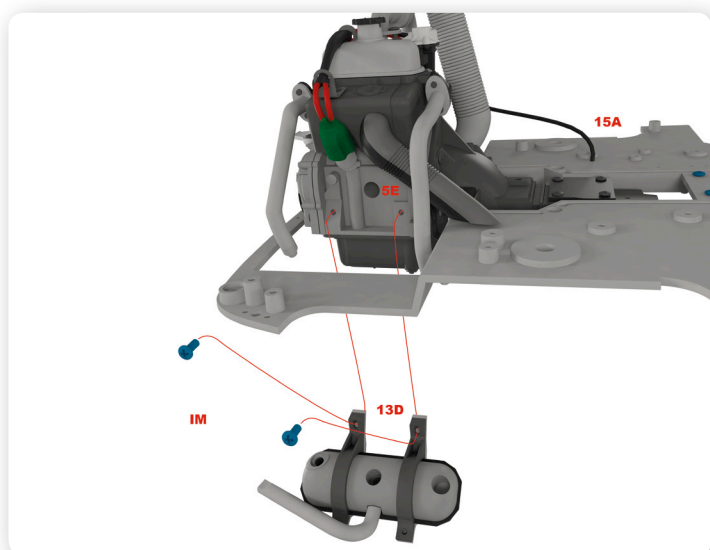

5 Fix the silencer to the side of the engine with two IM screws



Here is how your assembly should look at the end of this stage. Keep any assemblies, unused parts and spares labelled to one side for later use.

