

BUILD YOUR OWN

POLSKI FIAT

126p

Pack
4



BUILD YOUR OWN

POLSKI FIAT 126p

DEAGOSTINI
MODELSPACE™
www.model-space.com

STAGE

PAGE

| | | |
|----|----------------------|----|
| 16 | Middle floor plate | 54 |
| 17 | The front suspension | 57 |
| 18 | The steering | 60 |
| 19 | Shock absorbers | 63 |
| 20 | Wheel arches | 66 |



Editorial and design by Continuo Creative Ltd, London.
Published in the UK by De Agostini UK Ltd, Royds Withy King, 65 Carter Lane, London EC4V 5EQ.
Published in the USA by De Agostini Publishing USA, Inc., 299 Park Avenue • New York, New York 10171.
All rights reserved © 2019

Warning: Not suitable for children under the age of 14.
This product is not a toy and is not designed or intended for use in play.
Items may vary from those shown.

Stage 16: Middle floor plate

Your parts:

16A. Middle floor plate

BM. 2 x 4mm screws



16A



BM



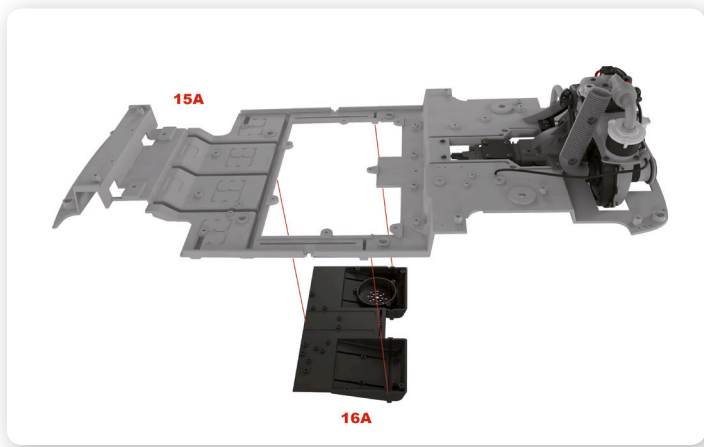

1 Take the middle floor plate (16A) and place it into the opening in the central part of the chassis, aligning the holes of both parts.

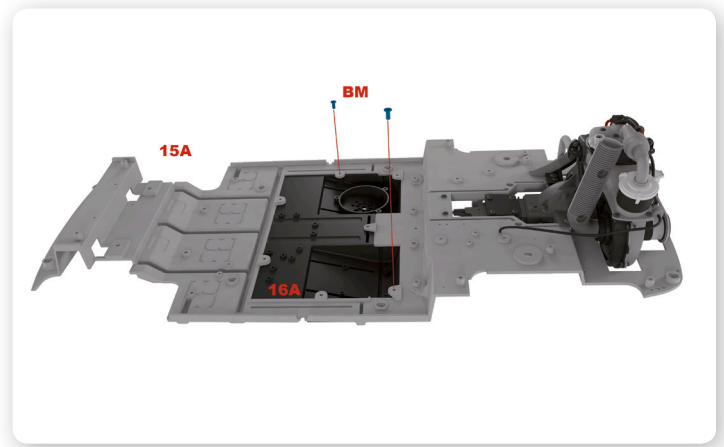

2 Tighten two BM screws into the indicated holes in the chassis to begin securing the middle floor plate.

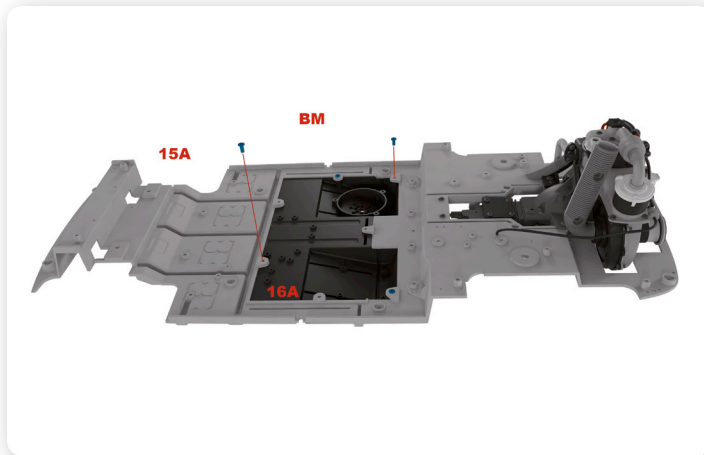

3 Tighten a further two BM screws into the chassis.

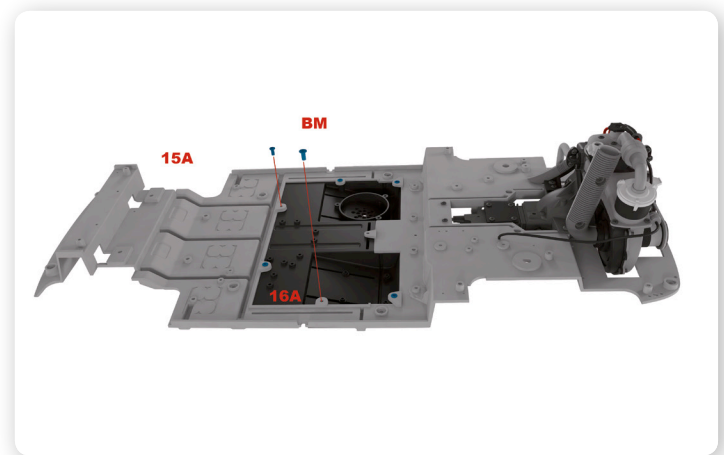

4 Tighten another two BM screws into the indicated holes in the chassis.

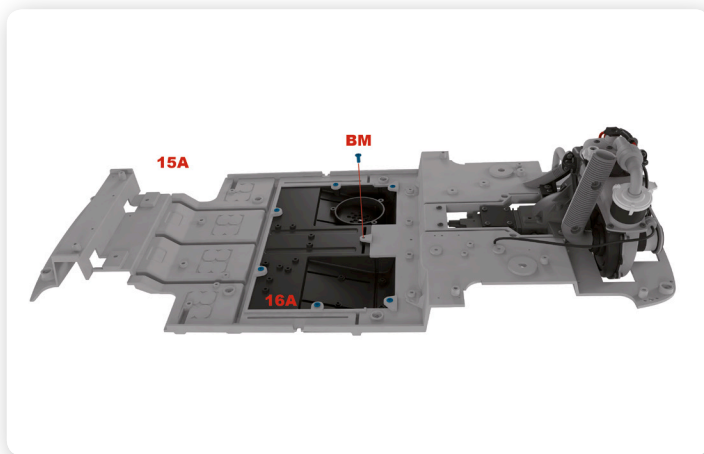

5 Secure the final BM screw into the central hole to fully fix the middle floor section into position.



Here is how your assembly should look at the end of this stage. Keep any assemblies, unused parts and spares labelled to one side for later use.

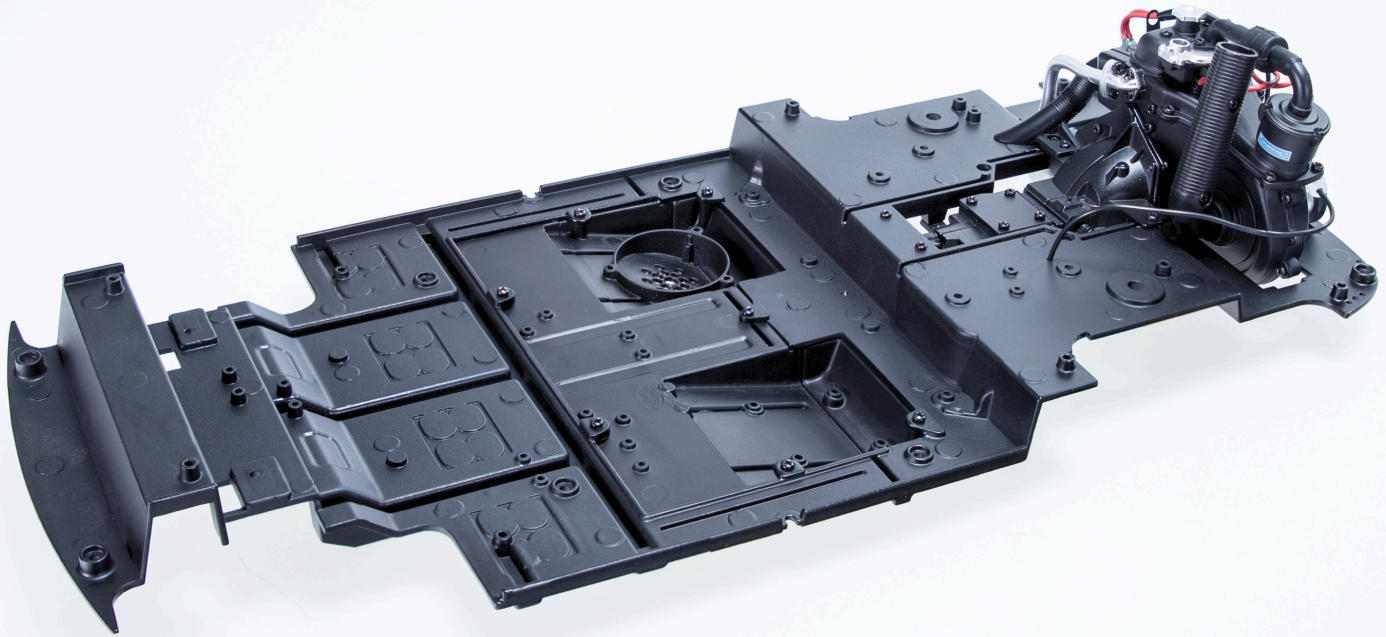

Stage 17: The front suspension

Your parts:

- 17A. Front leaf spring
- 17B. Bumpstop
- 17C. Washer
- 17D. Left spring mount
- 17E. Right spring mount
- 17F. Spring clamps
- BM. 2 x 4mm screws
- FM. 2.3 x 10mm screws
- GP. 1.5 x 7mm screws



17A



17B



17D



17F



17C



17E

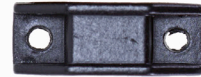

FM



BM



GP



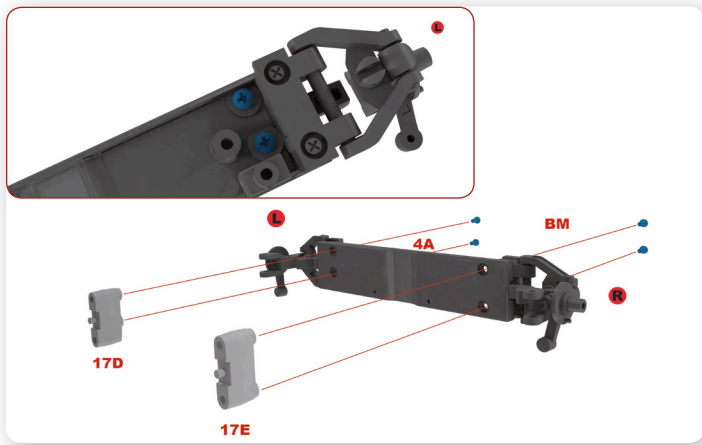

1 Retrieve the front suspension assembly from Stage 4 and secure the left and right spring mounts (17D and 17E) to the left and right of the suspension.

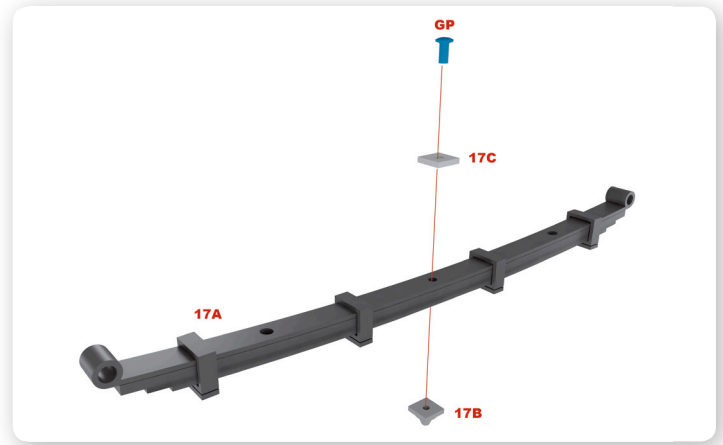

2 Take the front leaf spring (17A) and place the washer (17C) on the upper side and the bumpstop (17B) underneath. Secure the parts together with a GP screw.

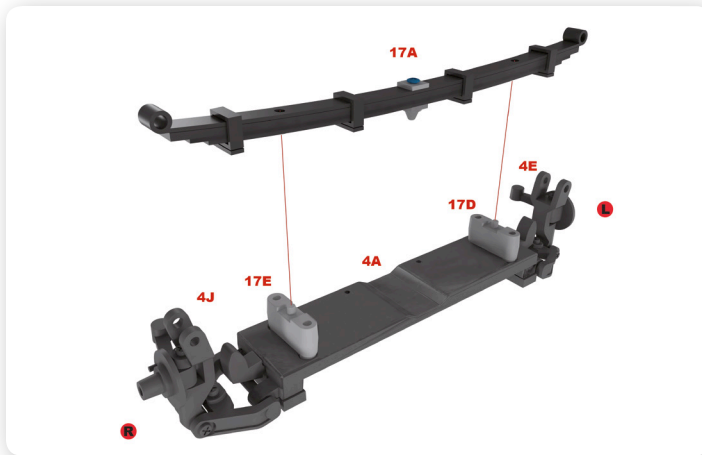

3 Place the leaf spring onto the two spring mounts, as shown.

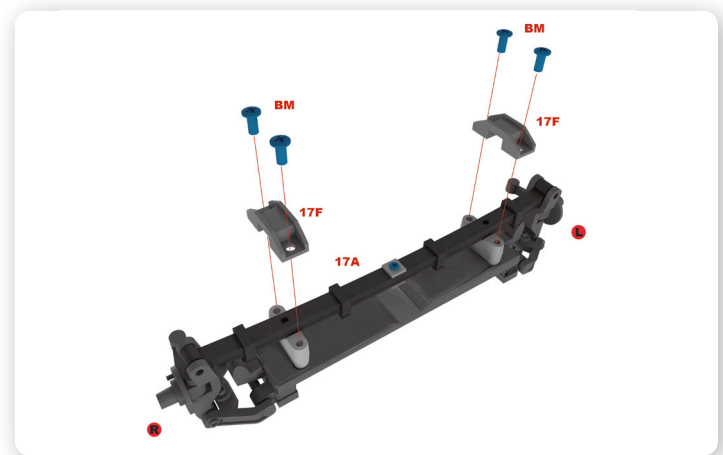

4 Fix the spring clamps over the leaf spring, to the mounts, with BM screws.

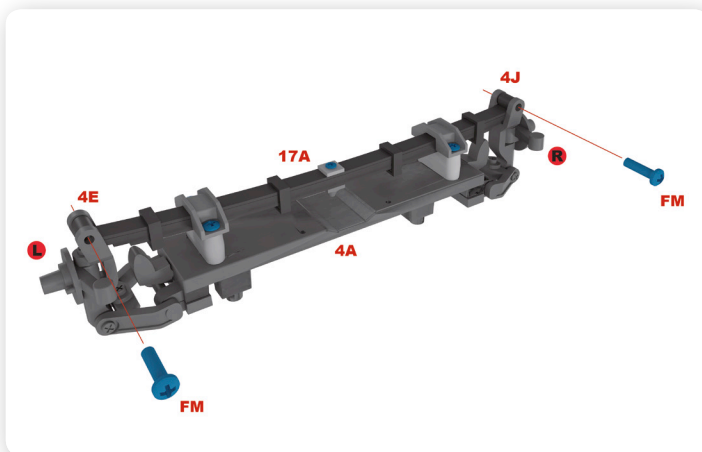

5 Align the holes at the ends of the leaf spring with the holes in the hubs. Tighten FM screws through the aligned holes.



Here is how your assembly should look at the end of this stage. Keep any assemblies, unused parts and spares labelled to one side for later use.

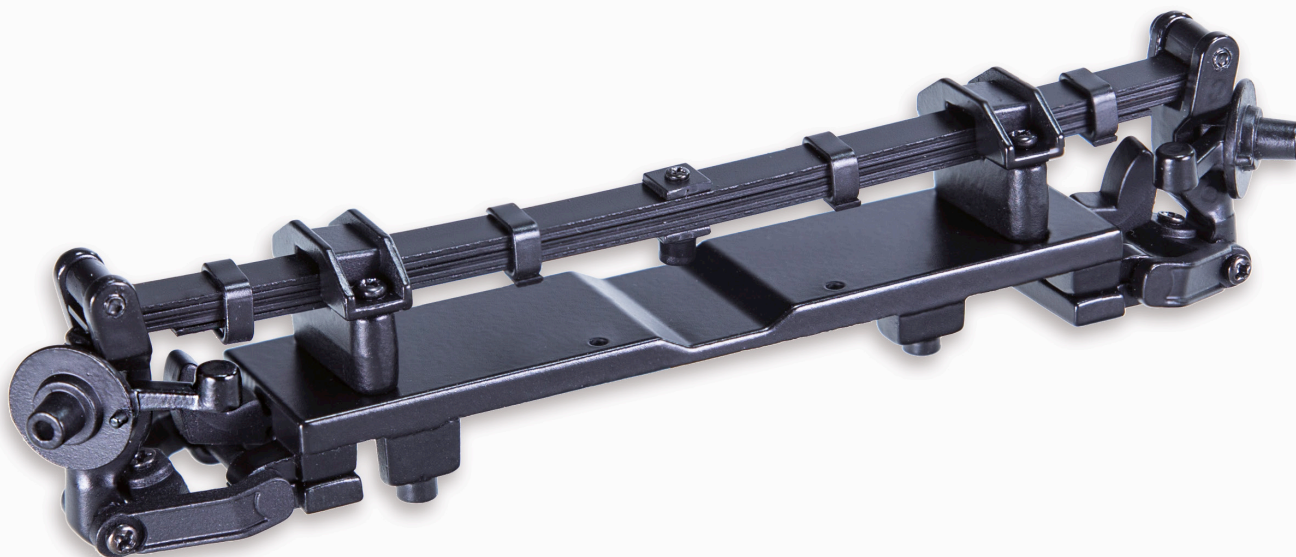

Stage 18: The steering

Your parts:

- 18A. Tie rod
- 18B. Left tie rod
- 18C. Right tie rod
- 18D. Idler arm
- 18E. Steering gear arm
- 18F. Shock absorber bodies
- DM. 2 x 3 x 5mm washer screw x 3
- GM. 1.7 x 4mm screws
- IM. 1.7 x 5mm screws
- KM. 2 x 5mm screws



18A



18E



18B



18C



18D



18F



DM



GM



IM



KM



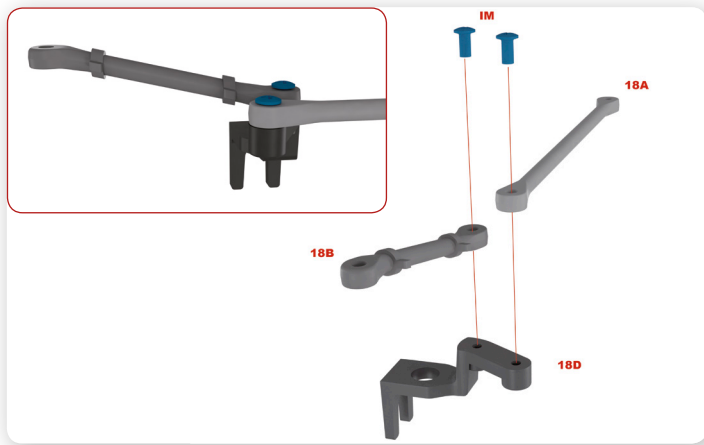

1 Connect the tie rod (18A) and the left tie rod (18B) to the idler arm (18D) with two IM screws. Make sure that the left tie rod is angled upwards.

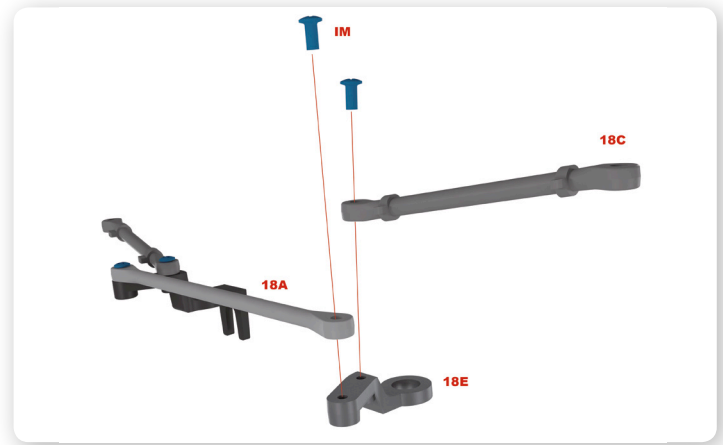

2 Connect the free end of the tie rod and the right tie rod (18C) to the steering gear arm (18E) with two IM screws, as shown.

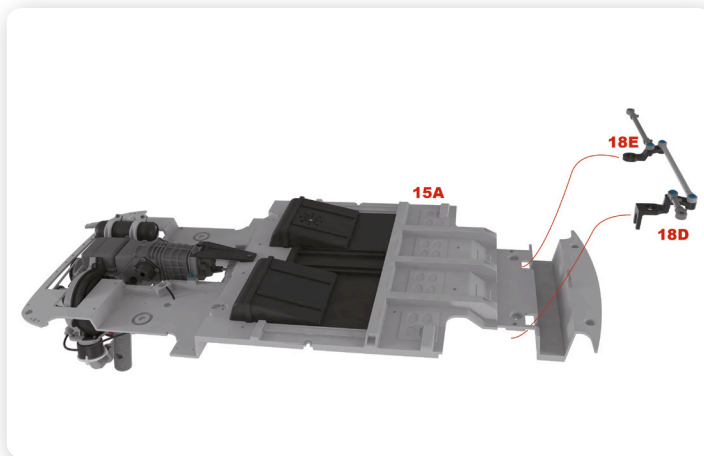

3 Insert the idler arm and the steering gear arm through the openings in the chassis, from underneath.

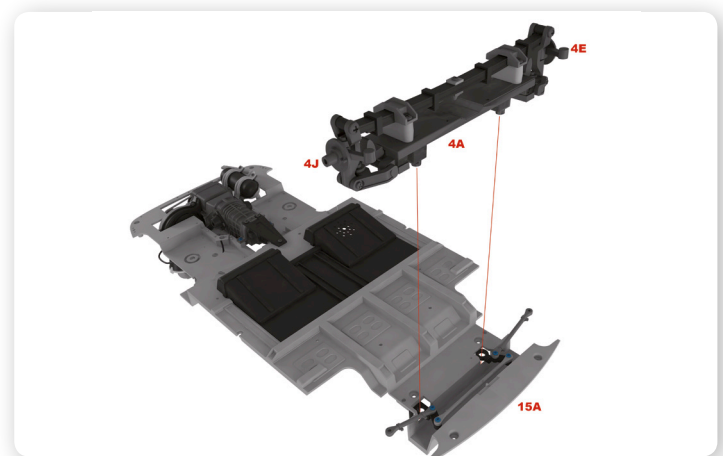

4 Take the front suspension assembly and place it onto the underside of the chassis, inserting the posts into the corresponding holes.

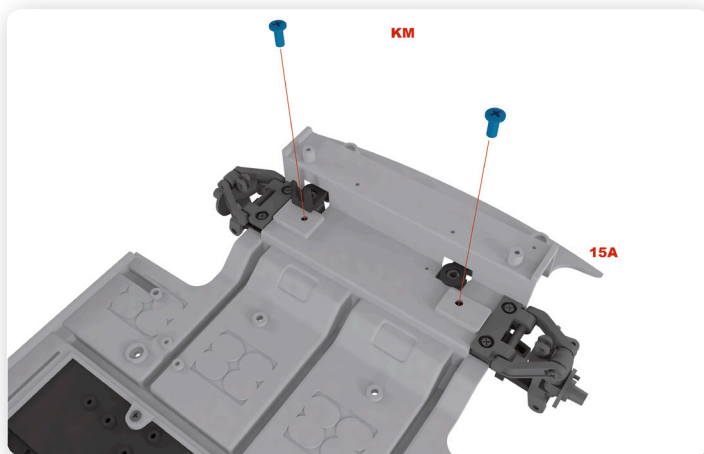

5 Turn the chassis over and secure the suspension with two KM screws.

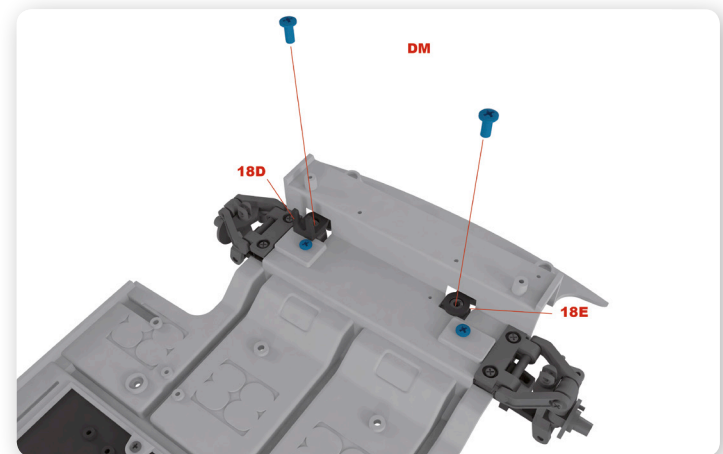

6 Secure the steering gear arm (18E) and idler arm (18D) with two DM screws.

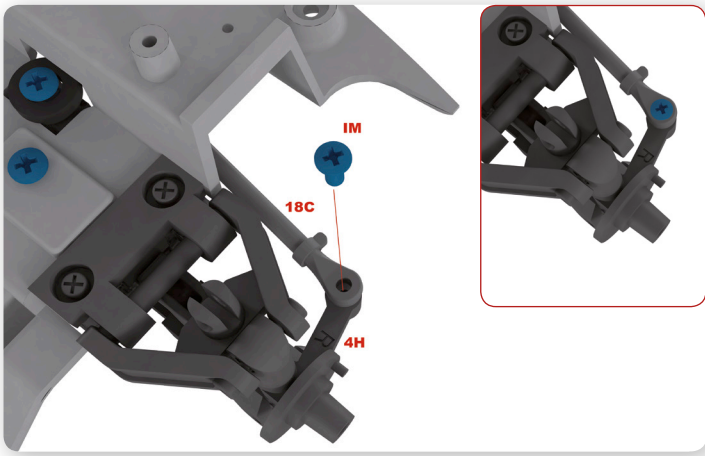

7 Fix the tie rods to the hubs with IM screws.

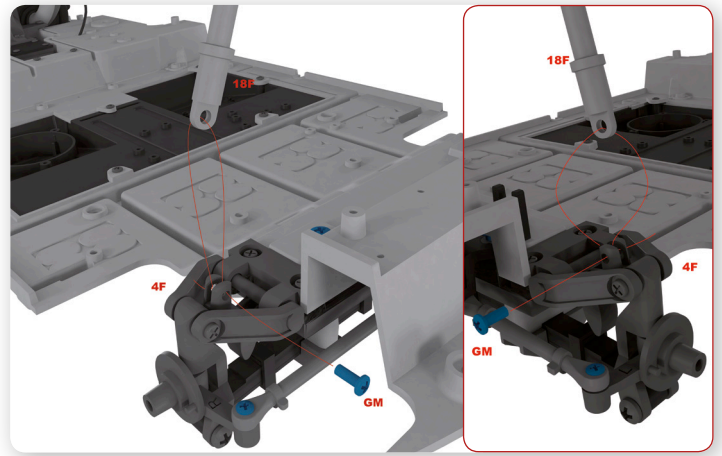

8 Fix the shock absorber bodies (18F) to the hubs with GM screws.

Here is how your assembly should look at the end of this stage. Keep any assemblies, unused parts and spares labelled to one side for later use.

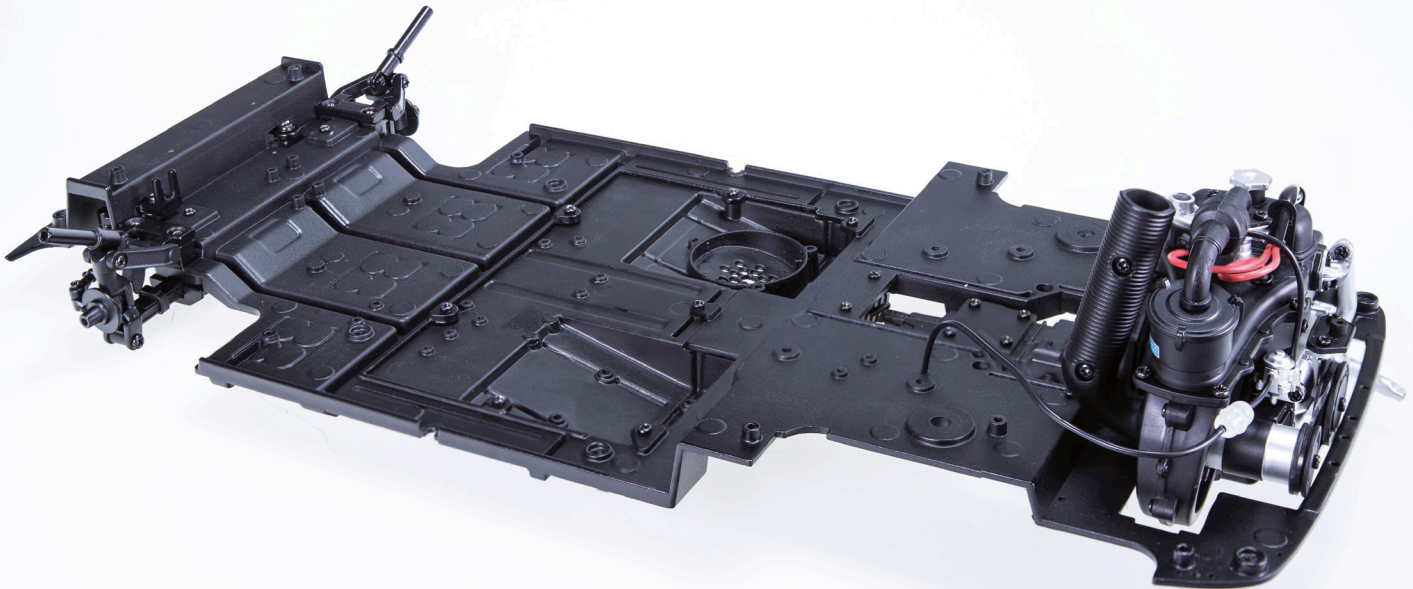

Stage 19: Shock absorbers



Your parts:

- 19A. Shock absorber covers
- 19B. Shock absorber springs
- 19C. Bracket
- BM. 2 x 4mm screws

19A



19B



19C



BM



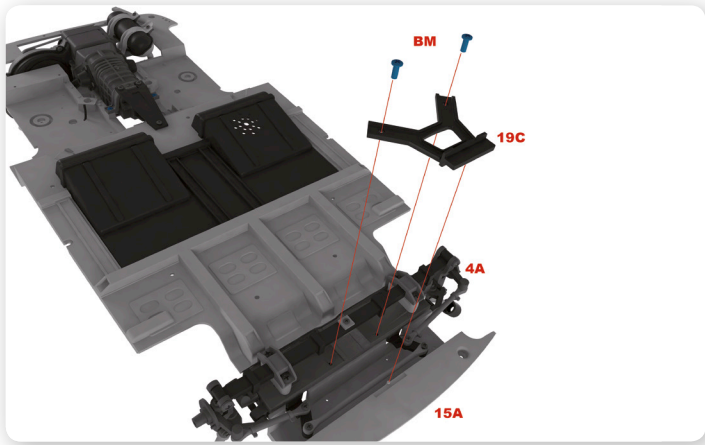

1 Fix the bracket (19C) to the suspension with two BM screws.

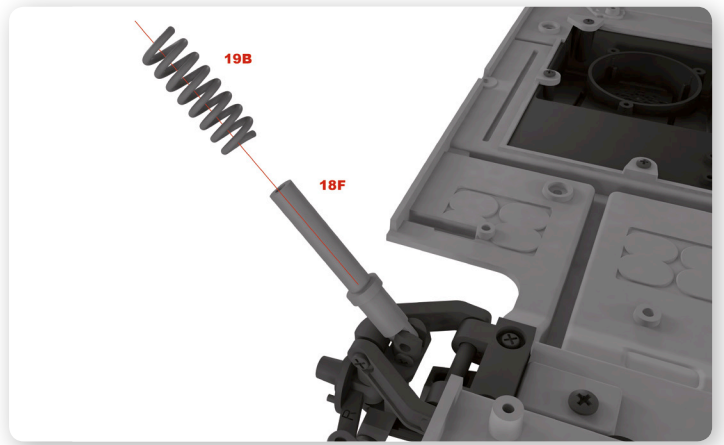

2 Slide one of the shock absorber springs (19B) onto the right shock absorber.



3 Then place a shock absorber cover (19A) over the spring.

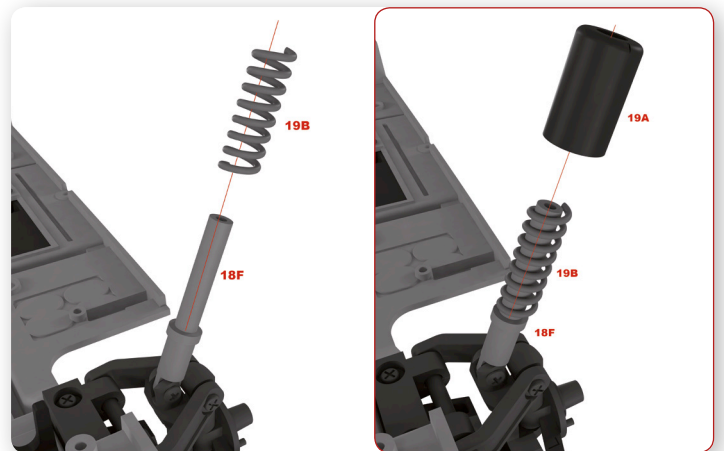

4 Repeat Steps 2 and 3 on the left shock absorber body.



Here is how your assembly should look at the end of this stage. Keep any assemblies, unused parts and spares labelled to one side for later use.

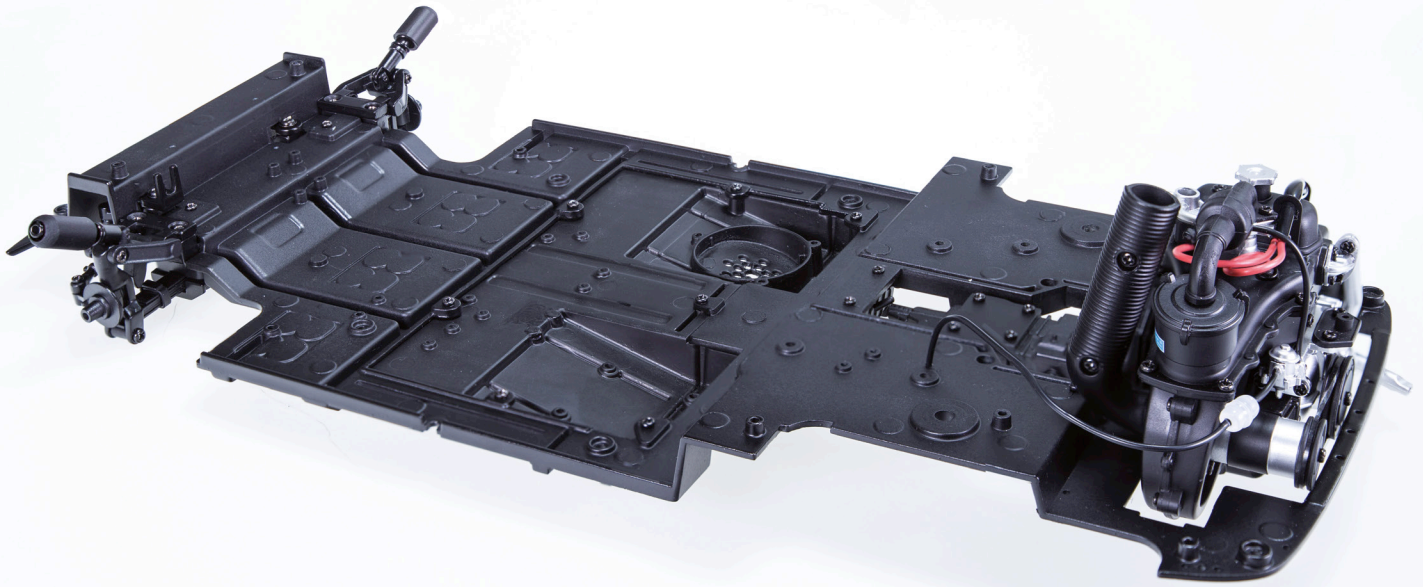

Stage 20: Wheel arches

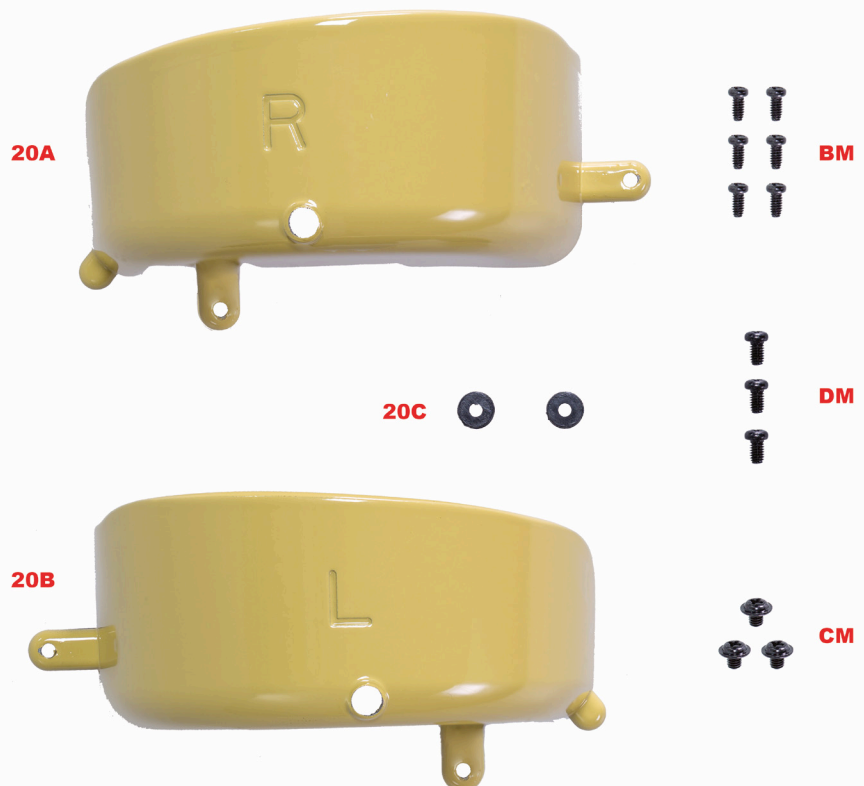

Your parts:

- 20A. Right front wheel arch
- 20B. Left front wheel arch
- 20C. Washers x 2
- BM. 2 x 4mm screws
- DM. 2.3 x 5mm screws
- CM. 2 x 4mm washer screws

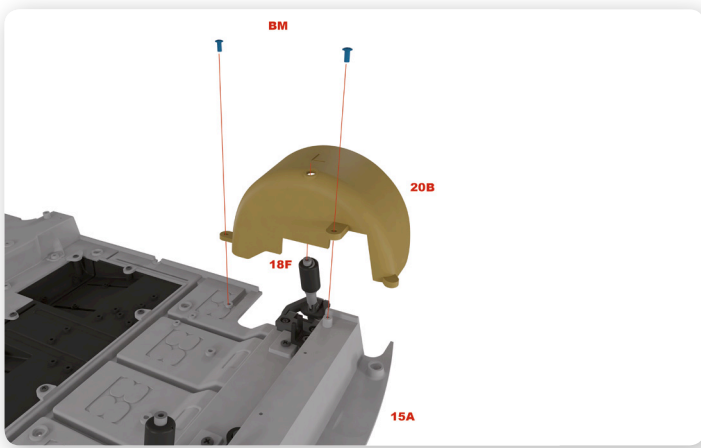

1 Place the left front wheel arch (20B) onto the chassis, aligning the end of the shock absorber with the hole in the arch. Secure the wheel arch into place with two BM screws.

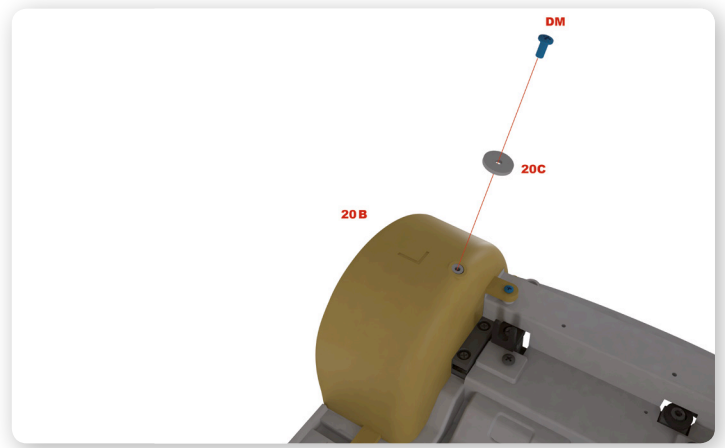

2 Place a washer (20C) over the hole in the wheel arch, and tighten a DM screw through it, into the end of the shock absorber.

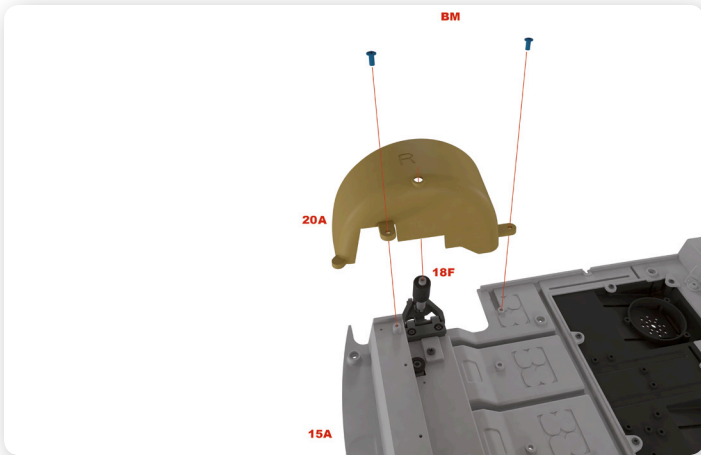

3 Fit the right front wheel arch (20A) on the right side of the chassis, aligning the shock absorber with the hole in the arch. Secure with two BM screws.

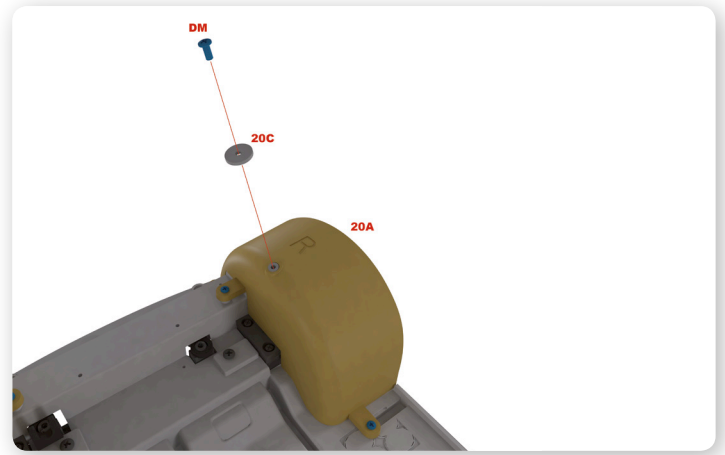

4 Place the second washer over the hole and secure with a DM screw, as in Step 2.

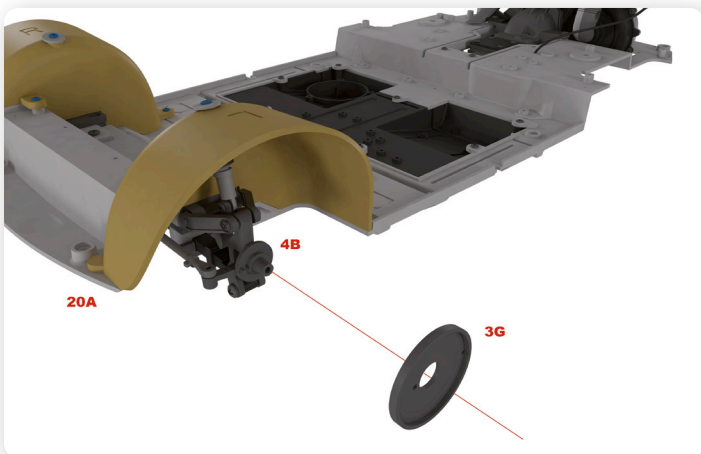

5 Attach the left front brake plate (Stage 3) onto the left front steering hub, with the raised edge facing out.

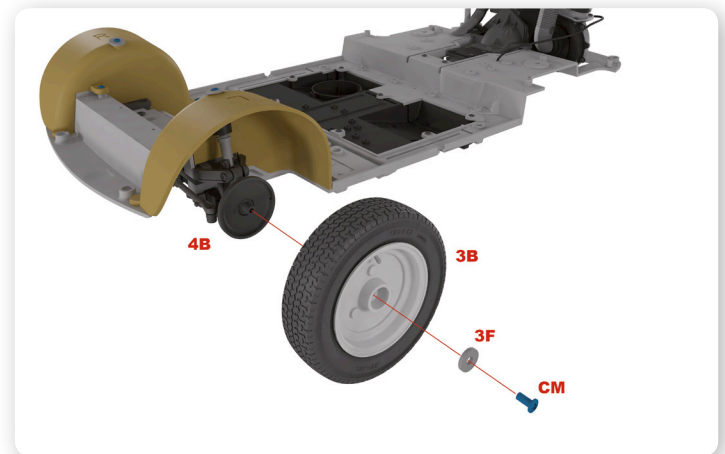

6 Mount the wheel assembled in Stage 3 onto the hub, and secure with a washer (Stage 3) and CM screw.

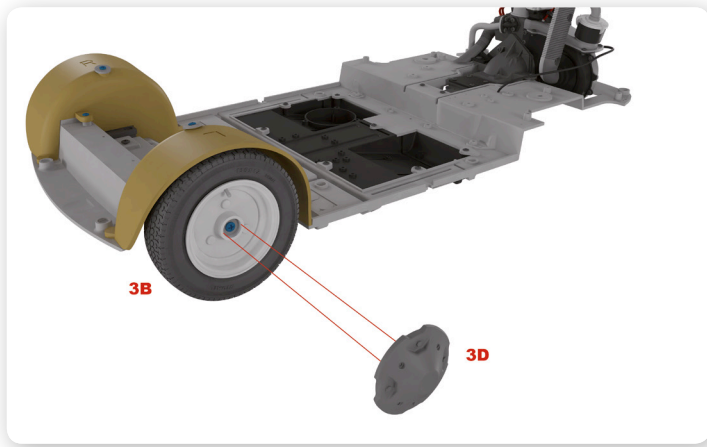

7 Mount the wheel rim (Stage 3) onto the wheel.

Here is how your assembly should look at the end of this stage. Keep any assemblies, unused parts and spares labelled to one side for later use.

