

VALENTINO ROSSI'S

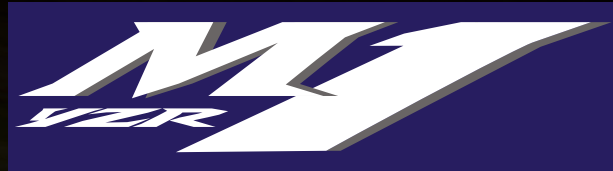

Pack 8



VALENTINO ROSSI'S



STAGE

PAGE

28	The oil sump drain and gearshift brackets	98
29	The oil sump	101
30	Engine details	104
31	The clutch case	107

Editorial and design by Continuo Creative, 39-41 North Road, London N7 9DP.
Published in the UK by De Agostini UK Ltd, Battersea Studios 2, 82 Silverthorne Road, London SW8 3HE.
Published in the USA by De Agostini Publishing USA, Inc., 121 E. Calhoun Street, Woodstock, IL 60098.
All rights reserved © 2018

Warning: Not suitable for children under the age of 14.
This product is not a toy and is not designed or intended for use in play.
Items may vary from those shown.

IN COLLABORATION with



VR46

**DEAGOSTINI
MODELSPACE™**

www.model-space.com

STAGE 28

THE OIL SUMP DRAIN AND GEARSHIFT BRACKETS

Your parts

- A. Switch plate
- B. Oil sump drain
- C. Switch
- D. Long gearshift bracket
- E. Short gearshift bracket
- F. Type R screws

A



B



C



D



E



F



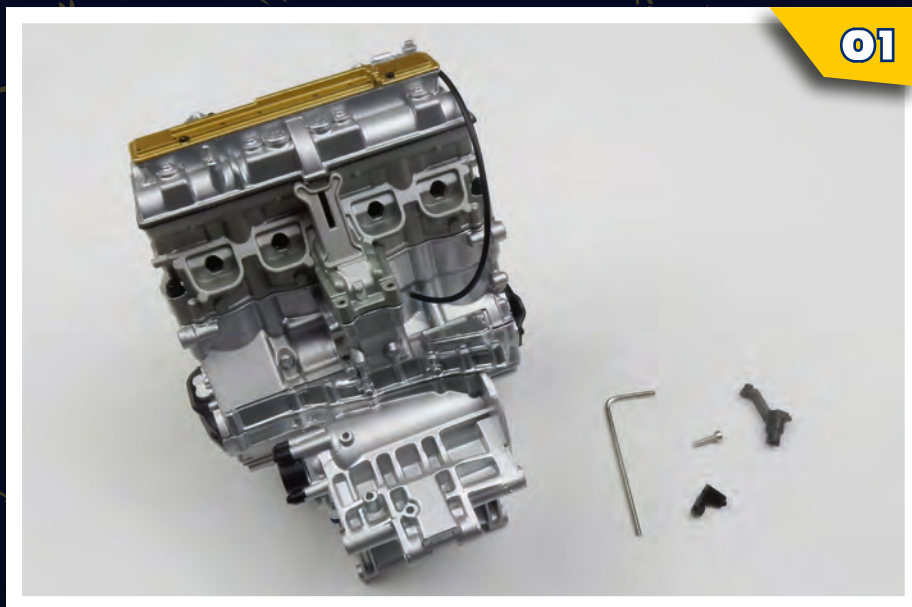

STEP 01 You will need the engine assembly (Stage 28), the two gearshift brackets, one R screw, and an Allen key.

STEP 02 This is how the gearshift brackets will be joined together by the R screw, one on each side of the engine wall.

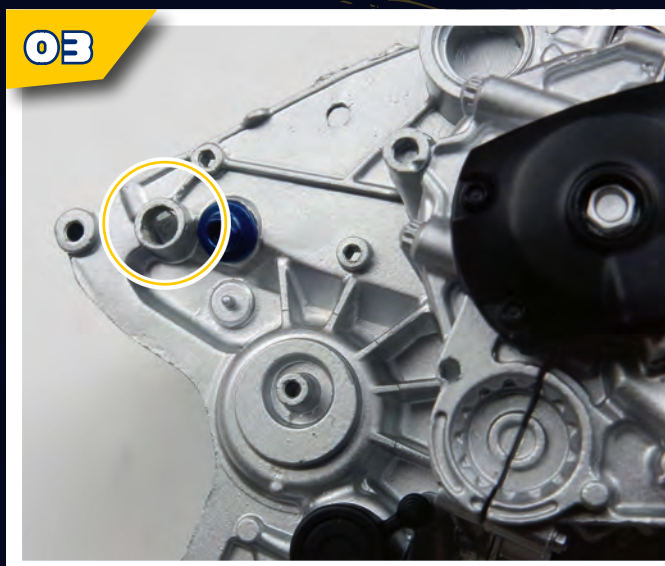
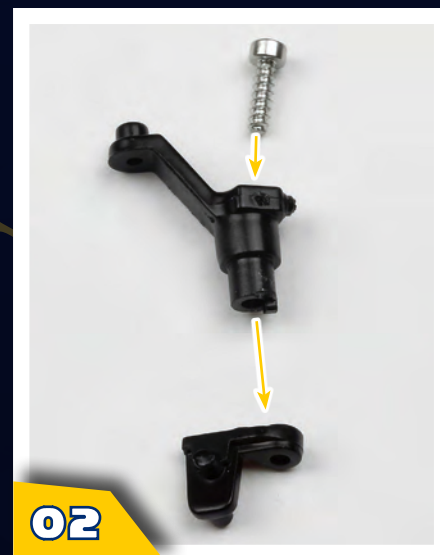

STEP 03 Locate the circled hole in the side of the engine, and insert the long gearshift bracket into it.

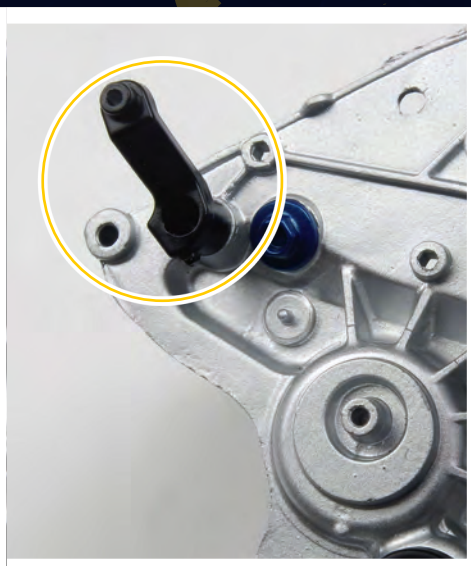

STEP 04 Place the short gearshift bracket onto the end of the long bracket, on the inside of the engine wall. The other end of the short bracket should rest on the switch, as indicated.

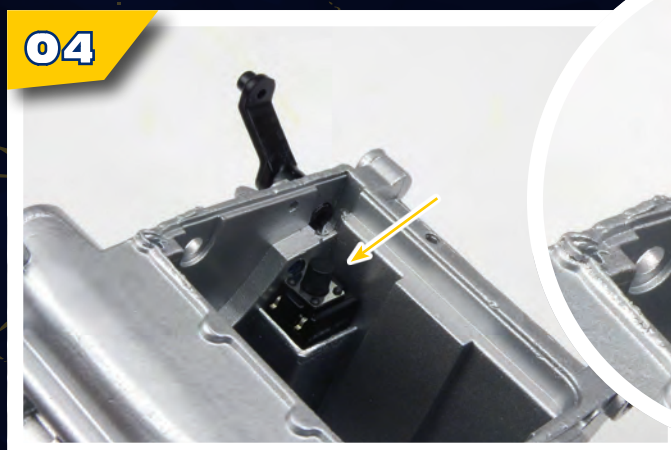



STEP 05 Once the two brackets are in position, insert screw R into the indicated hole in the long bracket.



STEP 06 Gently tighten the screw into place, ensuring that the parts stay in position. The inset shows how the assembly should look.

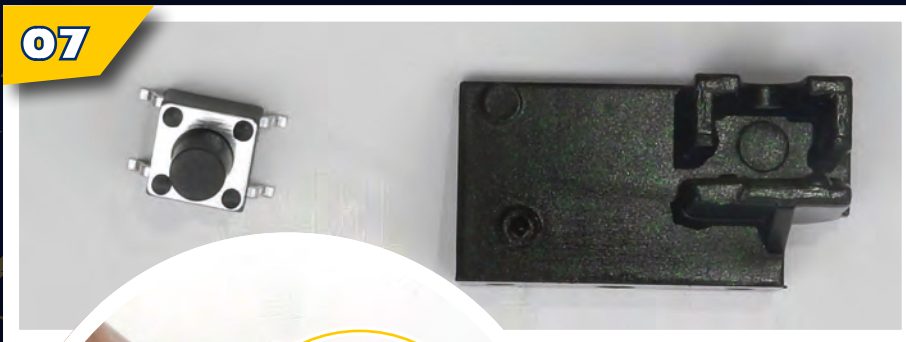

STEP 07 Insert the switch into the switch plate, as shown.

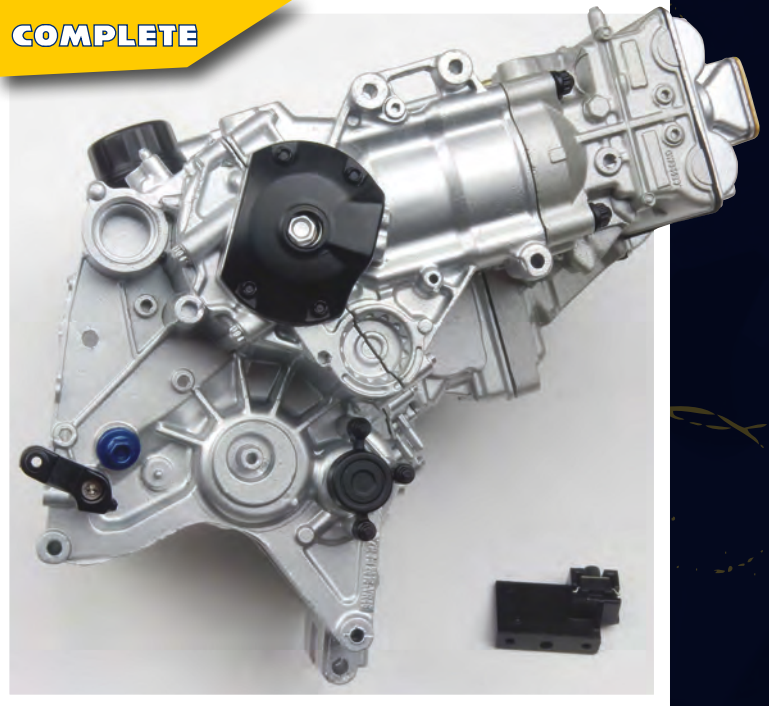

STAGE COMPLETE
Here is how the assembly should look at the end of this stage.

STAGE 29

*THE OIL SUMP***Your parts**

- A. Oil sump
- B. Lenses x 2
- C. Pinion
- D. Type J screws
- E. Type F screws
- F. Washers x 2

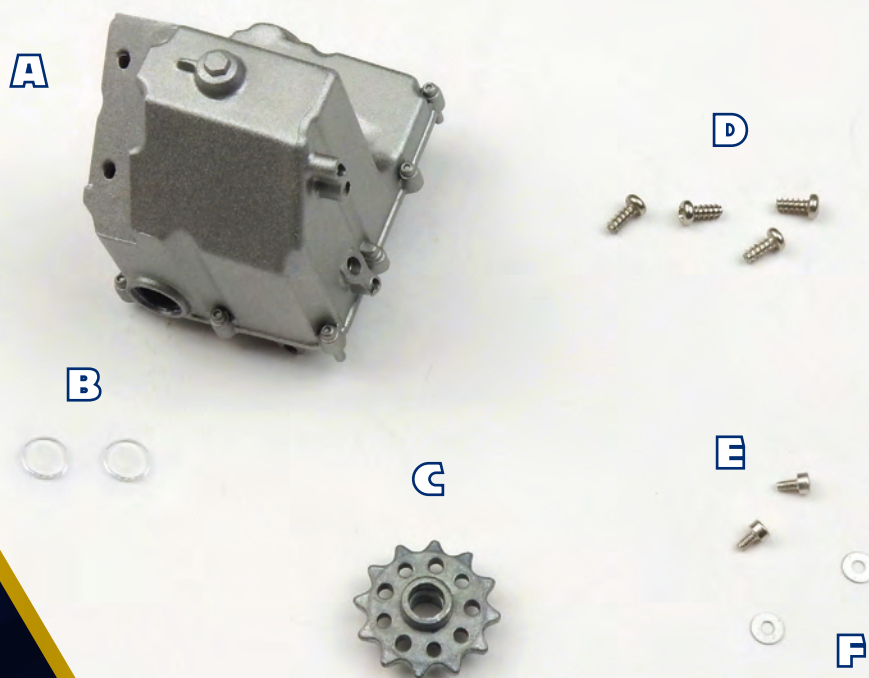

01

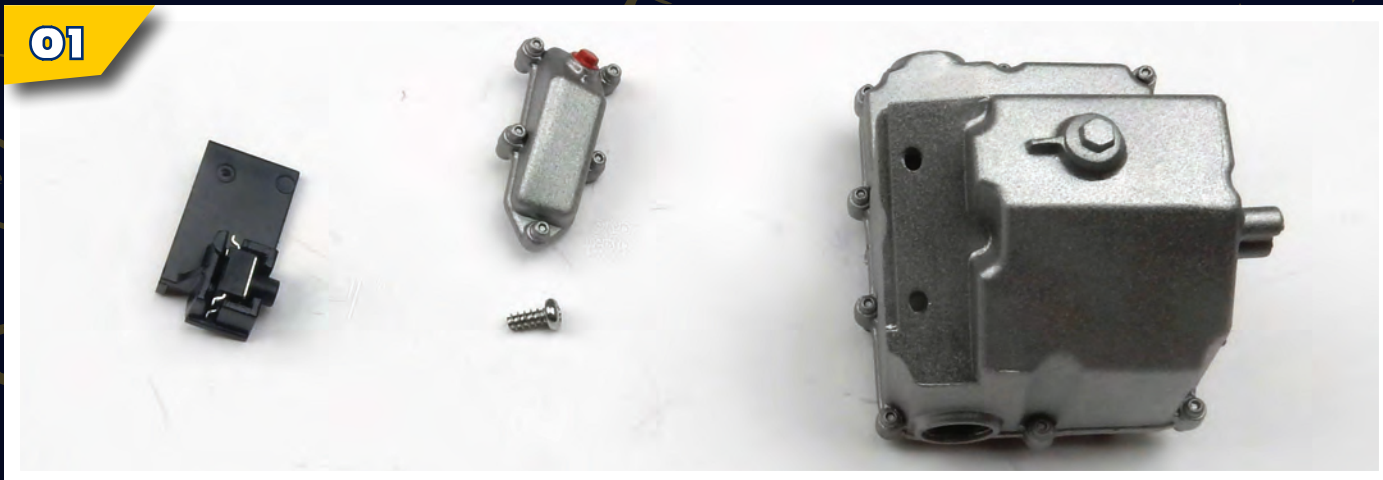

STEP 01 You will need the oil sump drain and switch plate from Stage 28, and the oil sump and type J screw from this stage.

02



STEP 02 Place the oil sump drain onto the oil sump, as shown.

03

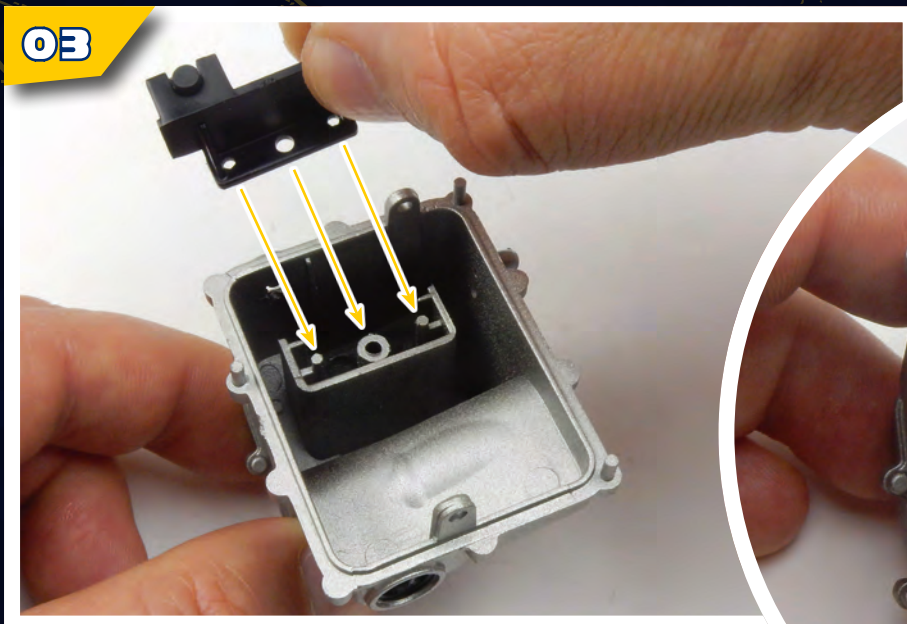

STEP 03 Turn the oil sump over, holding the drain in position, and place the switch plate onto the posts as indicated. Secure it there with a type J screw.

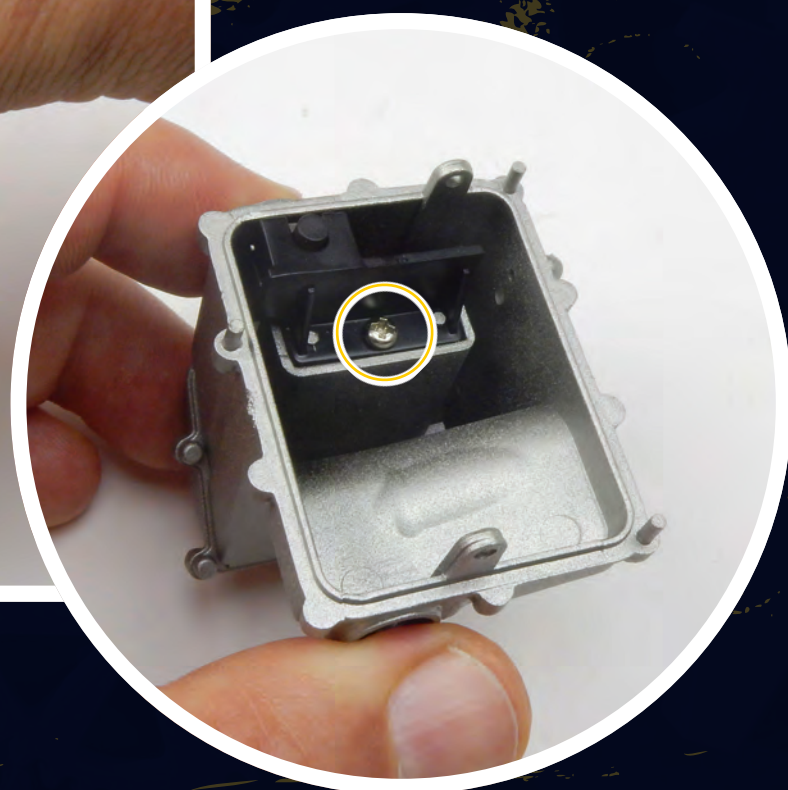

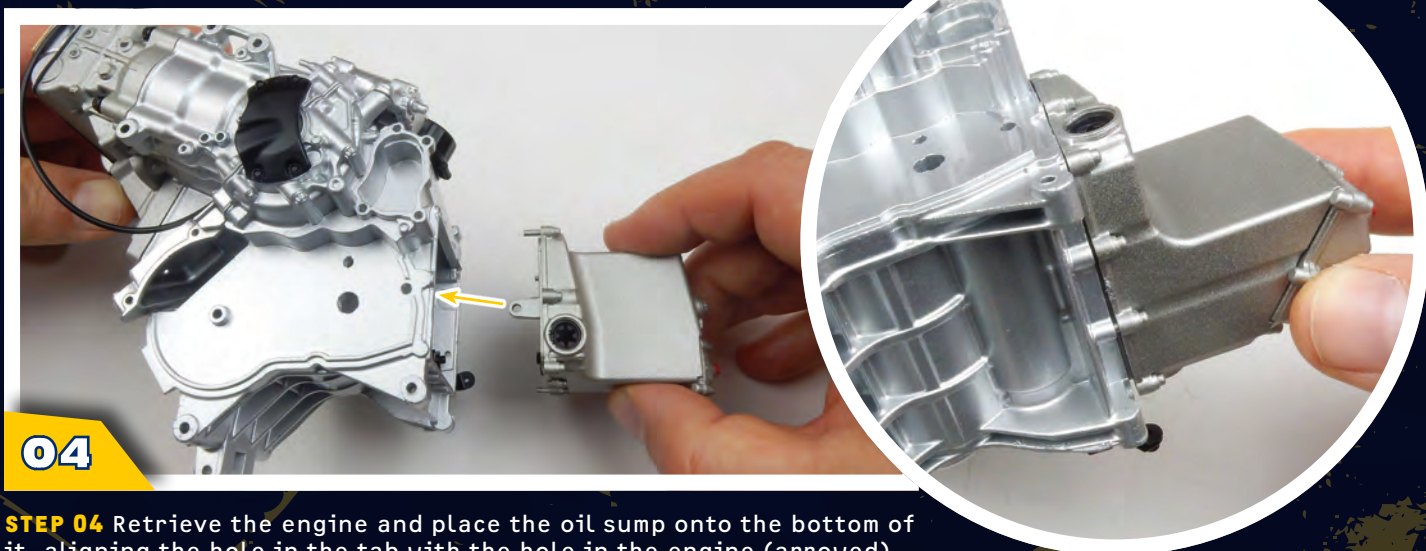

04

STEP 04 Retrieve the engine and place the oil sump onto the bottom of it, aligning the hole in the tab with the hole in the engine (arrowed).

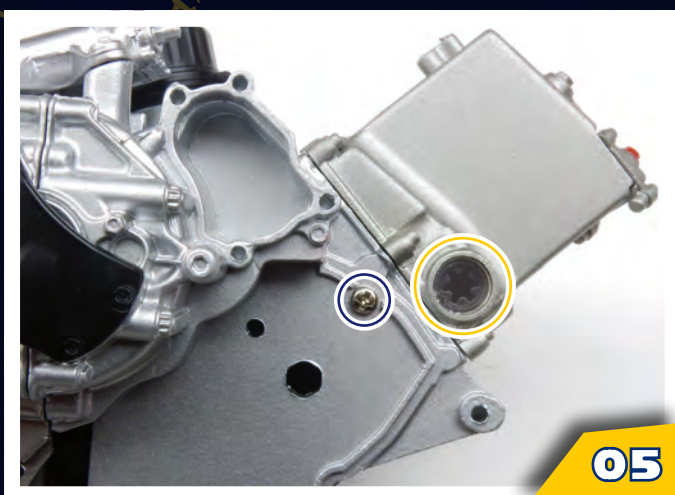

05

STEP 05 Secure the sump with a type J screw (blue circle), then place one of the lenses into the hole in the side of the sump (yellow circle). Use a clear-drying glue to secure the lens if necessary.

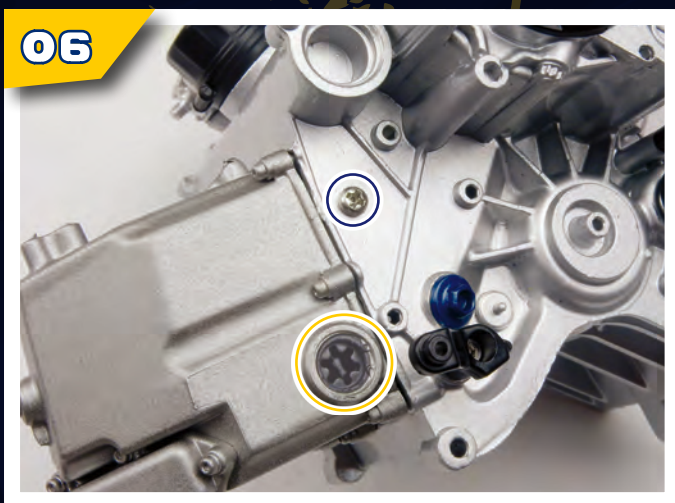

06

STEP 06 Secure the sump on the other side of the engine with another type J screw (blue circle), and fit the second lens (yellow circle). Fix with glue if necessary.



COMPLETE

STAGE COMPLETE

Here is how the assembly should look at the end of this stage.

STAGE 30

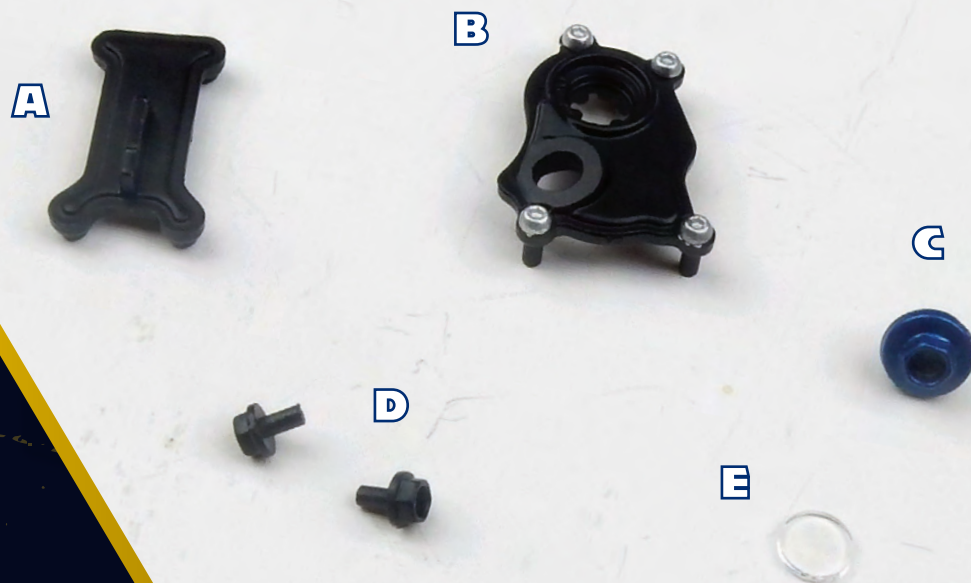
ENGINE DETAILS**Your parts**

- A. Cover
- B. Oil window
- C. Bolt head
- D. Plastic bolts x 2
- E. Transparent lens



STEP 01 Place the lens and the bolt head into the indicated holes in the oil window.

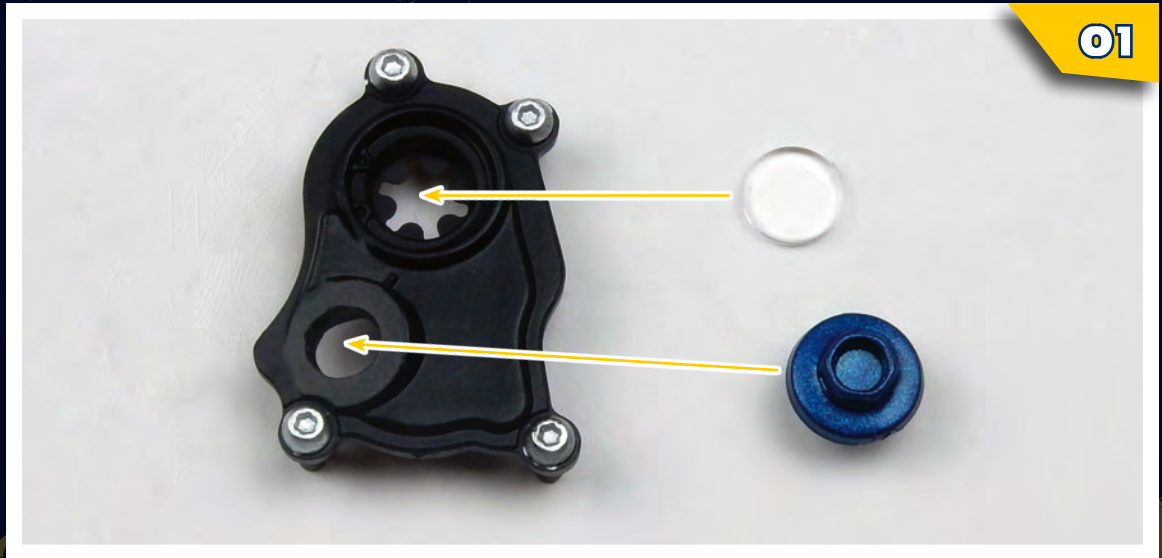

STEP 02 Use clear-drying glue to secure the parts if necessary.

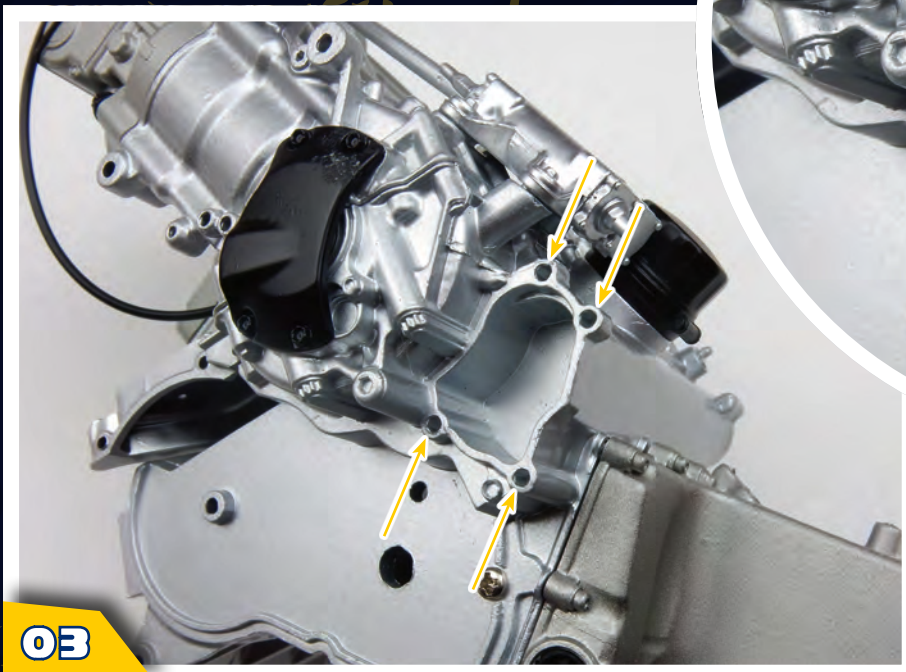

STEP 03 Insert the pins on the reverse of the oil window into the indicated holes in the side of the engine (arrowed). Press the window into place (inset).

STEP 04 Locate the circled area on the rear of the cylinder block.

STEP 05 Press the cover into place, as shown – it will only fit in one way round. Secure with glue if necessary.

04

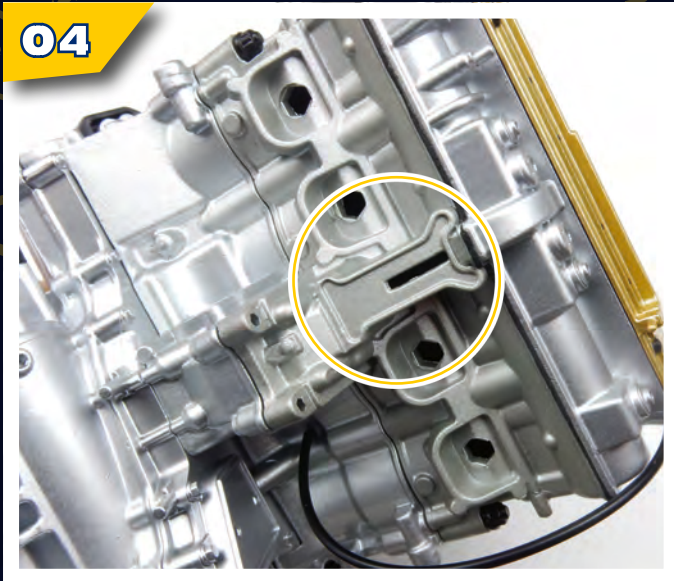

05

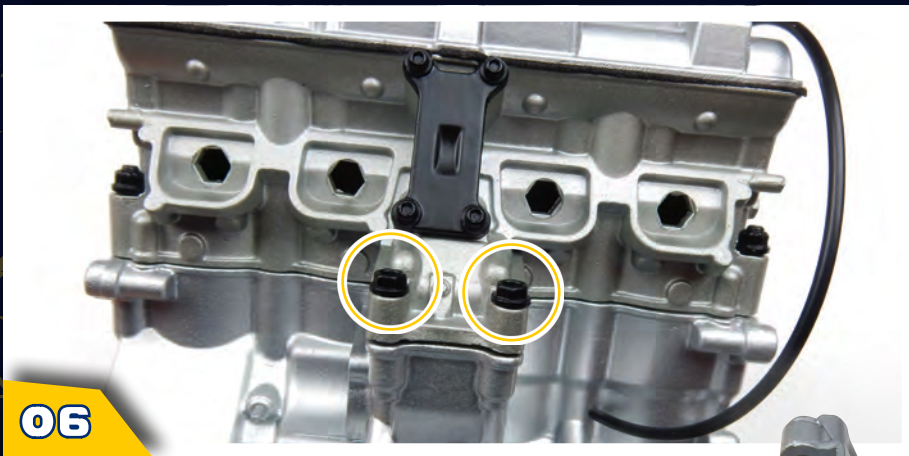
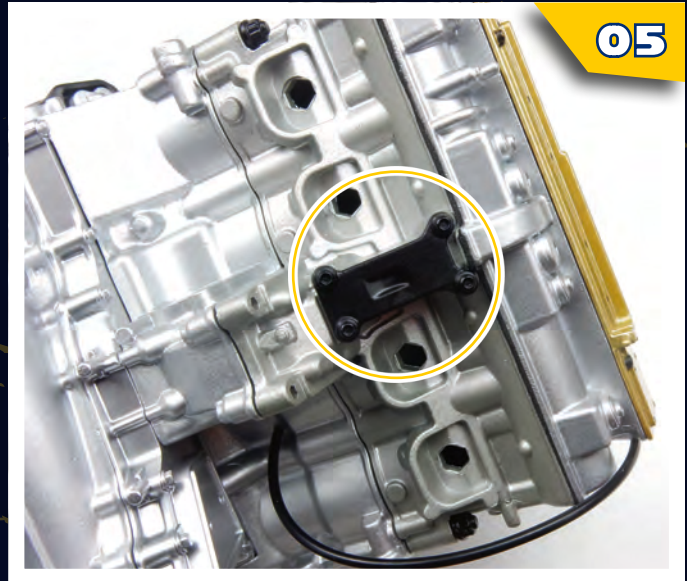

06

STEP 06 Insert the two plastic bolts into the circled holes.

COMPLETE



STAGE COMPLETE
Here is how the assembly should look at the end of this stage.

STAGE 31

*THE CLUTCH CASE***Your parts**

- A. Clutch case
- B. Bolt head
- C. Coupling plate
- D. Tube
- E. Type B screws

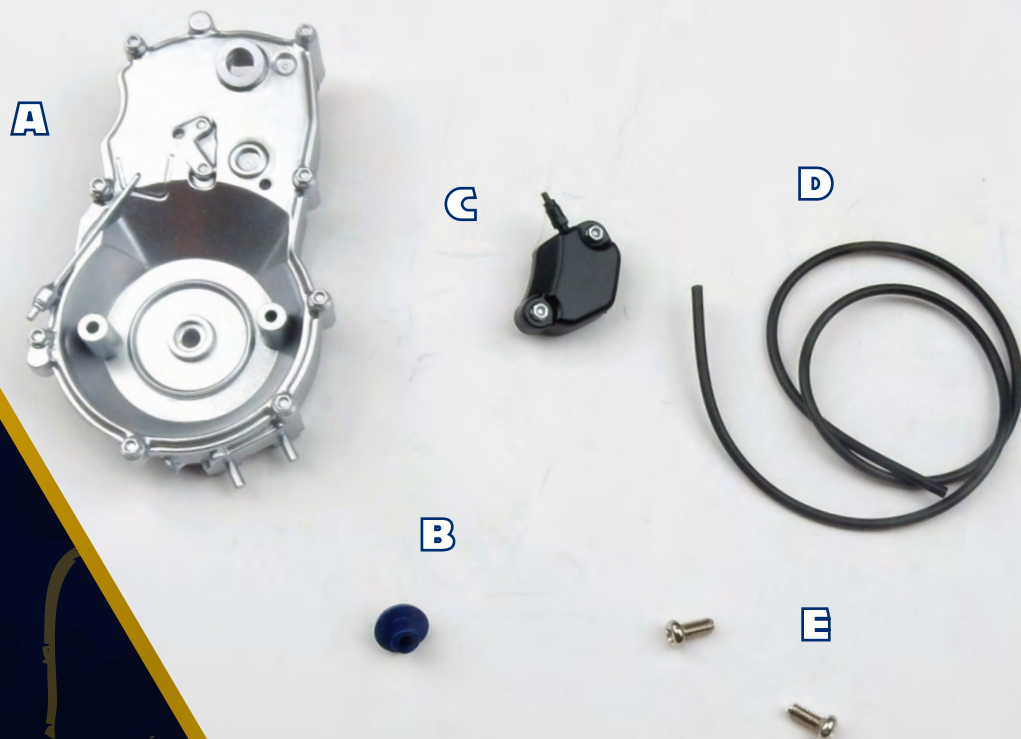

STEP 01
Prepare the rubber tube and the coupling plate.



STEP 02
Push one end of the tube onto the valve projecting from the plate. If necessary, secure the end of the tube with a drop of glue.

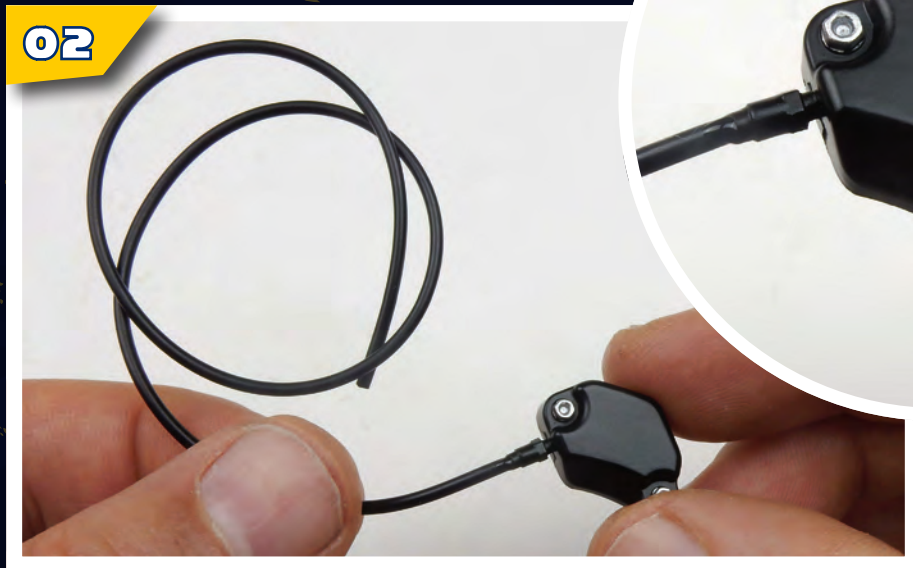

STEP 03 Now prepare the clutch case, the bolt head and the coupling plate. The bolt head fits into the larger hole (yellow circle), and the two smaller holes circled blue will take the coupling plate pins.



04

STEP 04 Insert the bolt head into the hole. Secure it with glue if necessary.



05

STEP 05 Press the coupling plate into place on the clutch case. If the fit is loose, secure it with glue.



06

STEP 06 Place the clutch case onto the side of the engine, aligning the corresponding holes.

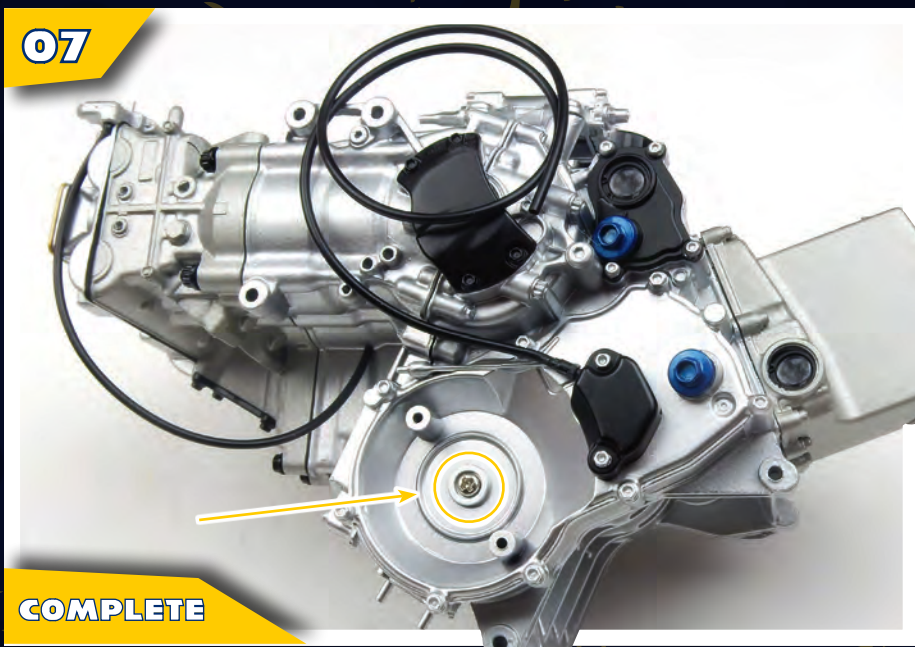

07

STEP 07 Use a type B screw to secure the clutch case to the engine.

COMPLETE

STAGE COMPLETE
Here is how the assembly should look at the end of this stage.